

STANLEY

TOOLS

**Repair Parts
Catalog**

No. 35P

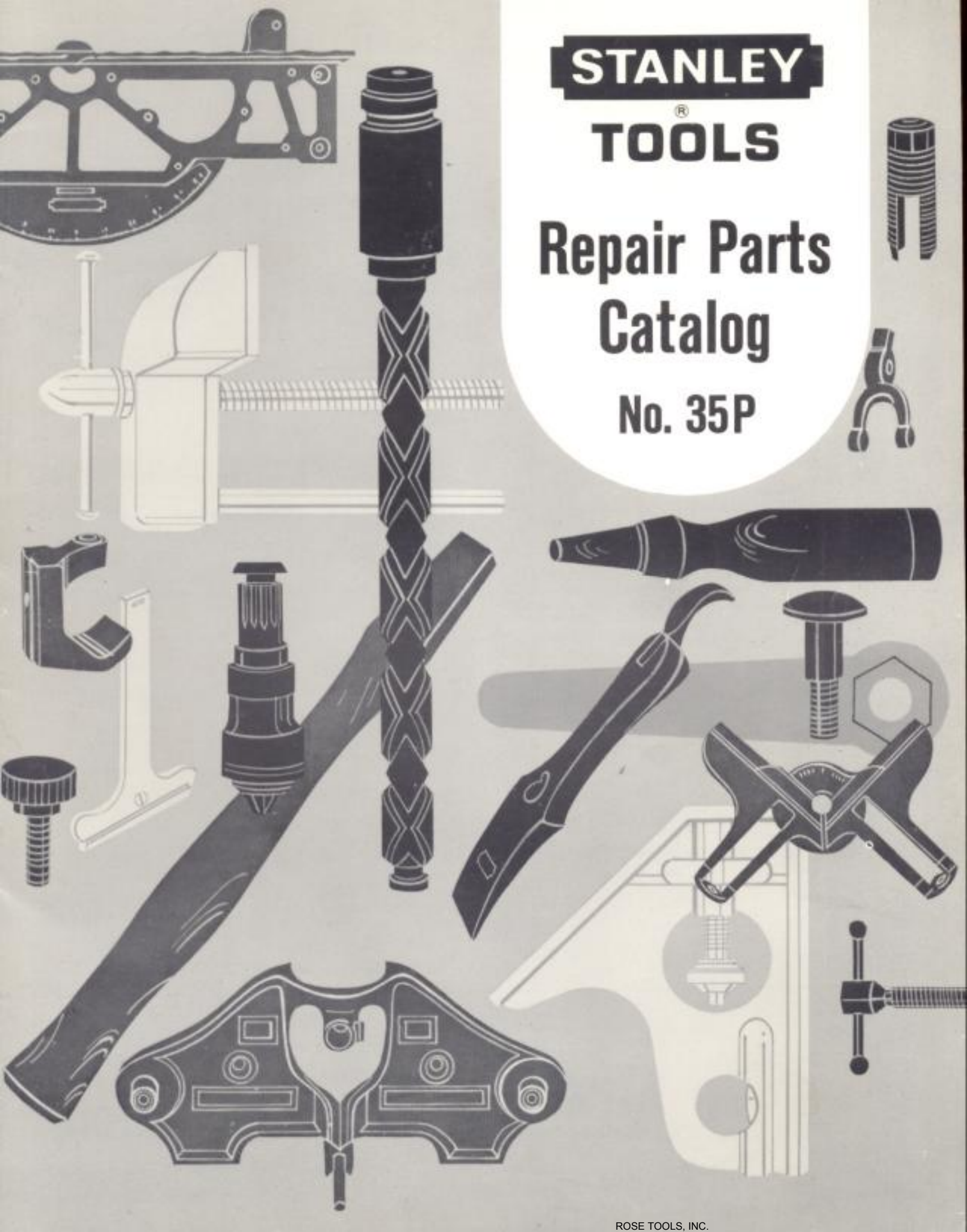

This catalog is designed to help owners of Stanley Tools identify and order interchangeable repair parts that can be easily replaced without the aid of special tools or equipment. We recommend that the owner make his own repairs whenever it is possible and thereby save the expense of round trip transportation of tools in addition to the repair cost. When ordering, be sure to specify the part number and name, as well as the model number of the tool to be repaired.

Non-interchangeable parts, though shown, are not identified for ordering since these parts must be fitted at the factory. Prices of these non-interchangeable parts, and estimates on repairs will be furnished on request. When requesting estimates, please state clearly just what new parts are wanted, giving the model number of the tool and any other information that will help avoid error in filling the order.

Minimum charge is 25 cents net, which includes postage.

Our general catalog #34 illustrates and describes our complete line of Stanley Tools for artisans, craftsmen, homeowners and hobbyists, copies are available on request.

Parts for Stanley Bit Braces



All parts listed can be readily put into the Brace by the user. Other parts can be supplied if required, but should any piece be wanted that is not shown, it is better that the Brace be returned to the factory for repairs. Some parts having the same name differ in design in the different Braces. We show different cuts bearing the same number to illustrate the different designs. Heads and quills are shown in section to make difference of construction clear. In ordering, be sure to specify number and name of part and number of Brace. It will also help if you will include with your order a sketch or tracing of the part desired.

JAWS: Type G — Used on Nos. 811, 813, 921, 923, 923A, 984 and 993;

Type I — Used on Nos. 915, 916, 917, 925, 945, 1237 and 1250;

Type J (Rolled Finish) — Used on Nos. 1253, 1262, 965 and 965N.

Type G Special — Used on No. 1246.

INDEX

	Page
Bevels	16
Bits, Expansive	3
Bit Braces	2
Bit Brace Jaws	2
Chisel Handles	7
Doweling Jig	5
Drills, Breast	3
Drills, Hand	3-4
Drills, Push	4
Garden Tools	5
Gauges, Butt	6
Gauges, Marking	6
Grass Cutters	5
Grass Shears	5
Hammer Handles	6
Hatchet Handles	6
Level Glasses	7
Level Tubes	7
Mitre Boxes	8-12
Mitre Machine	12
Mitre Vise	16
Planes	12-14
Plane Irons	12
Plumb Tubes	7
Pruners	5
Push Drills	4
Replacement Handles	6-7
Saw Sets	19
Screw Drivers, Spiral Ratchet	15
Squares, Combination	16
Surform Drum Adapter	19
Tap Wrench	19
Vises, Machinists	17
Vises, Woodworkers	17-18

No.	Name of Part	List Each for No.	
		923	
400	Chuck Complete		\$7.20
401	Screw End		2.40
402	Plug Screw		—
402½	Nut and Pin10
404	Shell		1.20
410	Pawls (Pair)50
410½	Pawl Pin10
412	Pawl Spring10
416	Jaws		1.20
430	Head		1.20
432	Quill		1.00

No.	Name of Part	List Each for Nos.		
		945	965	965N
400	Chuck Complete	\$3.00	\$2.40	\$2.40
401	Screw End85	.70	.70
404	Shell	1.20	.85	.85
410	Pawls (Pair)50	.40	.40
410½	Pawl Pin10	.10	.10
412	Pawl Spring10	.10	.10
416	Jaws	1.10	.70	.70
430	Head60	.60	.60
432	Quill60	.50	.50

Parts for "YANKEE" Ratchet Braces

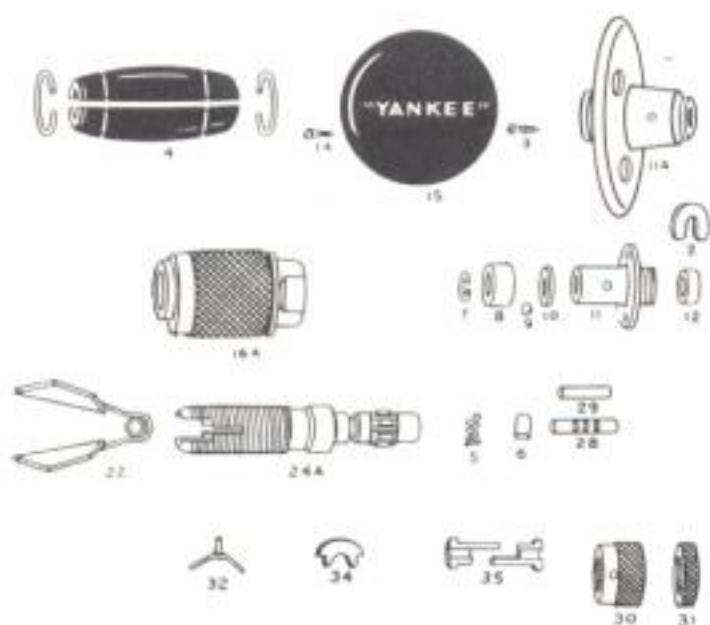

No.	Name of Part	List Each for Nos. 2100A-2101A
2	Quill Washer	each \$0.10
3	Head Screws	set (3) .10
4	Handle (split)	each 1.80
5	Shifter Lock Spring	each .10
6	Shifter Lock Pin	each .10
8	Quill Ball Cover	each .30
9	Steel Balls	set (16) .10
10	Quill Ball Washer	each .10
11A	Quill	each 1.10
15	Head	each 1.60
16A	Chuck, Shell complete	each 3.50
22	Jaws, complete	each 1.30
23	Jaw Spring	each .10
24A	Screw End	each 3.00
25	Chuck, complete includes chuck shell complete 16A — Screw End, 24A — Jaws 22	each 7.20
28	Shifter	each .35
29	Socket Pin	each .10
30	Adjusting Screw Sleeve	each .70
31	Socket Cap	each .50
32	Pawl Spring and Pin, complete	each .10
34	Ratchet Stop	each .10
35	Pawls	set (2) .30

Parts for "YANKEE" Hand Drill No. 1530A NOT ILLUSTRATED

No.	Name of Part	List Each
1	Frame	each \$0.85
3	Handle for end of frame connection	each 1.10
6	Spindle (no attached parts)	each .55
7	Chuck — Complete	each 3.00
8	Chuck Shell	each .80
9	Chuck Jaws	set 1.00
10	Chuck Jaw Springs	set .10
12	Crank Handle	each .70
13	Crank Screw	each .10
14	Driving Gear (Large)	each 2.40
15	Driven Gear (Small)	each 1.00
19	Shifter and Ratchet Mechanism	each 2.80
20	Washer for Crank	each .25

Parts for Hand Drills

in design for the different Drills. These you will find listed by the same number in the price list below. In ordering, be sure to specify number and name of part and number of Drill.



No.	Name of Part	List Each For Nos. 610 611 624	1610 1611	624
460	Chuck Assembly Complete	\$3.00	\$3.00	\$3.60
461A	Jaws, Spring and Disc	1.00	1.00	1.00
461½A	Springs and Disc only	.25	.25	.25
462	Large Gear	1.20	1.20	1.80
463	Pinion Gear — Rear	.40	.40	.40
464	Crank and Crank Handle	.60	.60	.60
465	Crank Screw	.15	.15	.15
466	Side Knob	—	—	.40
467	Handle	.60	1.20	1.00
468	Handle Cap	—	.40	.40
469	Set of Drill Points	1.50	1.50	1.50
470	Speed Gear Screw	.25	.25	.25

Parts for Expansive Bits Nos. 71, 71A, 71AB, 71B



No.	Name of Part	For Bit No.	List Price
72	Cutter 1½x2½	All Bits	1.50
73	Cutter ¾x1½	All Bits	1.50
75	Clamping Screw	71A, 71AB	.60
77	Cutter 2½x3	All Bits	1.50
78	Adj. Screw	71A, 71AB	.60
79	Beveled Washer	71A, 71AB	.50

Minimum charge is 25 cents net, which includes postage.

STANLEY

Parts for "YANKEE" No. 41Y Push Drill



No.	Name of Part	List Each
J313	Chuck Unit	\$0.70
S3089	Chuck Screw	.10
J314	Cylinder Unit Complete	1.80
S3087	Cylinder Nut	.20
SP429	Cylinder Washer Ring	.15
P3032	Cylinder Washer	.15
S3080	Cap	.70
S3088	Cap Pin	.15
S3085	Magazine Nut and Ring	.30
SP426	Magazine Nut Ring	.15
P3031	Magazine or Handle	1.20
SP428	Magazine Spring	.30
CL909	Packet (Nylon Magazine Packet replaces Steel Packet and Bushing)	.20
P3032	Packet Washer	.15
J315	Piston Unit	1.20
S3078	Spindle	.25
P3029	Spindle Washer	.15
SP427	Main Spring	.15
W1017	Main Spring Plug	.15

Parts for No. 59 Doweling Jig

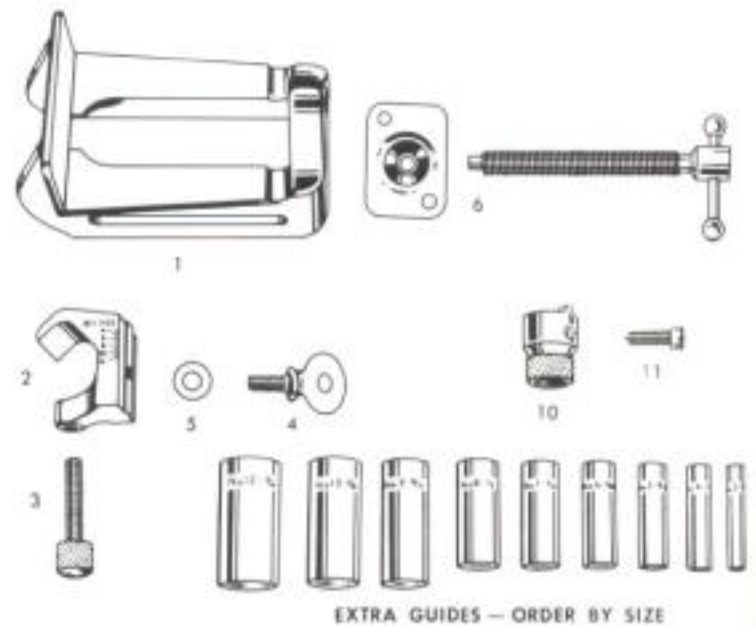

No.	Name of Part	List Each
1	Main Body	\$2.40
2	V Block or Slide Block	.85
3	V Block Thb. Screw	.40
4	V Block Adj. Screw	.40
5	V Block Screw Washer	.15
6	Clamp Screw Complete	.85
10	Depth Gauge or Stop	.60
11	Depth Gauge Screw	.15

Extra Guide Nos.	Size Inch	List Each
3	3/8	\$0.50
4	1/2	.50
5	5/8	.50
6	3/4	.50
7	7/8	.50
8	1	.50
9	1 1/8	.50
10	1 1/4	.50
12	1 3/4	.50

Parts for "YANKEE" Push Drill Nos. 45Y and 46Y

Name of Part	For No. 45Y		For No. 46Y	
	No.	List Each	No.	List Each
Chuck Unit	J317	\$0.70	S3097	\$0.70
Chuck Pin	S3094	.10	S3094	.10
Cap	S3096	.70	CL905	.30
Cap Screw	S3140	.15	—	—
Cap Screw Plug	P3033	.15	—	—
Ferrule	S3091-2	.15	—	—
Main Spring	SP430	.15	P430	.15
Magazine or Handle	CL908	1.20	CL906	.70
Nut	S3093	.50	S3093	.50
Piston Unit	S3090	1.20	S3090	1.20
Spring Plug	P3033	.10	W1018	.10

Parts for Stanley Garden Tools

Replacement Parts for No. PA8 Pruner

No.	Name of Part	List Each
1-8	Anvil and Screw	\$0.30
2-8	Valve Spring	.10
3-8	Pivot Bolt, Nut and Washer	.10
4-8	Plastic Grip (1)	.25

Replacement Parts for No. PA12A Pruner

No.	Name of Part	List Each
1-12A	Anvil and Screw	\$0.30
2-12A	Valve Spring	.10
3-12A	Pivot Bolt, Nut and Washer	.10
4-12A	Plastic Grip (1)	.25

Replacement Parts for PA16 Pruner

No.	Name of Part	List Each
1-16	Anvil and Rivet	\$.25
2-16	Spring	.10
3-16	Bolt — Nut & Washer	.10

Replacement Parts for No. GS30A Grass Shear

No.	Name of Part	List Each
1-30	Catch	\$0.15
2-30	Conical Spring	.25
3-30	Top Blade Assembly	1.50

Replacement Parts for No. GS31A Grass Shear

No.	Name of Part	List Each
1-31	Catch	\$0.15
2-31	Spring	.25
3-31	Nut, Bolt and Washer	.25

Replacement Parts for LS45 Lopping Shear

No.	Name of Part	List Each
2-45	Pivot Bolt	\$.25
LS45H	1 Handle & 2 Handle Bolts	.75

Replacement Parts for No. GW62 Grass Cutter

No.	Name of Part	List Each
1-62	Blade	\$1.00
2-62	Blade Nut, Bolt and Washer	.15

Parts for Marking Gauges Nos. 90G and 91G

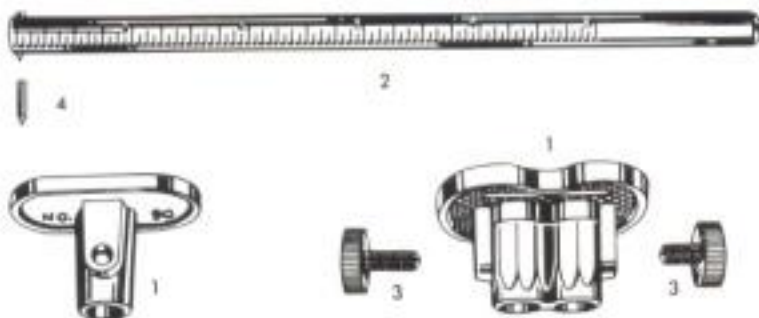

No.	Name of Part	List Each For No. 90G	List Each For No. 91G
1	Main Body	\$1.00	\$2.00
2	Bar	1.00	1.00
3	Thumb Screw	.10	.10
4	Point	.10	.10

Parts for Marking Gauges Nos. 61G and 65G

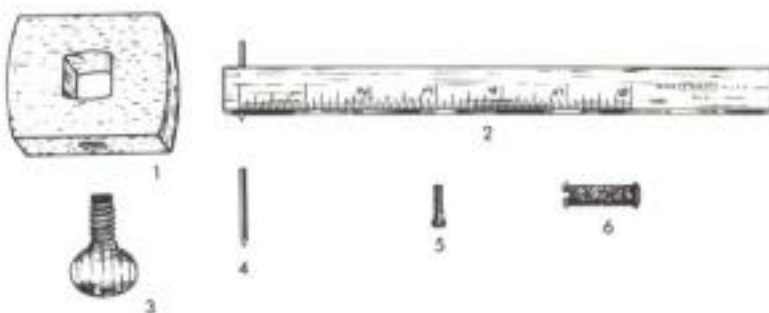

No.	Name of Part	List Each For No. 61G	List Each For No. 65G
1	Main Body	\$0.50	\$1.50
2	Bar	.50	1.50
3	Thumb Screw	.10	.25
4	Point	.10	.10
5	Retaining Screw	.10	.10
6	Brass Shoe	—	.10

Parts for Butt Gauge No. 95G

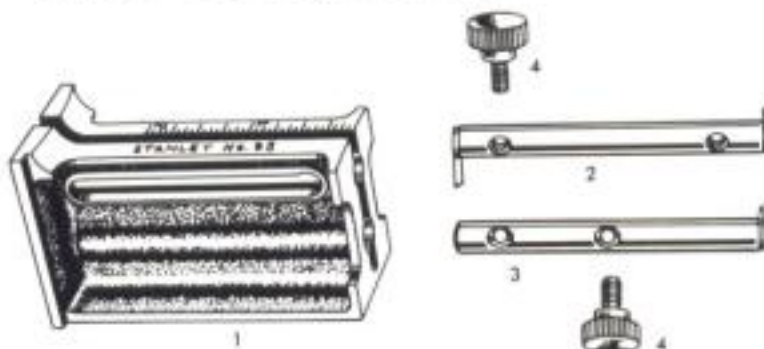

No.	Name of Part	List Each
1	Main Body	\$3.75
2	Double Bar	.50
3	Single Bar	.25
4	Thumb Screw	.10

Replacement Hickory Handles For Wood Handle Hammers



Furnished complete with one wood and one or two metal wedges per handle.

No.	For Hammer Nos.	List Each
RH51	51, 51A, 101, 101A	.90
RH51 1/2	51 1/2, 51 1/2A, 101 1/2, 101 1/2A	.90
RH52	52, 102	.90
RH60B	40, 60B	.90
RH221	221, 221C	.90
RH231	231, 232, 166, 451, 461	.90
RH233	233, 452, 462	.90
RH463	463, 464, 453, 1070H	.90
RH306	306, 306B	.90
RH307	307, 307B	.90
RH308	308, 308B	.90
RH309	309, 309B	.90
RH310	310, 310B	.90
RH311	311, 311B	.90
RH312	312, 312B, 314, 314B	.90
RH401	401, 402, 403, 382, 383, 384, 392, 393	.90
RH431 1/2A	431 1/2A, 431A, 432A	.90
RH602	602, 602B	.90
RH780	780-2, 3, 4 lbs.	.90

HANDYMAN GRADE

No.	For Hammer Nos.	List Each
RH111	20 oz. Claw Hammers	\$0.70
RH111 1/2	16 oz. Claw Hammers	.70
RH112	13 oz. Claw Hammers	.70
RH030B	8 oz. Ball Pein Hammers	.70
RH0309	12 oz. Ball Pein Hammers	.70
RH0310	16 oz. Ball Pein Hammers	.70
RH0401	32-40-48 oz. Engineers and 8/5 Hand Hammers	.90

Replacement Handles for Wood Handle Hatchets

STANLEY GRADE

No.	For Hatchet Nos.	List Each
RH22	Half Hatchets	\$1.10

Replacement Hickory Handles for Sledges — Striking Hammers

No.	For Hammer Nos.	List Each
RH33	33" 6 & 8 lbs.	\$1.80
RH35	35" 10 lbs. to 16 lbs.	1.80

Regripping Kits — All Steel Hammers

No.	For Hammer Nos.	List Each
G13	13 oz. Hammers	\$0.90
G16	16, 20 oz. Hammers	.90
G24	SB24	.90

Replacement Handles for Wood Chisels



No.	For Chisel Nos.	List Price
W701R	720-1/4, 3/8, 1/2, 3/4, 3/4	\$0.80
W605R	720-3/8, 1	.80
W606R	720-1/4, 1 1/2	.80
W607R	720-2	.80
*W609R	750-3/8, 1	.80
*W610R	750-1/4, 1 1/2	.80
W611R	750-1 3/4, 2	.80
W700R	750-3/8, 1/4, 3/8, 1/2, 3/8, 3/4	.80

No.	For	List Price
CL-1	60-1/4, 3/8, 1/2	\$1.00
CL-1-2	60-3/8, 3/4	1.00
CL-3	60-1, 1 1/4	1.10
CL-4	50-1 1/2	1.30
CL-2	60-2	1.30



Replacement Level Glasses

Proved — Clear Fluid

No.	Glass Length In.	List Each
20B	1	\$0.25
	1 1/4	.25
	1 1/2	.25
	1 3/4	.25
	2	.25
	2 1/4	.25
	2 1/2	.30
	3	.35

Level Tubes for Level No. 34V — Complete with covers

No.	For Level Size Inch	Overall Length of Case With End Plugs	Without End Plugs	List Each
LW34V-4	4	3 1/8"	1 1/8"	\$3.16
LW34V-6	6	4 1/8"	3 1/2"	3.70
LW34V-8	8	5 1/8"	4 1/8"	4.40
LW34V-10	10	5 1/8"	4 1/8"	4.60

Level Tubes for Level Nos. 36G and 37G

No.	For Level Size Inch	List Each
LW36-6	Complete with Cover	\$1.70
LW36-24	Complete with Cover	1.70
L36-6	Less Cover	1.26
L36-24	Less Cover	1.26
LW37-24	Complete with Cover	2.50

Plumb Tubes for Level Nos. 36G and 37G

No.	For Level Size Inch	List Each
PW36-6	Complete with Cover	\$1.26
PW36-24	Complete with Cover	1.26
P36-6	Less Cover	1.04
P36-24	Less Cover	1.04
PW37-24	Complete with Cover	2.10

Level Unit—For New Level Series No. L255A



L255A Each \$0.90

Plumb Unit—For New Level Series No. P255A



P255A Each \$0.90

Plumb and Level Vial Replacement Units for Level No. 255A Complete Assembly—Vial, Glass and Holder

Level-Plumb Units—For No. 255V Series†



255V Each \$0.90

† NOTE:—Order Level-Plumb Vial Replacement Unit No. 255V for use with Levels No. 255. Complete unit consisting of 1 Case, 1 Glass and 1 window is interchangeable for Level or Plumb.

Parts for Mitre Boxes Nos. 50MB and 60MB

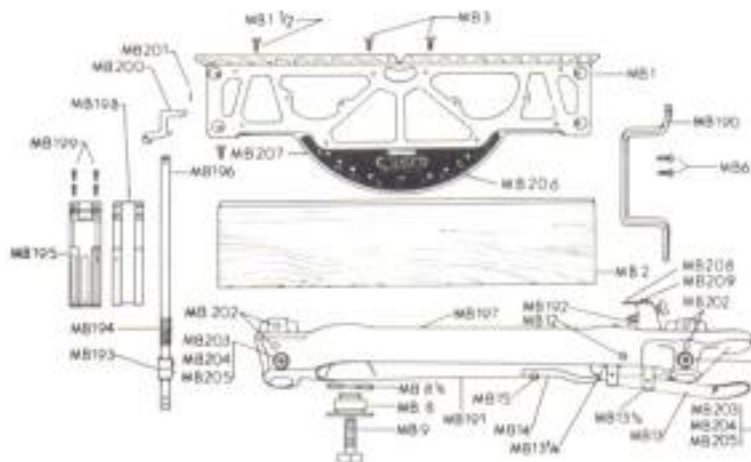

No.	Name of Part	List Each for Nos. 50MB, 60MB
MB1	Frame (Includes Index Plate)	\$14.40
MB1 1/2	Board Screw	.10
MB2	Frame Board	1.80
MB3	Spur Screw	.10
MB189	Uprights Complete, Front or Back	4.80
MB190	Frame Leg (Left)	.70
MB190	Frame Leg (Right)	.70
MB6	Leg Screws (2 Screws)	.10
MB197	Swivel Complete	5.40
MB191	Swivel	3.60
MB88	Swivel Bushing	.35
MB8 1/2	Swivel Washer	.10
MB9	Swivel Screw	.35
MB192	Swivel Check Screw	.10
	Clamp Screw	—
MB206	Index Plate	.85
MB207	Index Plate Screws (3)	.10
MB208	Index Pointer	.10
MB209	Index Pointer Screws (2)	.10
MB12	Index Pin Adjustable Screw	.10
MB13	Index Pin and Lever	.25
MB13 1/2	Index Pin Stud	.70
MB13 3/4	Index Pin Bushing	.40
MB14	Index Pin Spring	.10
MB15	Index Pin Spring Screw	.10
	"T" Base "Front or Back"	—
	Saw Guide Cap Plate	—
	Saw Guide Cap Screw Washer	—
	Saw Guide Cap Screws	—
MB193	Saw Guide Stop and Screw	.35
MB194	Lifting Spring	.25
MB195	Saw Guide Cylinder (1/2 Cylinder)	1.20
MB198	Saw Guide Cylinder Side Plate	.50
	Saw Guide Cylinder Top Plate	—
MB196	Upright (Rod)	1.80
	Leveling Screws	—
MB199	Side Plate Screws (4 Screws)	.10
MB200	Catch	.10
MB201	Catch Pin	
MB202	Upright Fastening Screws (4 Screws)	.10
MB203	Upright Adjusting Screw	.10
MB204	Upright Adjusting Screw Lock Nut	
MB205	Upright Adjusting Screw Lock Washer	

Parts for Mitre Box No. 150

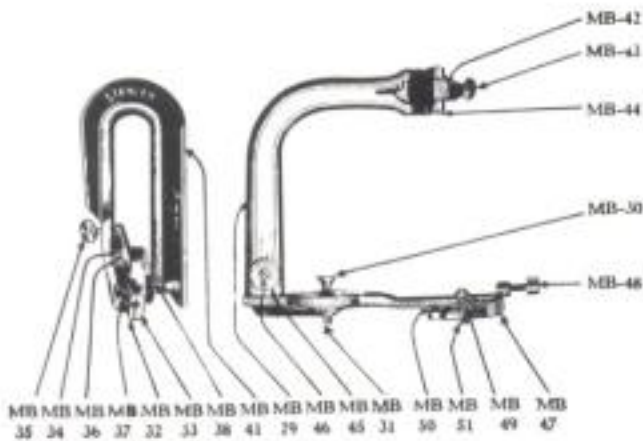
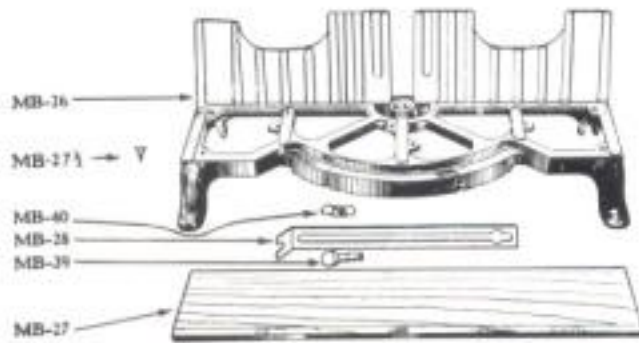

Parts for Mitre Box No. 2360

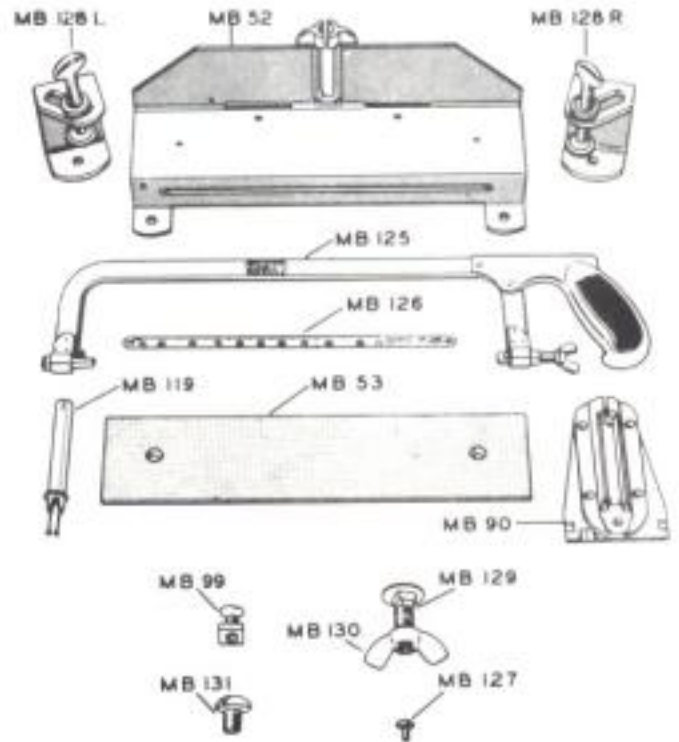

No.	Name of Part	List Each
MB52	Base Complete	\$6.00
MB53	Base Board	.30
MB90	Front Saw Guide	3.00
MB99	Base Board Screw and Nut	.10
MB119	Saw Guide Post and Spring	1.00
MB125	Hock Saw Frame Complete with Blade	6.70
MB126	Degree Scale	1.20
MB127	Degree Scale Screw	.10
MB128R	Right Clamp Bracket	2.40
MB128L	Left Clamp Bracket	2.40
MB129	Front Plate Screw	.10
MB130	Front Plate Wing Nut	.10
MB131	Clamp Bracket Fastening Screw	.10

No.	Name of Part	List Each
MB26	Frame	\$9.60
MB27	Frame Board	1.20
MB27 1/2	Board Screw	.10
MB28	Length Stop	.20
MB29	Swivel Arm	3.60
MB30	Swivel Pivot Screw	.10
MB31	Swivel Pivot Check Nut	.10
MB32	Left Saw Guide	.50
MB33	Right Saw Guide	.60
MB34	Saw Guide Lever	.30
MB35	Saw Guide Thumb Screw	.10
MB36	Saw Guide Pin	.10
MB37	Saw Guide Spring	.10
MB38	Saw Guide Adjusting Screw	.10
MB39	Length Stop Screw	.10
MB40	Length Stop Wing Nut	.10
MB41	Saw Yoke	3.60
MB42	Yoke Clamping Lever	.40
MB43	Yoke Clamping Lever Thumb Screw	.10
MB44	Yoke Clamping Lever Pin	.10
MB45	Roller	.10
MB46	Roller Screw	.10
MB47	Latch	.85
MB48	Latch Fastening Screw	.10
MB49	Latch Pivot Screw	.10
MB50	Latch Spring	.10
MB51	Latch Pivot Set Screw	.10

Parts for Mitre Boxes Nos. H114, 115, 116MB

No. H114

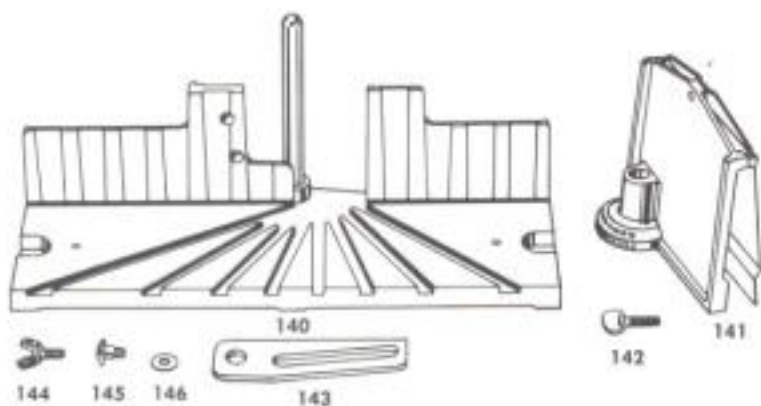

No.	Name of Part	List Each
140	Frame	\$3.00
141	Saw Guide Complete	2.00
142	Saw Guide Thumb Screw	.10
143	Wedge	.35
144	Wedge Wing Bolt	.10
145	Wedge Bolt	.10
146	Wedge Bolt Washer	.10

No. 115

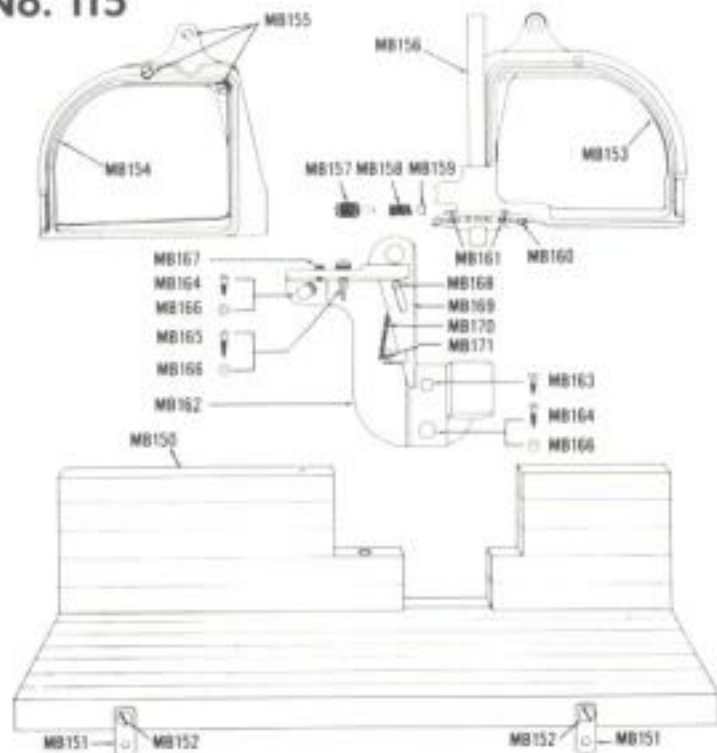

No.	Name of Part	List Each
MB150	Frame	\$8.40
MB151	Bench Stop	.10
MB152	Bench Stop Fastening Screw	.10
MB153	Saw Guide — Left	3.00
MB154	Saw Guide — Right	.90
MB155	Saw Guide Adjusting Screw	.10
MB156	Pivot	.25
MB157	Friction Stop Screw	.10
MB158	Friction Stop Spring	.10
MB159	Friction Stop Shoe	.10
MB160	Index Plate	.50
MB161	Index Plate Screw	.10
MB162	Pivot Bracket	1.50
MB163	Pivot Bracket Screw	.10
MB164	Pivot Bracket Fastening Screw — Short	.10
MB165	Pivot Bracket Fastening Screw — Long	.10
MB166	Pivot Bracket Washer	.10
MB167	Pivot Bracket Set Screw	.10
MB168	Wedge Pin	.10
MB169	Wedge	.35
MB170	Holding Spring	.10
MB171	Spring Fastening Screw	.10

No. 116MB

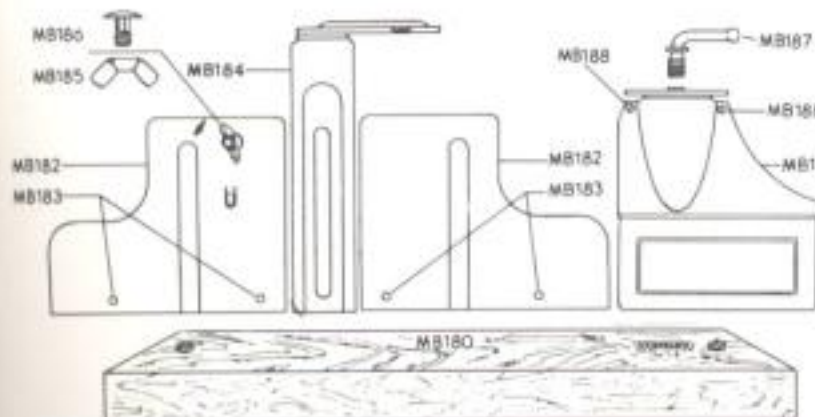

No.	Name of Part	List Each
MB180	Board	\$1.50
MB181	Saw Guide and Index Plate	4.20
MB182	Back Plate Right or Left	.70
MB183	Back Plate Fastening Screws	.10
MB184	Bracket	1.20
MB185	Bracket Wing Nut	.10
MB186	Bracket Wing Nut Bolt	.10
MB187	Clamp (L) Screw	.10
MB188	Saw Guide Adjusting Screws	.10

Minimum charge is 25 cents net, which includes postage.

STANLEY

Parts for Mitre Boxes Nos. 244A, 246A, 346A, 358A and 360A

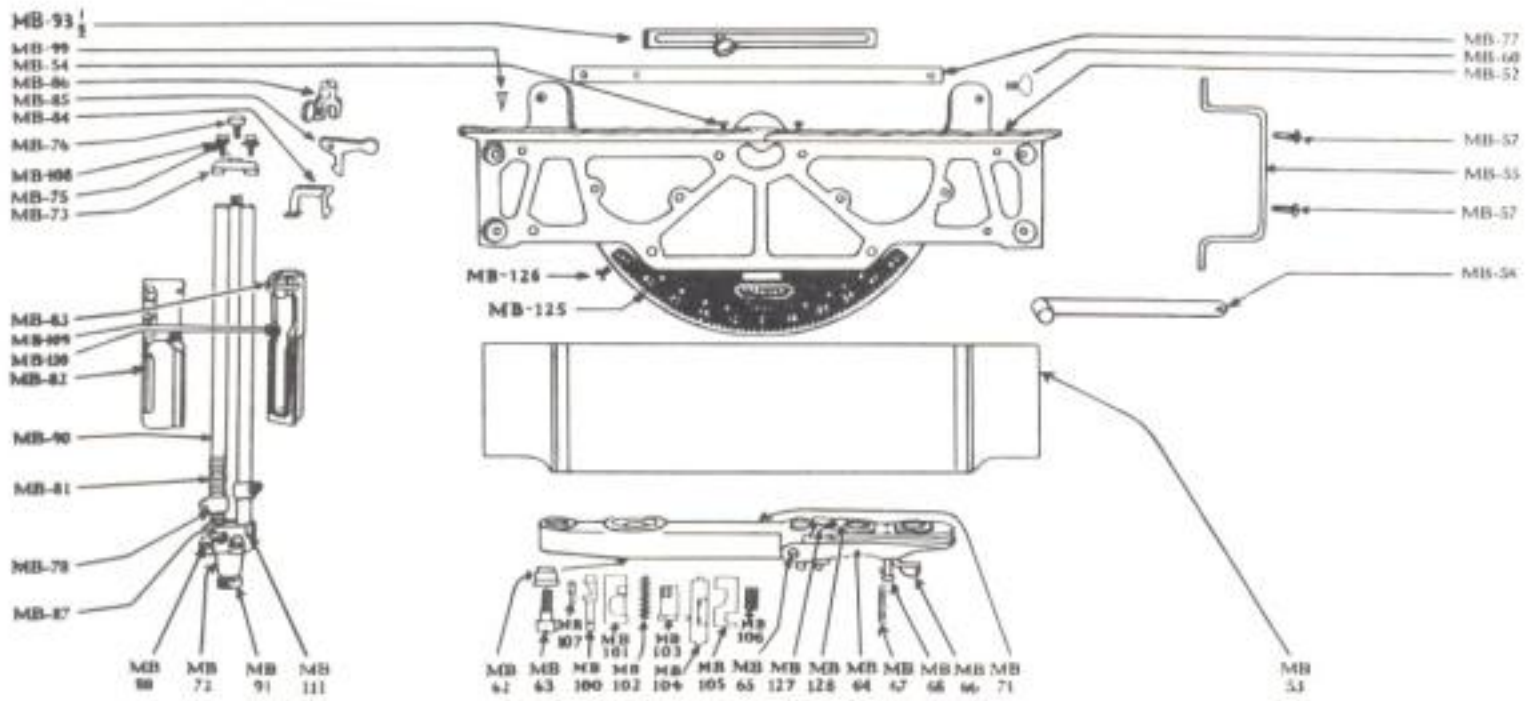

Parts for Mitre Boxes Nos. 2244A, 2246A, 2358A

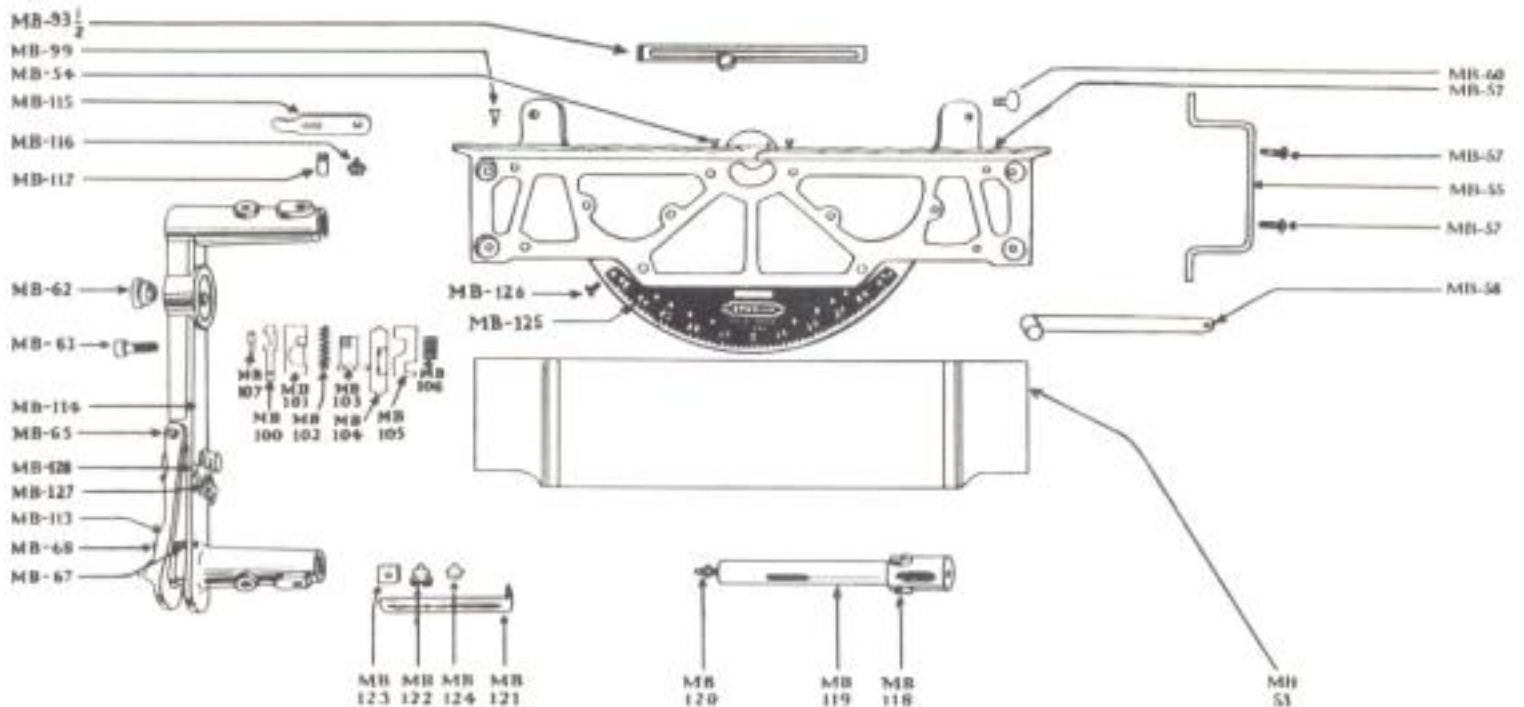

Parts for Mitre Boxes shown on opposite page

Specify name and number of part and number of Mitre Box

No.	Name of Part	List Each for	List Each	List Each	List Each
		Nos. 244A, 246A	For Nos. 346A, 358A, 360A	For Nos. 2244A-2246A	For No. 2358A
MB52	Frame (Includes Index Plate)	\$18.00	\$20.40	\$18.00	\$20.40
MB53	Frame Board	1.80	2.40	1.80	2.40
MB54	Spur Screw	.10	.10	.10	.10
MB55	Frame Leg (Left or Right)	.70	.85	.70	.85
MB57	Leg Screw	.10	.10	.10	.10
MB58	Stack Guide	.60	.60	.60	.60
MB60	Stack Guide Thumb Screw	.25	.25	.25	.25
MB62	Swivel Bushing	.35	.35	.35	.35
MB62½	Swivel Bushing Spring Washer	—	—	.10	.10
MB63	Swivel Bushing Screw	.35	.35	.15	.35
MB64	Index Clamping Lever	1.20	1.20	—	—
MB65	Clamping Lever Screw	.10	.10	.10	.10
MB66	Clamping Lever Catch and Screw	.10	.10	—	—
MB67	Clamping Lever Spring	.10	.10	.10	.10
MB68	Clamping Lever Spring Screw	.10	.10	.10	.10
MB71	Swivel Complete	9.60	10.20	—	—
MB72	"T" Base	1.80	1.80	—	—
MB73	Saw Guide Cap	.25	.25	—	—
MB75	Saw Guide Cap Screws	.10	.10	—	—
MB76	Tie Bar Fastening Screw	.10	.10	—	—
MB77	Saw Guide Tie Bar	.25	.35	—	—
MB78	Saw Guide Stop and Screw (Specify Threaded or Not Threaded)	.35	.35	—	—
MB81	Lifting Spring	.10	.10	—	—
MB82	Saw Guide Cylinder (1½ cylinder)	1.80	1.80	—	—
MB83	Saw Guide Cylinder Plate	.10	.10	—	—
MB84	Trip Lever (Back) with Plate	.35	.35	—	—
MB85	Trip Lever (Front) with Plate	.35	.35	—	—
MB86	Trip Clamp and Screw	.35	.35	—	—
MB87	"T" Block Clamp Screw	.10	.10	—	—
MB88	"T" Block Adjusting Screw	.10	.10	—	—
MB90	Uprights (Each) (Specify Threaded or Not Threaded)	1.20	1.20	—	—
MB91	"T" Base Clamp Screw	.25	.25	—	—
MB93½	Length Gauge and Screw	.30	.30	.30	.30
MB99	Board Screw	.10	.10	.10	.10
MB100	Index Pin	.20	.20	.20	.20
MB101	Index Pin Bushing	.50	.50	.50	.50
MB102	Index Pin Spring	.10	.10	.10	.10
MB103	Index Pin Cam	.30	.30	.30	.30
MB125	Index Plate	.85	.95	.85	.95
MB126	Index Plate Screws (3)	.10	.10	.10	.10
MB127	Index Pointer	.10	.10	.10	.10
MB128	Index Pointer Screws (2)	.10	.10	.10	.10
MB104	Clamping Lever Pin	.90	.90	.90	.90
MB105	Clamping Pin	.35	.35	.35	.35
MB106	Clamping Pin Adjusting Screw	.10	.10	.10	.10
MB107	Index Pin Adjusting Screw	.10	.10	.10	.10
MB108	Saw Guide Cap Lock Washers	.10	.10	—	—
MB109	Roller Bearings and Screws	.20	.20	—	—
MB110	Roller Bearing Screws	.10	.10	—	—
MB111	"T" Base Block	.60	.60	—	—
MB112	Uprights Complete, Front or Back	10.80	10.80	—	—
MB113	Index Clamping Lever	—	—	1.20	1.20
MB114	Swivel Complete	—	—	30.00	30.00
MB115	Stop Spring	—	—	.10	.10
MB116	Stop Spring Screw and Washer	—	—	.10	.10
MB117	Plunger	—	—	.10	.10
MB118	Roll Studs (complete with bearing)	—	—	.30	.30
MB119	Saw Guide (Front or Rear)	—	—	6.00	7.20
MB120	Saw Guide Lifting Screw	—	—	.20	.20
MB121	Saw Depth Gauge	—	—	.55	.55
MB122	Saw Depth Gauge Thumb Screw and Washer	—	—	.20	.20
MB123	Saw Depth Gauge Stop	—	—	.10	.10
MB124	Saw Depth Gauge Stop Screw	—	—	.10	.10

Parts for Mitre Machine No. 100MM and Joining Vise No. 400

In ordering specify name and number of part and number of machine.

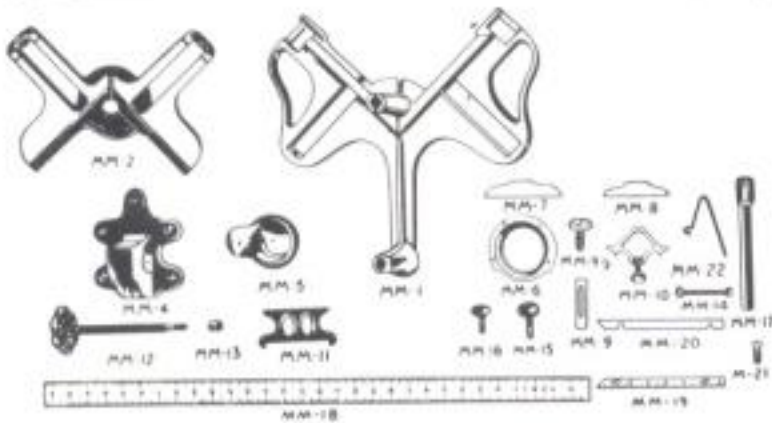

For No. 100MM Machine		
No.	Name of Part	List Each
MM1	Bed Plate	\$18.00
MM4	Base	2.40
MM5	Hinge	3.60
MM6	Ring	2.00
MM7	Threaded Clamp	.85
MM9	Saw Gauge	.25
MM9 1/2	Saw Gauge Screw and Washer	.10
MM10	Rule Gauge and Screw	.85
MM11	Low Clamp (Per Pair)	.50
MM12	Clamp Screw	1.50
MM13	Collar for Clamp Screw	.40
MM14	Hinge Screw and Nut	.25
MM15	Hinge Thumb Screw (Large)	.50
MM16	Ring Thumb Screw (Small)	.25
MM17	Saw Guide	4.80
MM18	Rule, Wood	2.00
MM19	Right and Left Hand Stationary Jaws (Each)	1.20
MM20	Stationary Jaw Spacer	.20
MM21	Stationary Jaw Screw	.10
MM22	Detent Spring	.20
MM23	Roll Studs Complete with Bearing	.30

For No. 400 Vise		
No.	Name of Part	List Each
MM2	Bed Plate	\$7.20
MM4	Base	2.40
MM5	Hinge	3.60
MM6	Ring	1.90
MM8	Threaded Clamp	.60
MM12	Clamp Screw	1.50
MM13	Collar for Clamp Screw	.40
MM14	Hinge Screw and Nut	.25
MM15	Hinge Thumb Screw (Large)	.50
MM16	Ring Thumb Screw (Small)	.25

Replacement Plane Irons

The Single Irons of the same size are identical; thus a 2 1/8 in. Single Iron fits all Planes that take a 2 1/8 in. plane iron. The Cap Iron (which combined with Single Iron makes the Double Iron), however, is not the same in all cases on the Bailey and Circular Planes and is therefore not interchangeable. Order Plane Irons by number. When ordering Cap only, be sure to give the number of the Plane.



Single

No.	Inches	Used in Planes Nos.	List Each
\$1 3/8	1 3/8	2	\$2.10
\$1 3/4	1 3/4	3, 5 1/4	2.10
\$2	2	4, 5	2.10
\$2 1/8	2 1/8	10, 10 1/4, 10 1/2	2.20
\$2 3/8	2 3/8	4 1/2, 5 1/2, 6, 7	2.40
\$2 5/8	2 5/8	8	2.40



Double

No.	Double	List Each	No.	CAP	List Each
D1 3/8		\$2.50	C1 3/8		\$0.45
D1 3/4		2.50	C1 3/4		.45
D2		2.50	C2		.45
D2 1/8		2.60	C2 1/8		.45
D2 3/8		3.10	C2 3/8		.75
D2 5/8		3.10	C2 5/8		.75

For Stanley Block Planes



NON-ADJUSTABLE



ADJUSTABLE

No.	Inches	Used in Planes Nos.	List Each
2BC	1	100, 101P	\$1.10
3BC	1 1/8	60, 60 1/2 P, 203	1.30
6BC	1 3/8	9 1/4, 9 1/2, 18 1/4, 118P, 65, 220	1.30
7BC	1 5/8	110, 130	1.20
9BC	1 3/4	120 (Fine Notches)	1.30

All packed 6 in a box.

Parts for Bench Planes With Smooth and Corrugated Bottoms

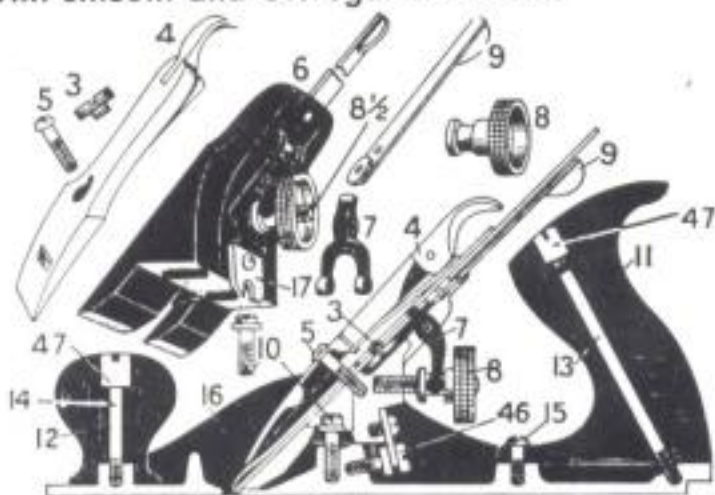

No.	Name of Part	List Each For No. of Plane	3 3C	4 4C	5 5C	5 1/4
3	Cap Screw		\$0.10	\$0.10	\$0.10	\$0.10
4	Lever		1.70	1.70	1.70	1.70
5	Lever Screw		.10	.10	.10	.10
6	Frog Complete		2.40	2.40	2.40	2.40
7	"Y" Adjusting Lever		.10	.10	.10	.10
8	Adjusting Nut		.50	.50	.50	.50
8 1/2	Cutter Adjusting Screw		.10	.10	.10	.10
9	Lateral Adjusting Lever		.25	.25	.25	.25
10	Frog Screw		.10	.10	.10	.10
11	Wood Plane Handle		1.50	1.50	1.50	1.50
	Aluminum Plane Handles					
	No. 3X Fits Planes 3, 4, 5 1/4		2.00	2.00	2.00	2.00
	No. 5X Fits Planes 4 1/2, 5, 6, 7, 8					
12	Wood Plane Knob		1.00	1.00	1.00	1.00
13	Handle Bolt and Nut		.25	.25	.25	.25
14	Knob Bolt and Nut		.25	.25	.25	.25
15	Handle Toe Screw		—	—	.10	—
16	Plane Bottom		3.90	3.90	4.60	4.60
17	Frog Clip and Screw		.25	.25	.25	.25
46	Frog Adjusting Screw		.10	.10	.10	.10
47	Nut only for Handle and Knob Bolts		.10	.10	.10	.10

No.	Name of Part	List Each For No. of Plane	5 1/2 5 1/2C	6 6C	7 7C
3	Cap Screw		\$0.10	\$0.10	\$0.10
4	Lever		1.80	1.80	1.80
5	Lever Screw		.10	.10	.10
6	Frog Complete		2.40	2.40	2.40
7	"Y" Adjusting Lever		.10	.10	.10
8	Adjusting Nut		.50	.50	.50
8 1/2	Cutter Adjusting Screw		.10	.10	.10
9	Lateral Adjusting Lever		.25	.25	.25
10	Frog Screw		.10	.10	.10
11	Wood Plane Handle		1.50	1.50	1.50
	Aluminum Plane Handles				
	No. 3X Fits Planes 3, 4, 5 1/4		2.00	2.00	2.00
	No. 5X Fits Planes 4 1/2, 5, 6, 7, 8				
12	Wood Plane Knob		1.00	1.00	1.00
13	Handle Bolt and Nut		.25	.25	.25
14	Knob Bolt and Nut		.25	.25	.25
15	Handle Toe Screw		.10	.10	.10
16	Plane Bottom		7.20	10.20	11.40
17	Frog Clip and Screw		.25	.25	.25
46	Frog Adjusting Screw		.10	.10	.10
47	Nut only for Handle and Knob Bolts		.10	.10	.10

Add 10 per cent for Corrugated Bottoms.

Parts for Block Planes



No.	Name of Part	List Each For Plane Nos.			
		9 1/4 9 1/2**	60 1/2P**	65**	118P
4	Lever	\$0.60	\$0.60	\$0.60	\$1.80
5	Lever Screw	.10	.10	.10	—
6	Adjusting Slide	—	.25	.25	*
7	Adjusting Lever	.10	—	—	—
8	Adjusting Nut	.25	.25	.25	*
8 1/2	Adjusting Nut Screw	.10	—	—	—
9	Lateral Adjusting Lever	.25	—	—	—
16	Plane Bottom	3.60	3.60	3.60	4.20
21	Eccentric Plate	.25	.25	.25	—
22	Finger Rest Knob	.25	.25	.25	—

*6/8 Adjusting screw and nut one assembly on No. 118P plane ... \$0.60

**On Nos. 9 1/2, 60 1/2P and 65 planes, the adjustable throat is a built-in part of plane bottom. Plane must be returned to factory to have throat fitted.



No.	Name of Part	List Each For Plane Nos.		
		110	203	220
4	Lever	\$1.00	\$0.60	\$0.60
5	Lever Screw	.10	.10	.10
8	Adjusting Screw	—	.25	.25
12	Plane Knob	.25	.25	.25
16	Plane Bottom	1.80	2.10	2.10

In ordering be sure to specify number and name of Part and number and Plane, thus No. 4 Lever for No. 9 1/2 Plane. It will help us if you will include with your order a tracing or rough sketch of the part desired.

Parts for Rabbet and Router Planes

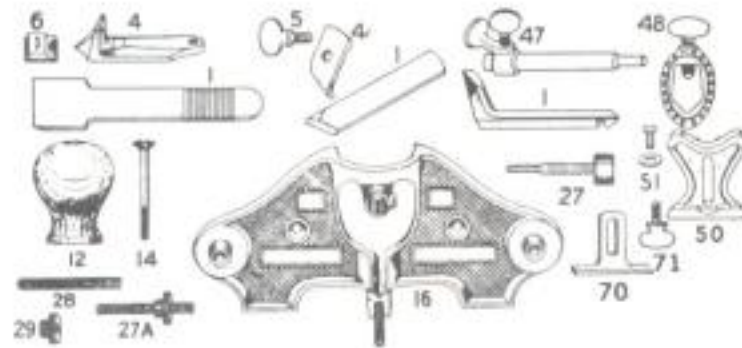

No.	Name of Part	List Each for Nos.		
		90F 92	93	79
1	Plane Iron	\$.70	\$.40
4	Lever		.40	.25
5	Thumb or Cap Screw	.10	.10	.10
6	Frog	.50	.50	—
16	Plane Bottom	*8.40	*9.60	6.00
27	Cutter Adjusting Screw	.50	.50	—
27A	Cutter Adjusting Nut and Screw	.20	—	—
70	Adjusting Depth Gauge	—	—	.50
71	Depth Gauge Screw	—	—	.25

No.	Name of Part	List Each for Nos.		
		71P	271	75
1	Plane Iron	—	\$.70	\$.70
	1/4"	\$.70	—	—
	1/2"	.70	—	—
	3/4"	.70	—	—
4	Lever	—	—	.25
5	Thumb or Cap Screw	—	.10	.10
6	Frog	—	—	—
12	Plane Knob	.40	—	—
14	Knob Bolt and Nut	.25	—	—
16	Plane Bottom	4.80	1.80	*1.80
27	Cutter Adjusting Screw	—	—	—
27A	Cutter Adjusting Nut and Screw	.50	—	—
28	Cutter Adjusting Screw	.25	—	—
29	Cutter Adjusting Nut	.25	—	—
47	Depth Gauge Shoe	1.20	—	—
48	Clamp	1.20	—	—
50	Fence	1.20	—	—
51	Fence Fastening Screw and Washer	.10	—	—

*Price is for both top and bottom. They are not sold separately as they must be machined to fit.

*Price is for both top and bottom. They are not sold separately as they must be machined to fit.

Parts for Rabbet, Matching and Dado Planes

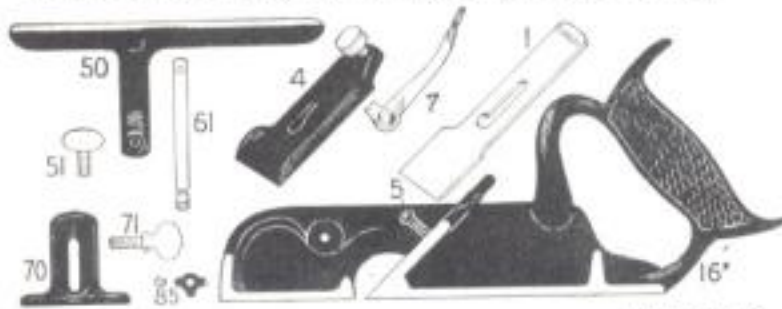

No.	Name of Part	List Each for No.	
		78	
1	Plane Iron	\$0.70	
4	Lever	.50	
4 1/2	Lever Cap Screw	.10	
5	Cutter Holding Screw	.10	
7	Adjusting Lever and Screw	.25	
16	Plane Bottom	4.80	
50	Fence	1.20	
51	Fence Screw	.10	
61	Fence Arm	.25	
70	Adjusting Depth Gauge	.50	
71	Depth Gauge Screw	.25	
85	Spurs with Screws	.10	

In ordering be sure to specify number and name of Part and number of Plane.

Parts for Screw Drivers Nos. 30A, 130A, 31A, 131A and 135A

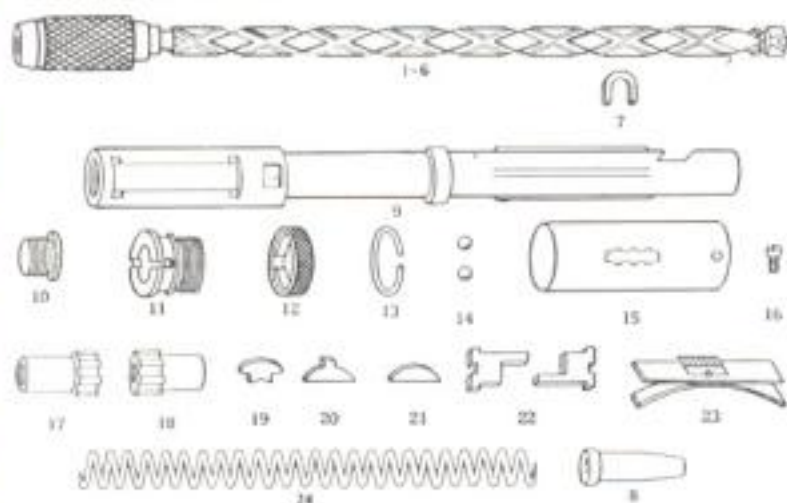

No.	Name of Part	List Each For		
		30A 130A	31A 131A	135A
* 1-6	Spindle and Chuck, complete	\$1.90	\$2.20	\$1.30
7	Spindle Washer	.05	.05	.05
* 9	Shell and Handle Tube	2.00	3.00	1.80
10	Clutch Screw	.20	.20	.20
11	Shell Screw	.30	.40	.30
20	Shell Screw Stop	.05	.05	.05
12	Lock Collar	.25	.30	.20
13	Friction Spring	.05	.05	.05
14	Steel Balls (2 in set)	.05	.05	.05
15	Sleeve for Shell	.60	.60	.50
16	Sleeve Screw	.05	.05	.05
17	Nut to draw Screw	.50	.50	.30
18	Nut to Drive Screw	.40	.55	.40
19	Stop between Nuts	.05	.05	.05
21	Bushing Stop	.05	.05	.05
22	Pawls (2 in set)	.10	.20	.10
* 23	Shifter, complete	.10	.10	.10
25	Handle, only	.35	.40	.30
For "Quick-Return" Style, Only		130A	131A	135A
24	Spring in Handle	.10	.20	.10
8	Spring Plug	.05	.05	.05

Items marked * necessarily assembled and not furnished separately.
Parts 24 and 8 will fit only Nos. 130A, 131A, and 135A Drivers.

Parts for Screw Drivers Nos. 133H and 233H

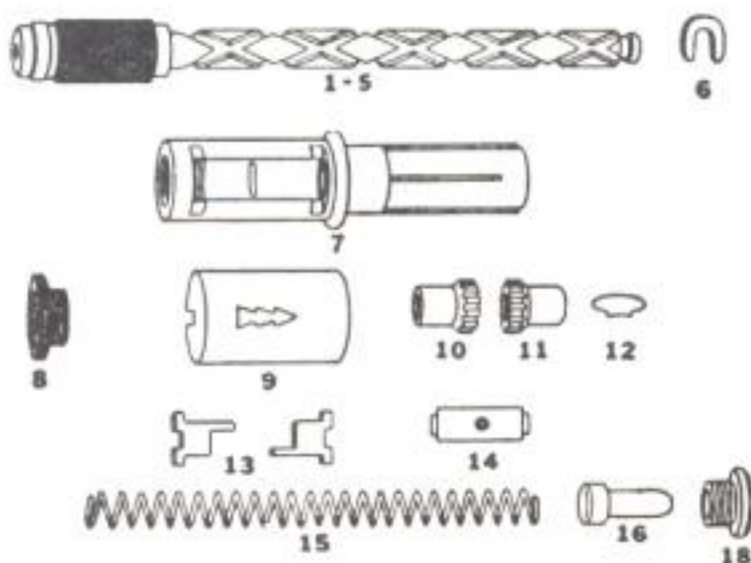

No.	Name of Part	List Each For	
		No. 133H	No. 233H
* 1-5	Spindle and Chuck, complete	\$1.20	\$1.20
6	Spindle Washer	.05	.05
7	Shell	.60	.60
8	Shell Screw	.25	.25
9	Sleeve for Shell	.40	.40
10	Nut to draw Screw	.40	.40
11	Nut to drive Screw	.40	.40
12	Stop between Nuts	.05	.05
13	Pawls	.10	.10
14	Shifter, complete	.10	.10
15	Spring in Handle	.10	.10
16	Spring Plug	.05	.05
18	Clutch Screw	.10	.10
19	Handle, only	.10	.40
20	Cap	—	.40

When ordering, state part number and part name, also number of tool.
Items marked * necessarily assembled and not furnished separately.

Parts for Combination Squares Nos. 215, 225, 122

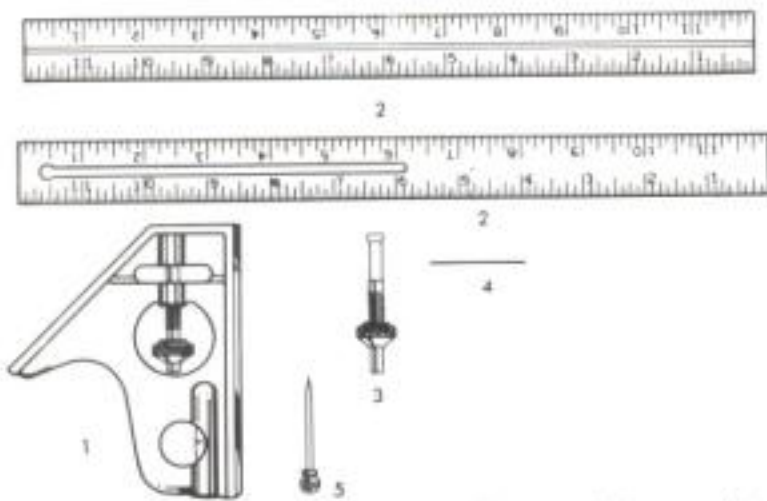

No.	Name of Part	List Each For No. 215	List Each For No. 225	List Each for No. 122
1	Main Body	\$2.50	\$3.00	\$2.50
2	Blade Slatted	1.00	—	—
2	Blade Grooved	—	1.00	1.00
3	Lock Pin and Screw	.25	.25	.25
4	Spring	.10	.10	.10
5	Scriber	.10	.10	.10

Parts for Bevel No. 18TB

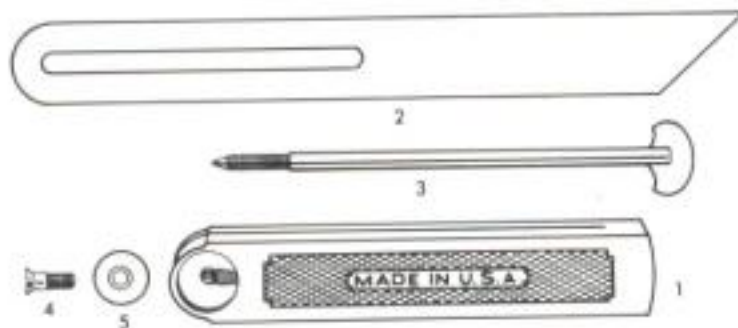

No.	Name of Part	List Each 6 Inch	List Each 8 Inch	List Each 10 Inch	List Each 12 Inch
1	Handle	\$1.50	\$1.60	\$1.70	\$2.00
2	Blade	1.50	1.60	1.70	2.00
3	Bolt	.10	.10	.10	.10
4	Pivot Screw	.10	.10	.10	.10
5	Pivot Washer	.10	.10	.10	.10

Parts for Bevel No. 25TB

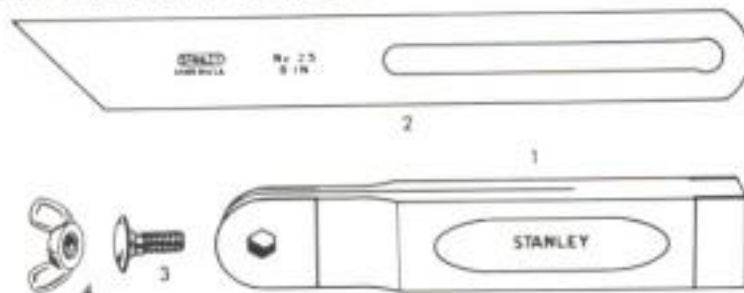

No.	Name of Part	List Each 6 Inch	List Each 8 Inch	List Each 10 Inch	List Each 12 Inch
1	Handle	\$1.50	\$1.75	\$2.00	\$2.25
2	Blade	.50	.50	.50	1.00
3	Bolt	.10	.10	.10	.10
4	Wing Nut	.10	.10	.10	.10

Parts for Stanley Yankee Vises Nos. 991A, 992A, 993A, 994A

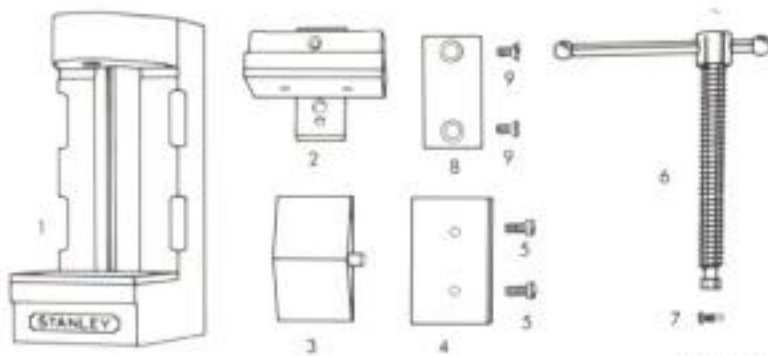

No.	Name of Part	List Each for All Vises
1	Main Jaw	\$2.50
2	Slide Jaw	2.00
3	Swivel Jaw	1.00
4	Jaw Faces (pair)	1.00
5	Jaw Face Screws (4)	.20
6	Feed Screw and Handle	1.00
7	Retaining Screw	.10
8	Gib for Slide Jaw	.10
9	Gib Screws (2)	.10

Parts for Stanley "Yankee" Angle Vises Nos. 3992A, 3993A, Swivel-Tilt Vises Nos. 4992A and 4993A, and Swivel-Tilt Bases Nos. 6992A, 6993A

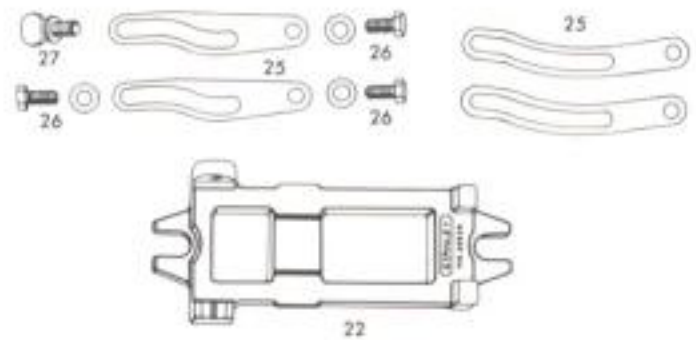

No.	Name of Part	List Each
22	Intermediate Base	\$2.00
25	Angle Plates (2)	.40
26	Bolt and Washers (3)	.30
27	Thumb Bolt and Washer	.20
28	Swivel Pin (2) Not Illustrated	.30

Parts for Stanley "Yankee" Swivel Vises Nos. 1992A, 1993A and Swivel Bases Nos. 5992A, 5993A

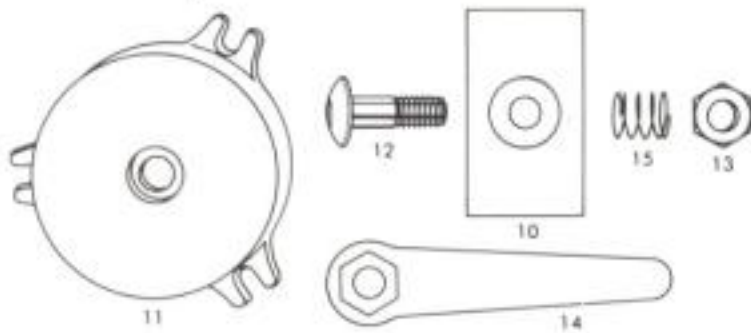

No.	Name of Part	List Each
10	Base Plate	\$0.25
11	Swivel Base	1.50
12	Draw Bolt	.25
13	Draw Nut	.20
14	Wrench	.50
15	Riser Spring	.10

Parts for Woodworkers Vise No. 700

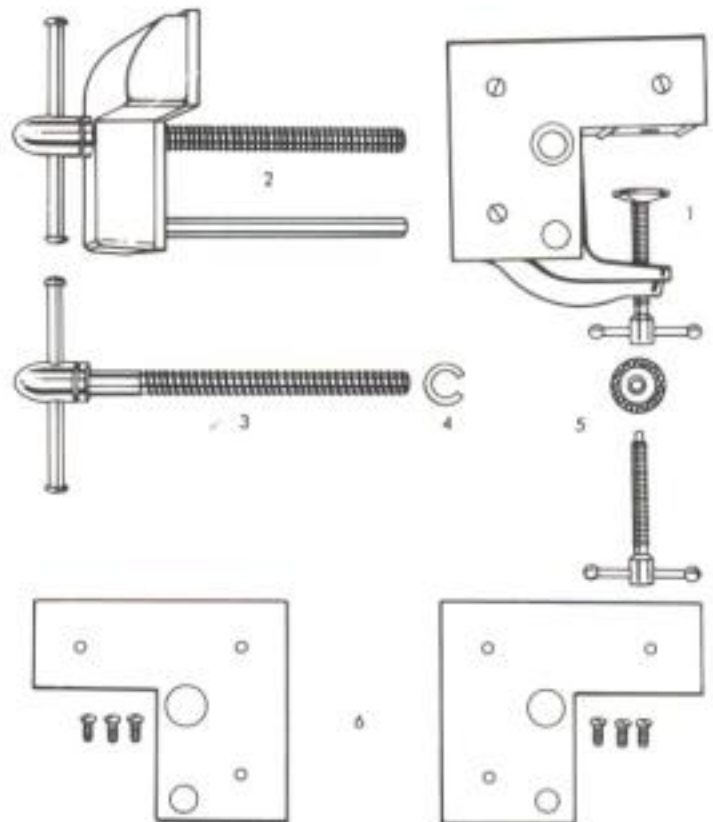

No.	Name of Part	List Each
1	Main Jaw	\$3.75
2	Slide Jaw	3.75
3	Feed Screw and Handle	.75
4	Retaining Washer	.10
5	Clamp Screw Complete	.50
6	Jaw Faces and Screws (pair)	.75

Parts for Woodworkers Vise No. 702

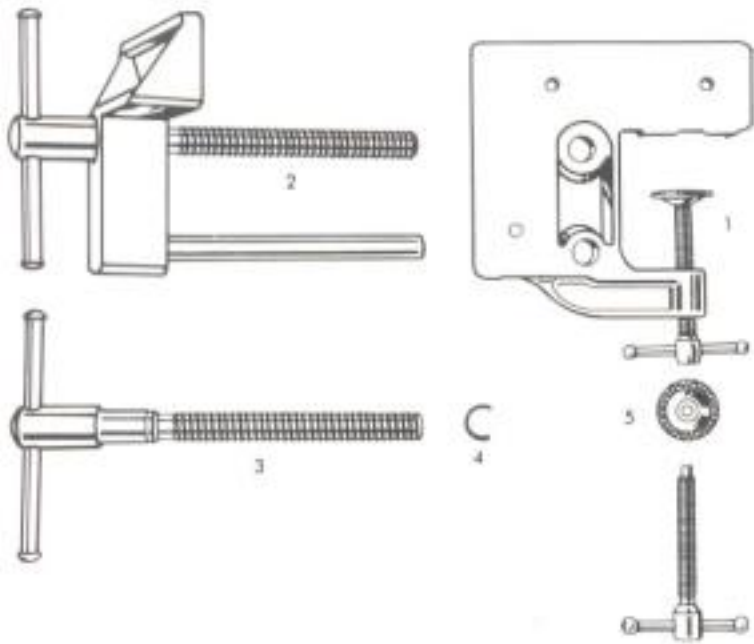

No.	Name of Part	List Each
1	Main Jaw	\$2.50
2	Slide Jaw	2.50
3	Feed Screw and Handle	.75
4	Retaining Washer	.10
5	Clamp Screw Complete	.50

Parts for Vises Nos. 763V, 765V, 766V Series and 743V, 745V, 746V Series

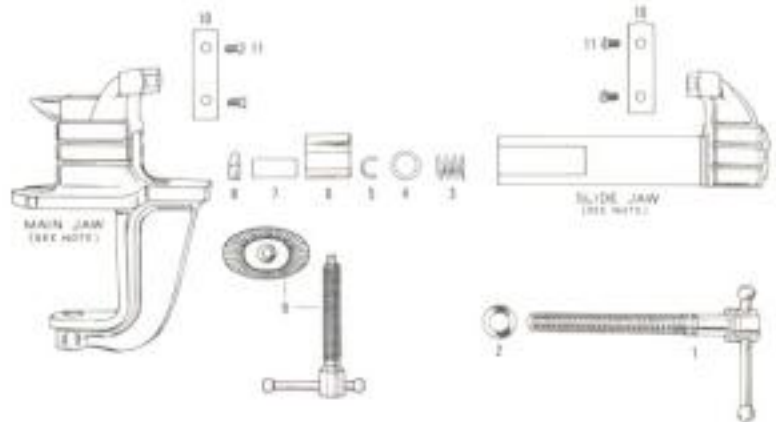

No.	Name of Part	List each for 763V, 765V, 766V	List each for 743V, 745V, 746V
1	Vise Screw and Handle	\$1.00	\$1.00
2	Vise Screw Washer (Outside)	.10	.10
3	Vise Screw Spring	.10	.10
4	Vise Screw Washer (Inside)	.10	.10
5	Vise Screw Retaining Spring	.10	.10
6	Feed Nut	.50	.50
7	Feed Nut Key	.10	.10
8	Feed Nut Pin	.10	.10
9	Clamp Screw with Cap & Handle	.90	.90
10	Jaw Inserts (Pair)	1.00	—
11	Jaw Insert Screws (4 to a set)	.10	—

Note: The main Jaw and Slide Jaw are not interchangeable. Vise must be returned to the factory to have jaws fitted.

Parts for Stanley Saw Sets

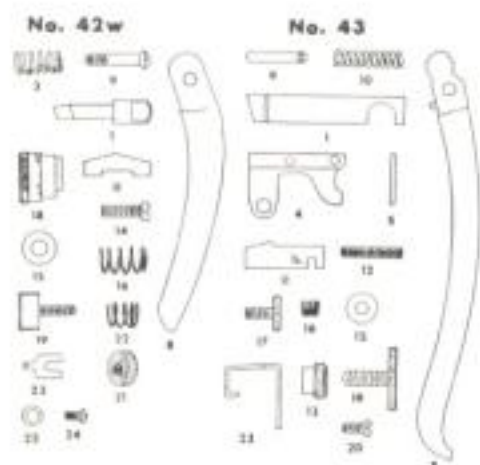

No.	Name of Part	List Each for Nos.	
		42W	43
1	Plunger	\$0.50	\$1.00
3	Plunger Spring	.10	—
4	Plunger Rest	—	1.00
5	Plunger Rest Rivet	—	.10
6	Plunger Bushing	—	—
7	Plunger Bushing Spring	—	—
8	Trigger Lever	.50	.85
9	Trigger Pin or Screw	.10	.10
10	Trigger Spring	—	.10
11	Anvil	.30	.60
12	Anvil Cl. Bolt	—	.10
13	Anvil Cl. Nut	—	.10
14	Anvil Cl. Screw	.10	—
15	Anvil Cl. Screw Washer	.10	.10
16	Anvil Cl. Spring	.10	.10
17	Anvil Adj. Screw	—	.10
18	Anvil Adj. Cam	.40	—
19	Stop	.20	.40
20	Stop Cl. Screw	—	.10
21	Stop Adj. Nut	.25	—
22	Stop Spring	.10	—
23	Circ. Saw Attachment	.10	.10
24	Circ. Saw Screw	.10	—
25	Circ. Saw Washer	.10	—

Replacement Adapter for "Surform" Drum Tool

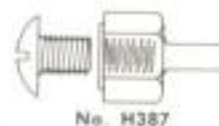

For use with No H386B Replacement Drum. Fits any 1/4" or larger drill chuck. Individually packed in envelope with instructions.

No.	For use with H386B Replacement Drum	List Each
H387	1/4" Shank	\$0.60

Parts for Stanley "Yankee" Ratchet Tap Wrenches

No.	Names of Part	List Each for Nos.
		250A, 251A
1	Chuck, complete including Ratchet	\$ 2.20
2	Chuck Shell	.80
3	Chuck Jaws (Set of 2)	.70
4	Chuck Jaw Spring	.10
5	Pawls (Set of 2)	.10
6	Shifter	.10
7	Handle	.30
8	Sleeve	.40
9	Sleeve Screw	.10

Minimum charge is 25 cents net, which includes postage.

STANLEY

STANLEY

®

THE TOOL BOX OF THE WORLD

STANLEY TOOLS, DIVISION OF THE STANLEY WORKS, NEW BRITAIN, CONNECTICUT