

Used stock sheets	2
Total used area	8320 90%
Total wasted area	896 10%
Total cuts	112
Total cut length	2251.36
Cut / blade / kerf thickness	0.14

Panels	6×33 x8 \ 6×27 x8 \ 4×16 x32 \ 4×16 x16 \ 6×16 x16 \ 4×13 x16
Stock sheets	48×96 x2

Stock sheet	48×96
Used area	4166 90%
Wasted area	442 10%
Cuts	73
Cut length	1323.9
Panels	64
Wasted panels	10

Panel	Qty
6×33	1
4×16	27
4×16	16
6×16	4
4×13	16

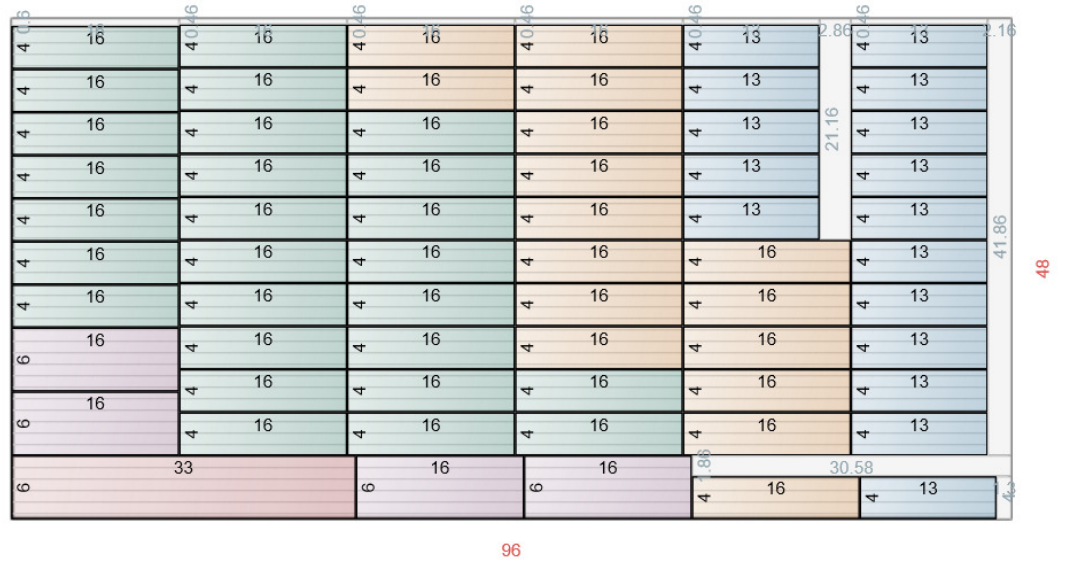

Stock sheet	48×96
Used area	4154 90%
Wasted area	454 10%
Cuts	39
Cut length	927.46
Panels	32
Wasted panels	8

Panel	Qty
6×33	7
6×27	8
4×16	5
6×16	12

