

Part Drawings:

Part 1: BASE BEAMS

Part 1: Quantity 2off per Unit: Material Wood

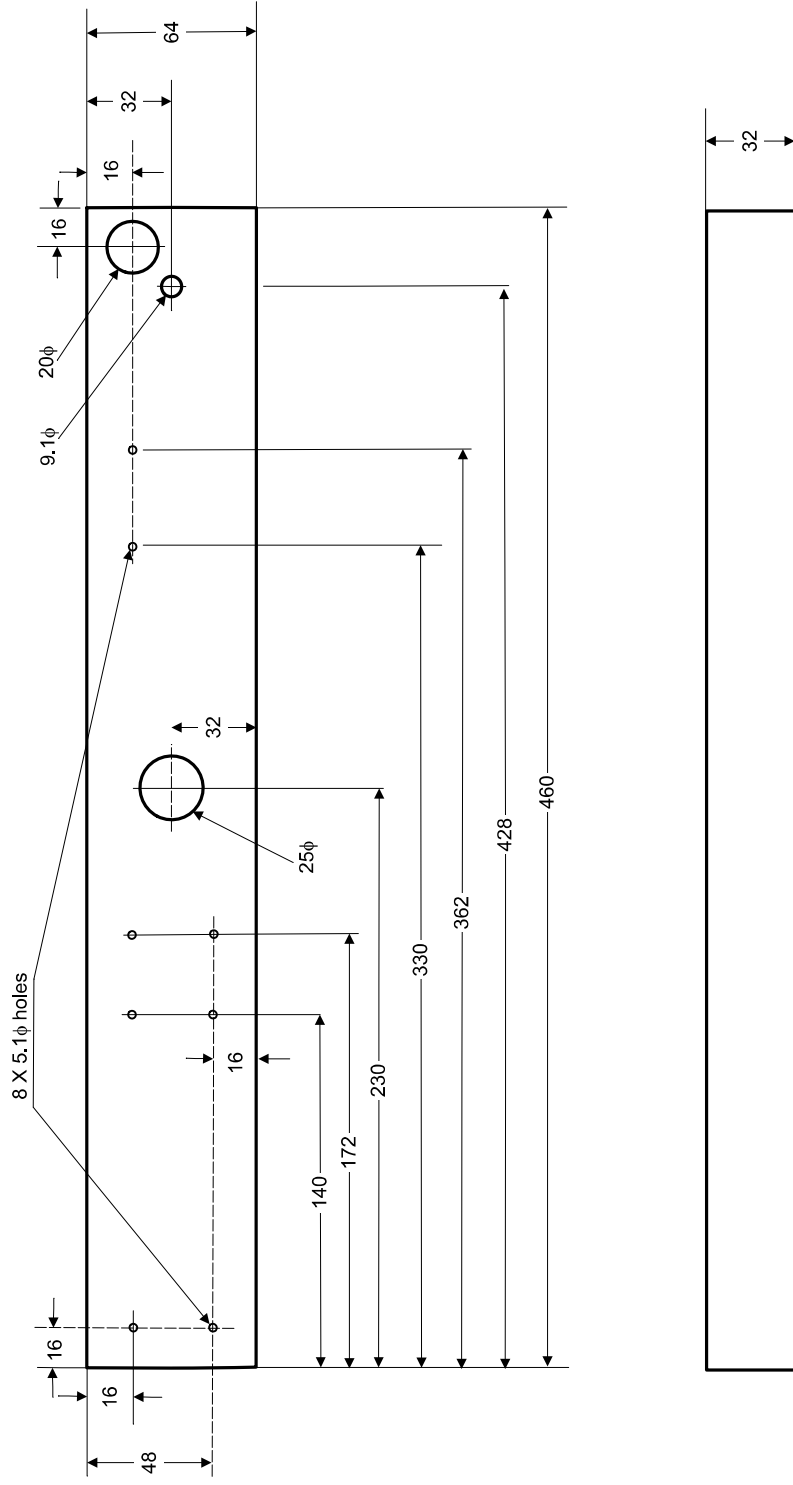

Part 2: FRONT BRACE

Part 2: Quantity 1 off per Unit: Material Wood

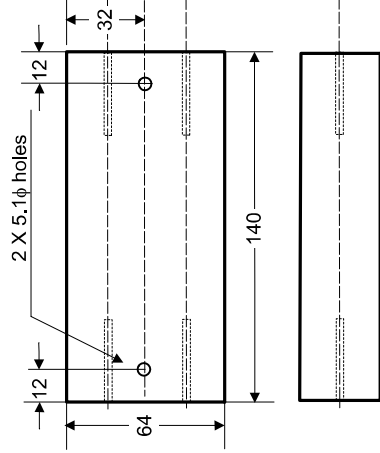

Part 3: SQUARE BRACE

Part 3: Quantity 2 off per Unit: Material Wood

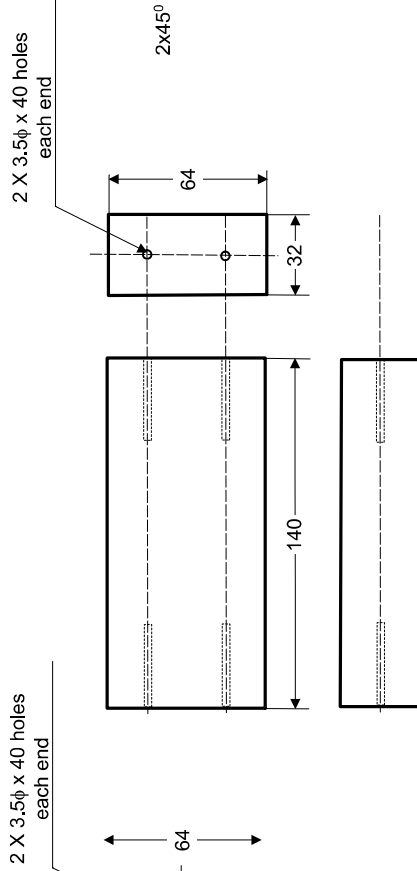

Part 4: FEET

Part 4: Quantity 4 off per Unit: Material Wood

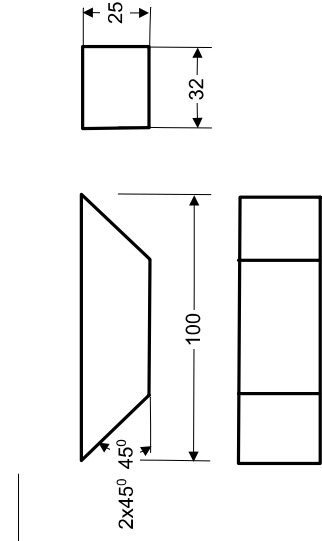

Part 5: ANGLED STRUTS

Part 5: Quantity 2 off per Unit: Material Wood

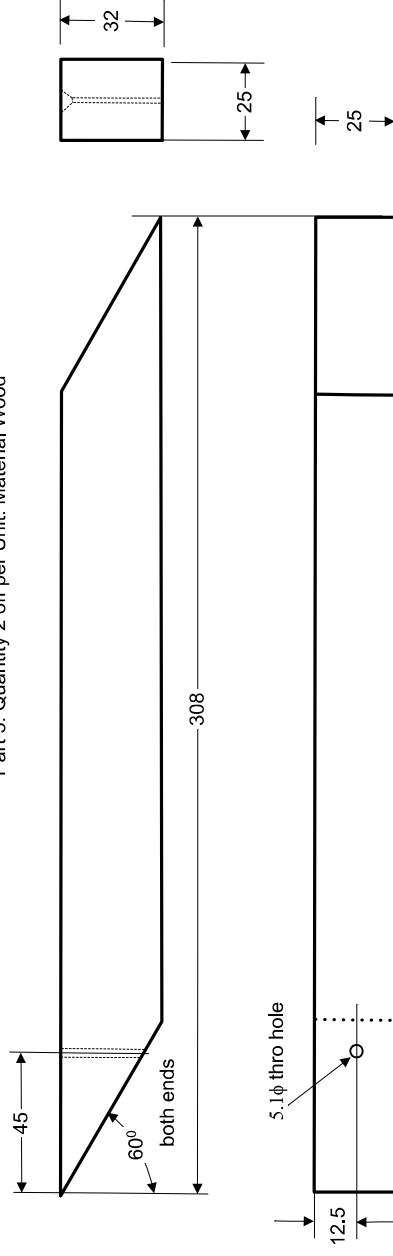

Part 6: VERTICAL BEAMS

Part 6: Quantity 2 off per Unit: Material Wood

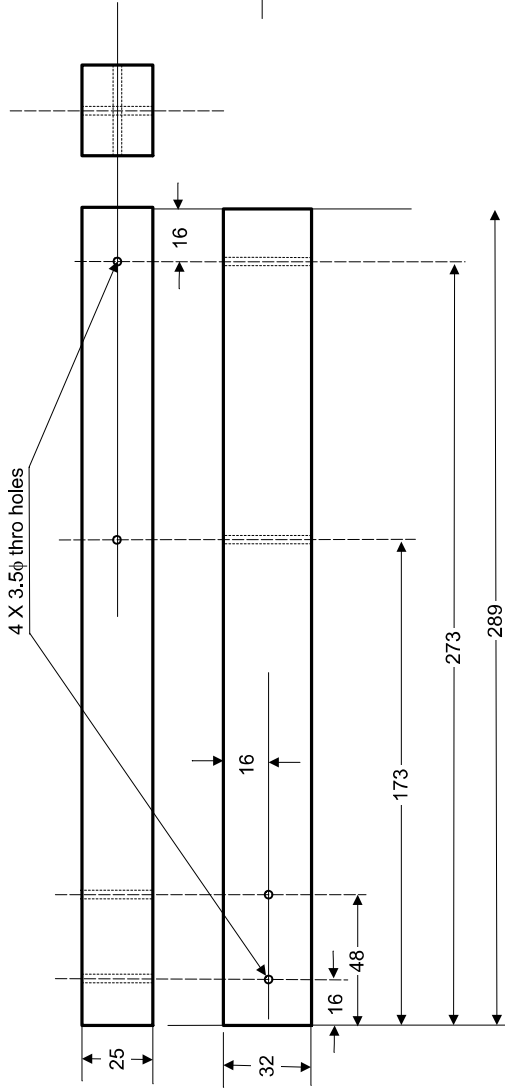

Part 7: STRIKE BARS

Part 7: Quantity 2 off per Unit: Material Wood

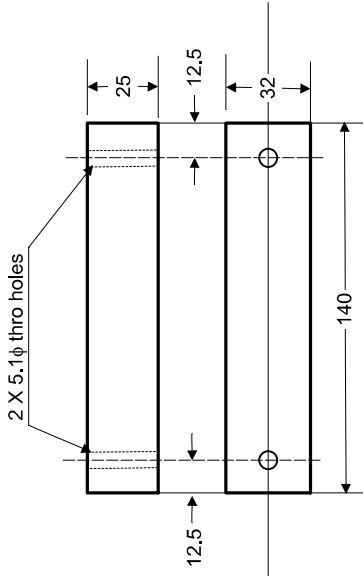

Part 12: Steel rods

Part 12: Quantity 2 off per Unit: Material Steel (see BOM)

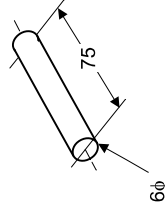

Part 11: DOWELS

Part 11: Quantity 5 off per Unit: Material Wood (standard dowel see BOM)

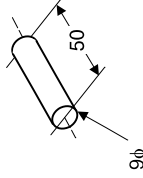

Part 8: SKEIN ANCHOR BLOCKS

Part 8: Quantity 2 off per Unit: Material Wood

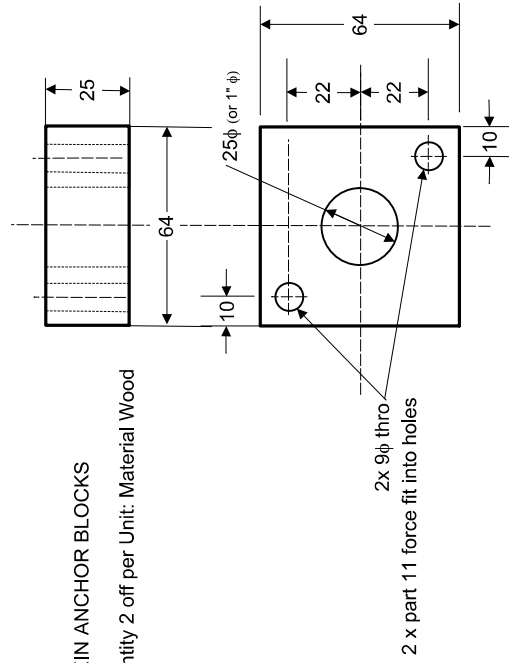

Part 13: DOWELS

Part 13: Quantity 2 off per Unit: Material Wood (standard dowel see BOM)

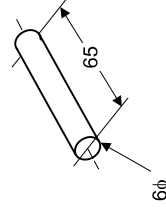

Part 9: THROWING BAR

Part 9: Quantity 1 off per Unit; Material Wooden Dowel

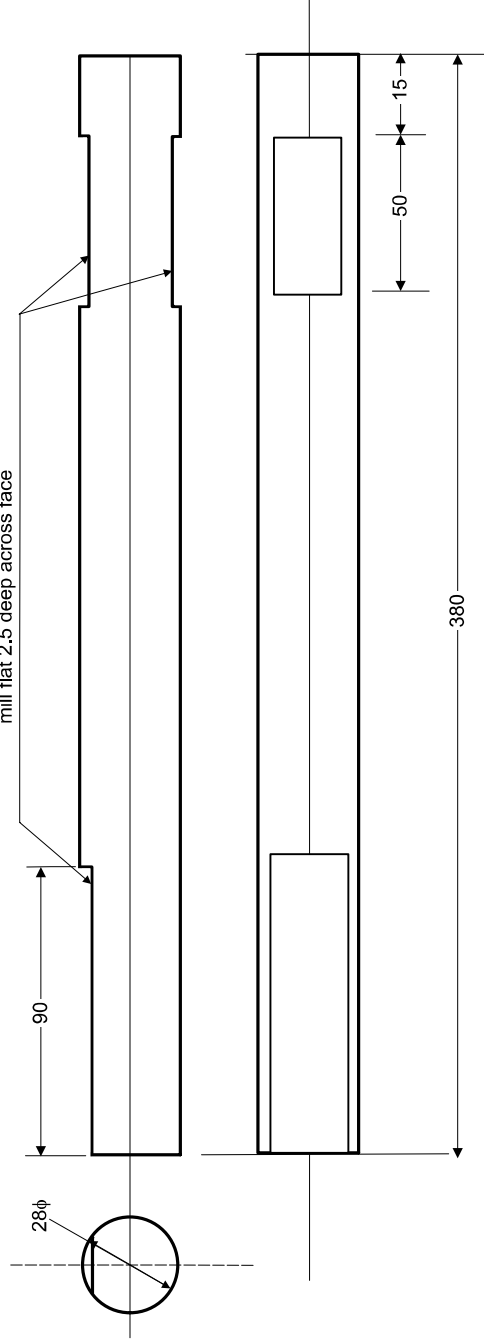

Part 10: WINCH DOWEL

Part 10: Quantity 1 off per Unit; Material Wooden Dowel

