

# Compound Entrance

## Compound Entrance

### Relay Outputs

AC1: AC 110V - Electric firecracker, igniter, and solenoid for water

AC2: AC 110V - Solenoid for gas

Ambient Audio: Police sirens, fire truck horns, and car alarms

Scare Audio: Tornado siren and robotic voice warning message

Controller: PicoBoo AC

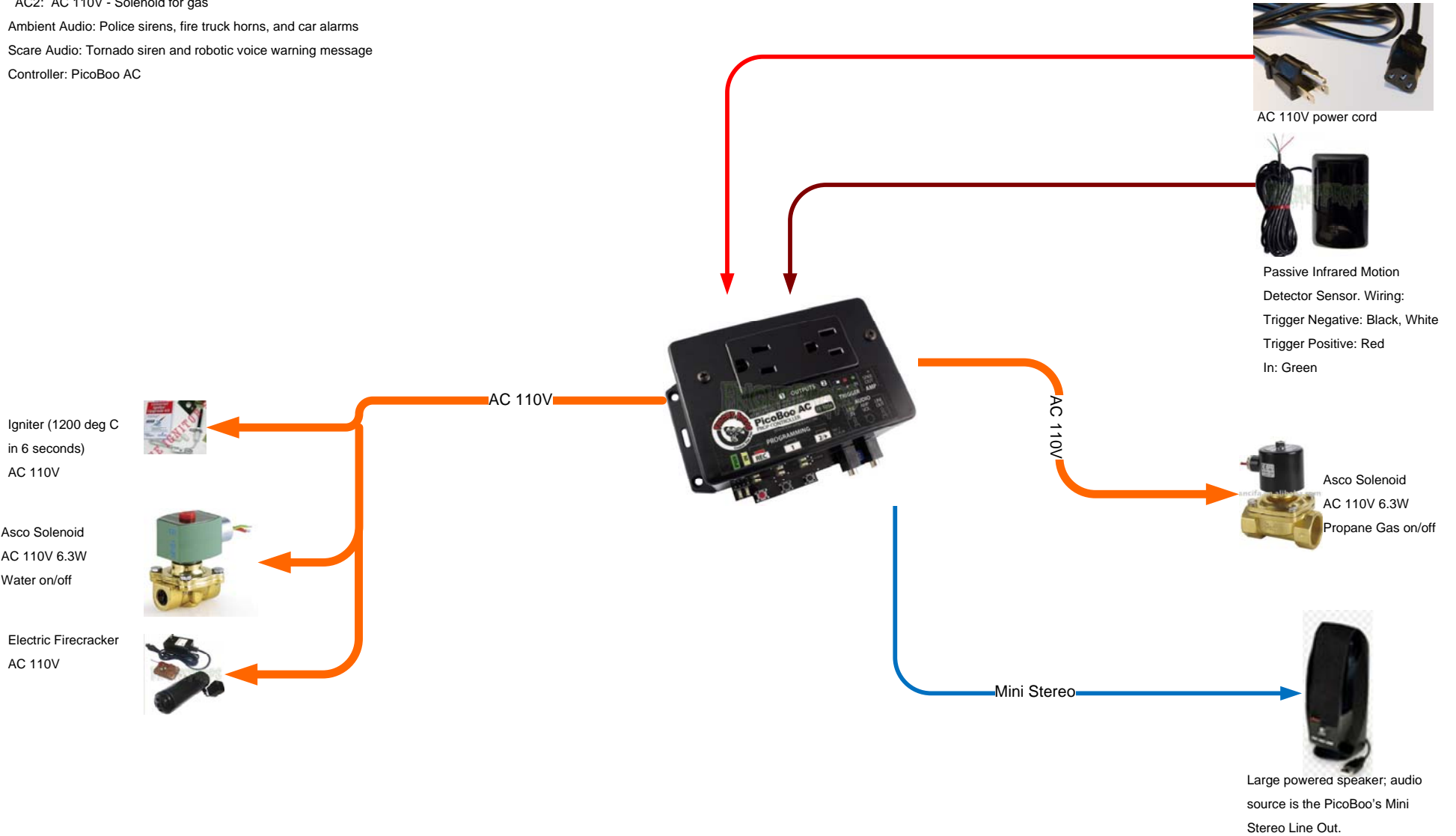

# Mad Dog in Great Room

## Mad Dog

Trigger: Beam Sensor at top of steps from foyer to great room

Power In: 110 VAC

Power Out:

1 12VDC power supply for pneumatic cylinder extension

2 12VDC power supply for pneumatic cylinder retraction

Ambient Audio: none

Scare Audio: Vicious barking 4s for extension; growling 6s for retraction

Controller: PicoBoo AC

Pneumatic Cylinder, McMaster-Carr PN 6491K36; and  
Solenoid Air Directional Control Valve, McMaster-Carr PN 6196K24

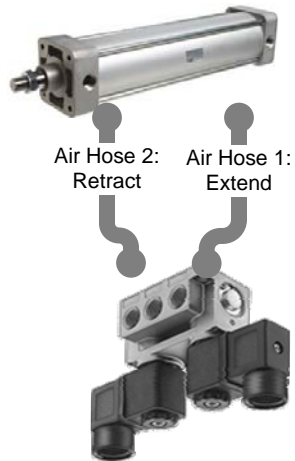

AC 110V power cord



Beam Sensor. Wiring:  
Trigger Negative: Blue, White  
Trigger Positive: Brown  
In: Black



Non-powered speaker  
driven by PicoBoo's 10W output and  
amplified by an old stereo receiver

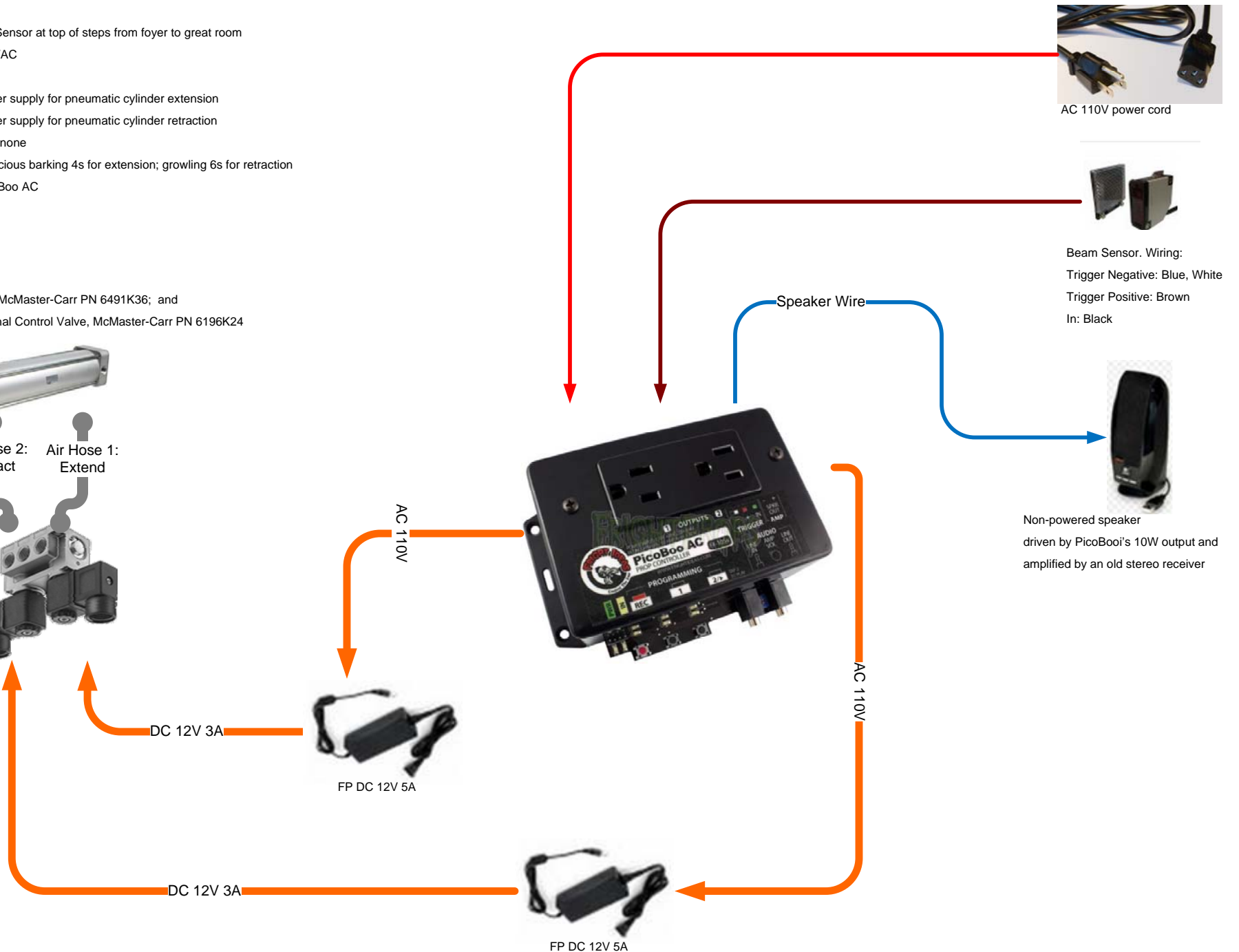

# UC Davis Box

## UC Davis Box

Trigger: Beam Sensor 2 feet in front of the box.

Power In: 110 VAC

Power Out:

1 DC 12V power supply for windshield wiper motor

2 AC 110V red light inside box

Ambient Audio: Low zombie groans, chains clanking.

Scare Audio: Agitated zombie grunts and groans.

Controller: PicoBoo AC

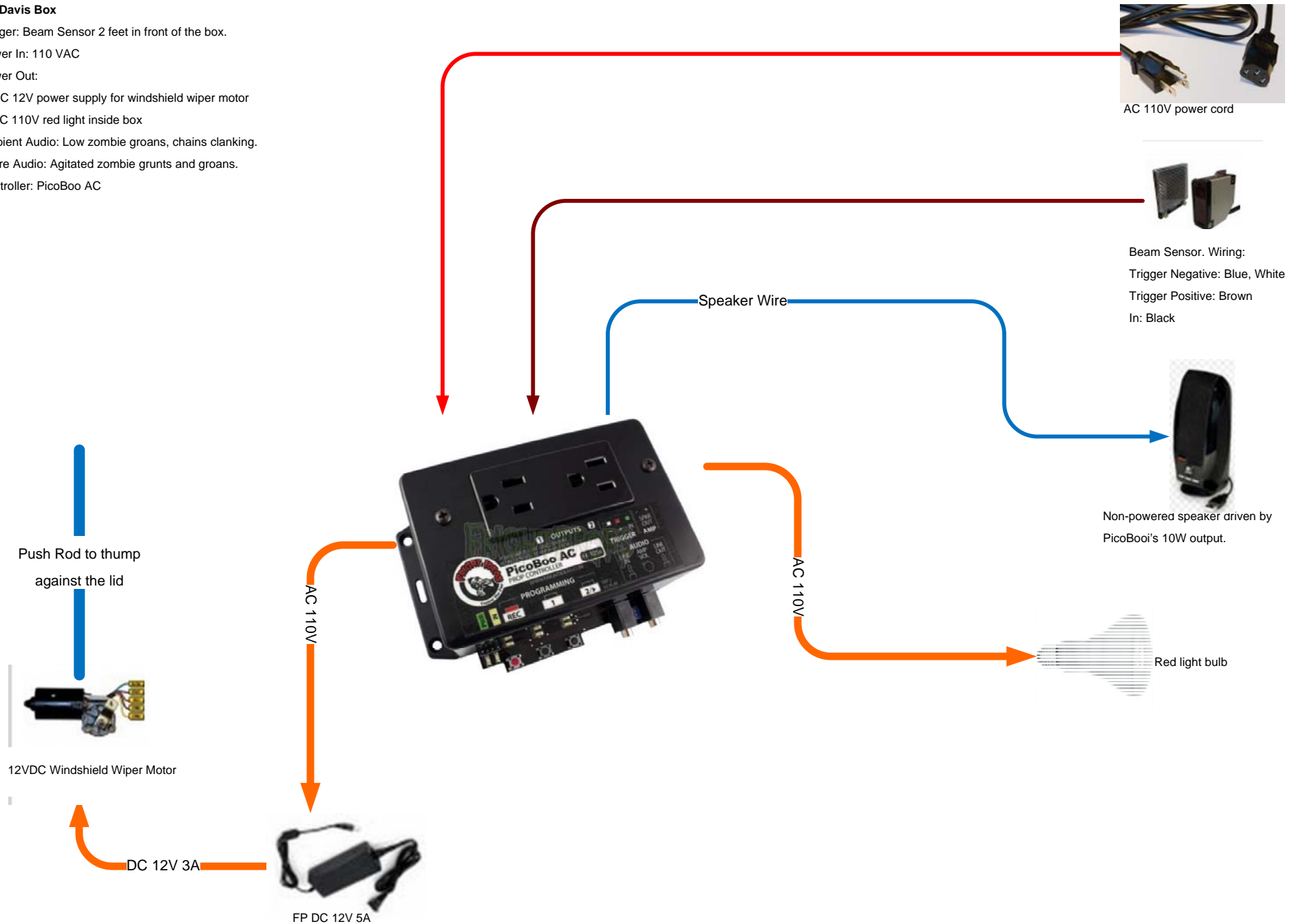

# Chain Saw in Shower

Chain Saw

Trigger: Magnetic Door Sensor

Power In: AC and DC

Power Out:

- 1: AC to solenoid which activates trigger
- 2: DC 12V to linear actuator

Audio 1: Spooky woods noise

Audio 2: Chain Saw

Controller: PicoBoo AC for solenoid, and PicoVolt for linear actuator

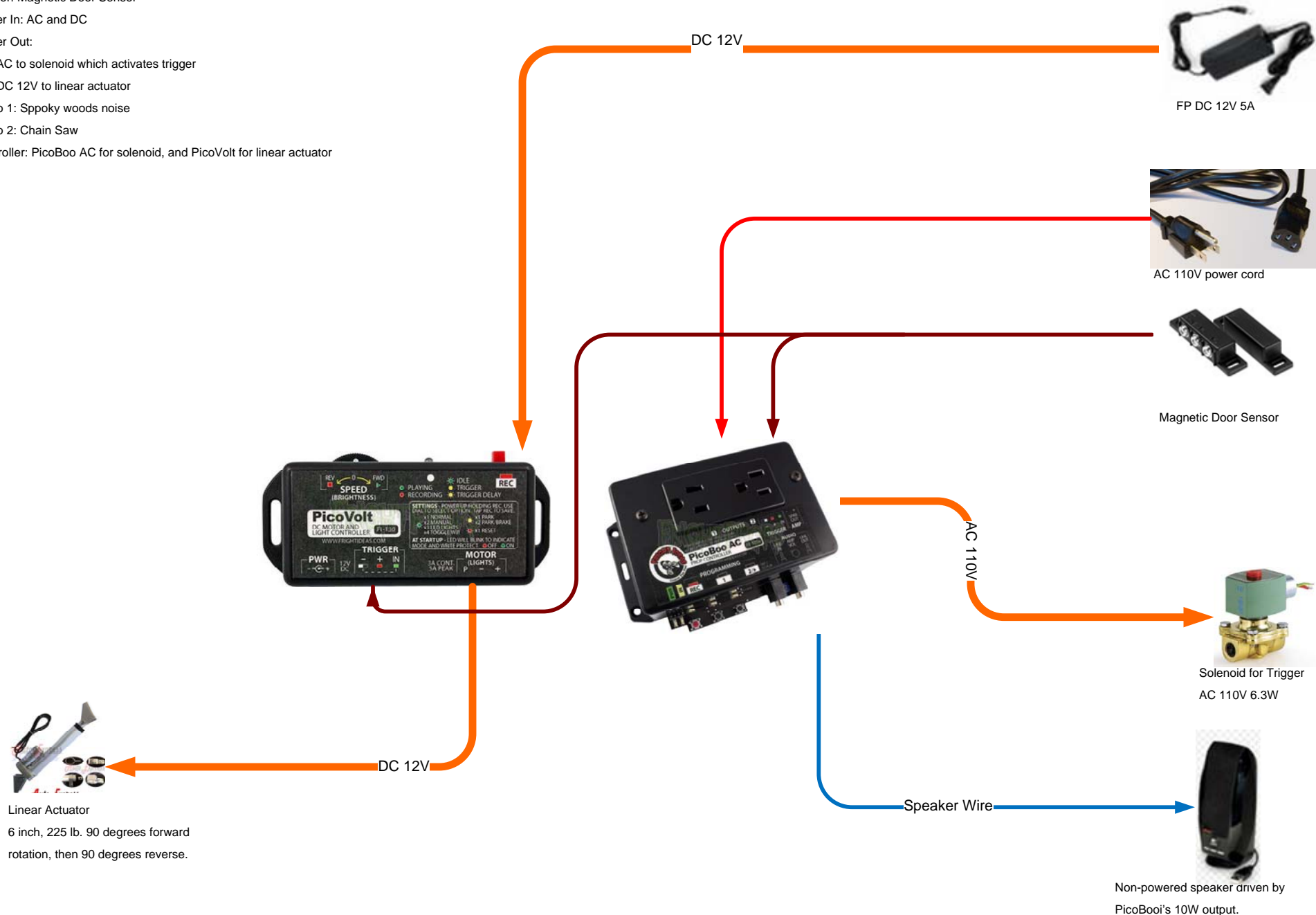

FP DC 12V 5A



AC 110V power cord



Magnetic Door Sensor



Solenoid for Trigger  
AC 110V 6.3W



Non-powered speaker driven by  
PicoBoo's 10W output.



Linear Actuator  
6 inch, 225 lb. 90 degrees forward  
rotation, then 90 degrees reverse.

# Anaconda Head

Anaconda Head

Trigger: Garage Door (Same as Anaconda Tail)

Power In: 12VDC 5A

The 4 Relay Outputs Control these devices:

- 1: DC 12V - Linear Actuator Extend
- 2: DC 12V - Linear Actuator Retract
- 3: AC 110V - Solenoids for fire and water
- 4: AC 110V - Red floodlights (eyes) and Igniters

Ambient Audio: Spooky woods noises: Owls, coyotes, bats, footsteps.

Scare Audio: Loud hissing for 6-12 sec at a time, at 00s, 10s, and 30s.

Controller: PicoBoo Plus



FP DC 12V 5A



Garage Door Sensor (same sensor as Snake Tail)



Non-powered speaker driven by PicoBoo Plus's 30W output.

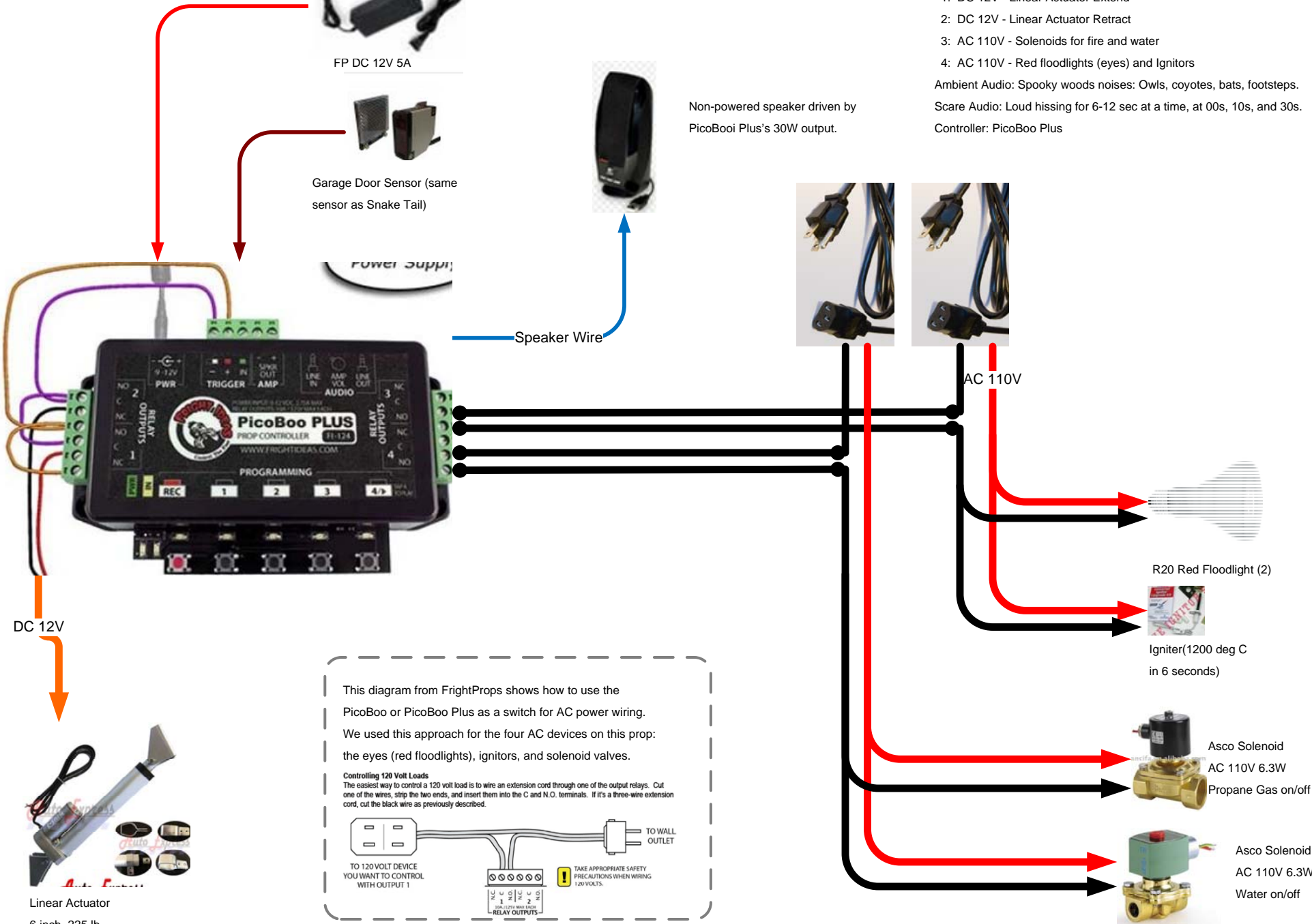

DC 12V



Linear Actuator  
6 inch, 225 lb

This diagram from FrightProps shows how to use the PicoBoo or PicoBoo Plus as a switch for AC power wiring. We used this approach for the four AC devices on this prop: the eyes (red floodlights), igniters, and solenoid valves.

**Controlling 120 Volt Loads**  
The easiest way to control a 120 volt load is to wire an extension cord through one of the output relays. Cut one of the wires, strip the two ends, and insert them into the C and N.O. terminals. If it's a three-wire extension cord, cut the black wire as previously described.

TO 120 VOLT DEVICE YOU WANT TO CONTROL WITH OUTPUT 1

TO WALL OUTLET

! TAKE APPROPRIATE SAFETY PRECAUTIONS WHEN WIRING 120 VOLTS.

AC 110V

R20 Red Floodlight (2)

Igniter(1200 deg C in 6 seconds)

Asco Solenoid  
AC 110V 6.3W  
Propane Gas on/off

Asco Solenoid  
AC 110V 6.3W  
Water on/off

# Anaconda Tail

## Anaconda Tail

Trigger: Beam Sensor (Same as Anaconda Head)

Power In: 10A

Power Out:

- 1: 110VAC to 12VDC Power Supply to motor for lifting mannequin
- 2: flood light for illuminating mannequin

Audio 1 (ambient): Cauldron bubbling, boiling, hissing.

Audio 2 (scare): Girl Screaming

Controller: PicoBoo AC



AC 110V power cord



Beam Sensor. Wiring:  
Trigger Negative: Blue, White  
Trigger Positive: Brown  
In: Black  
(the same sensor also triggers the Anaconda Head)



Non-powered speaker driven by the PicoBoo's 10W output.



0955-LINK-ARM2  
0956-MOT2



FP DC 12V 10A



AC 110V

DC 12V

AC 110V



Amber flood light, on during the lifting cycle.

Stereo speaker wire

