

8' x 8' base

Floor

8'

7'9"

2'9"
from
edge to
center

Floor Joist for Front Wall Support

Floor Joist for Plywood Edge

8'

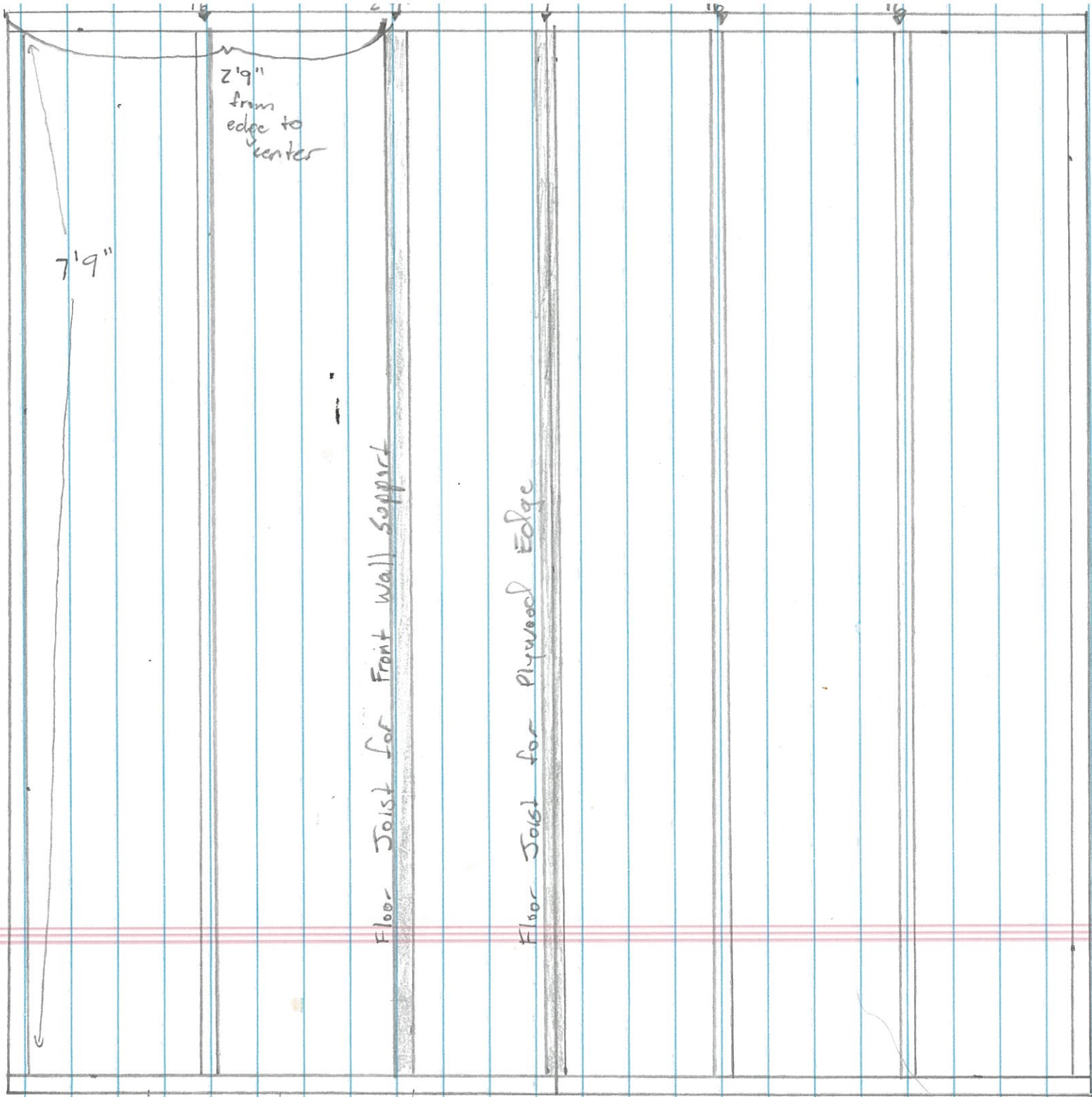

Placement
of wall
frames
on floor

Deck Dimensions
 $8' \times 2'8\frac{1}{2}"$

Interior dimensions
inside studs.
 $7'5" \times 4'8\frac{1}{2}"$

7'5"

5'2 $\frac{1}{2}"$

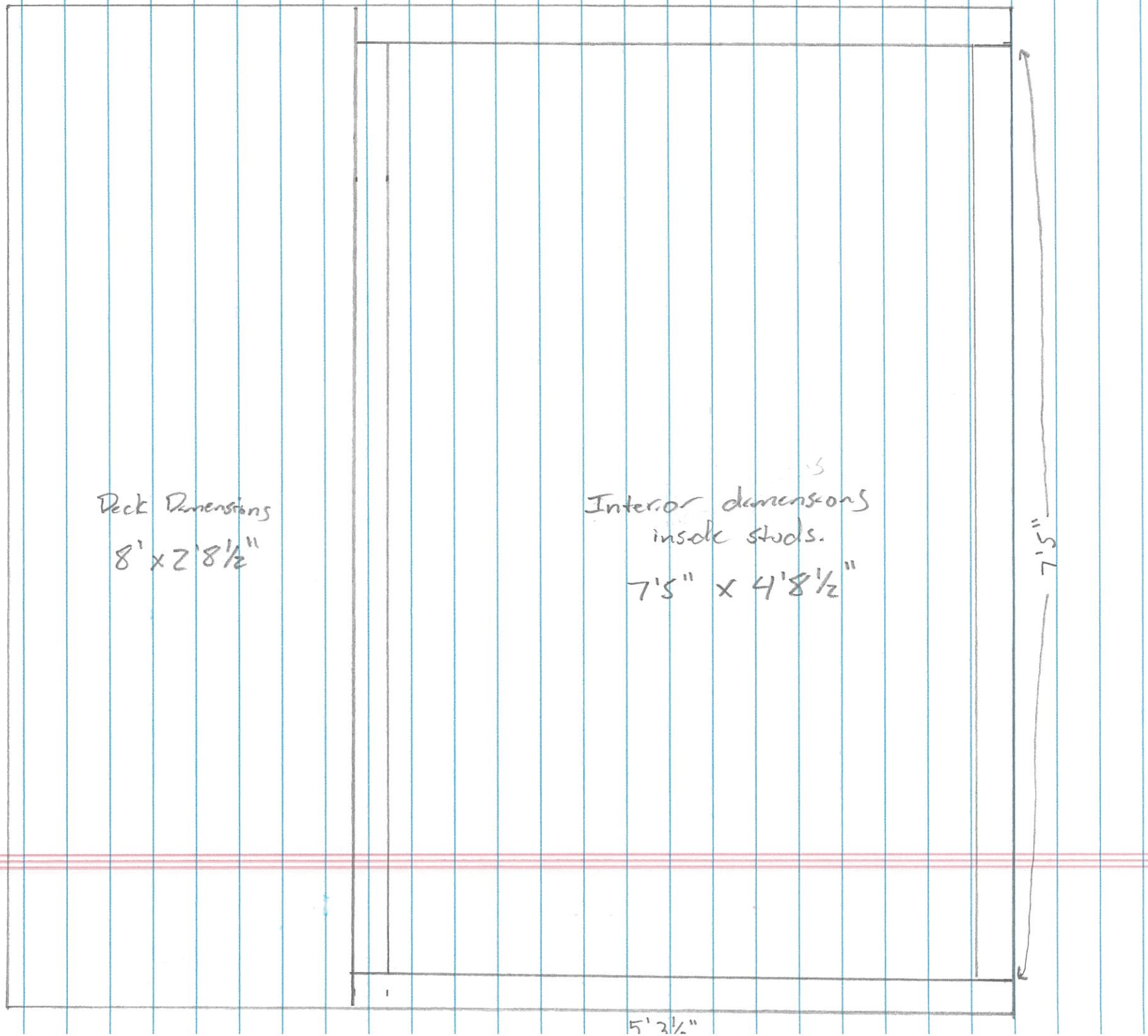

Front

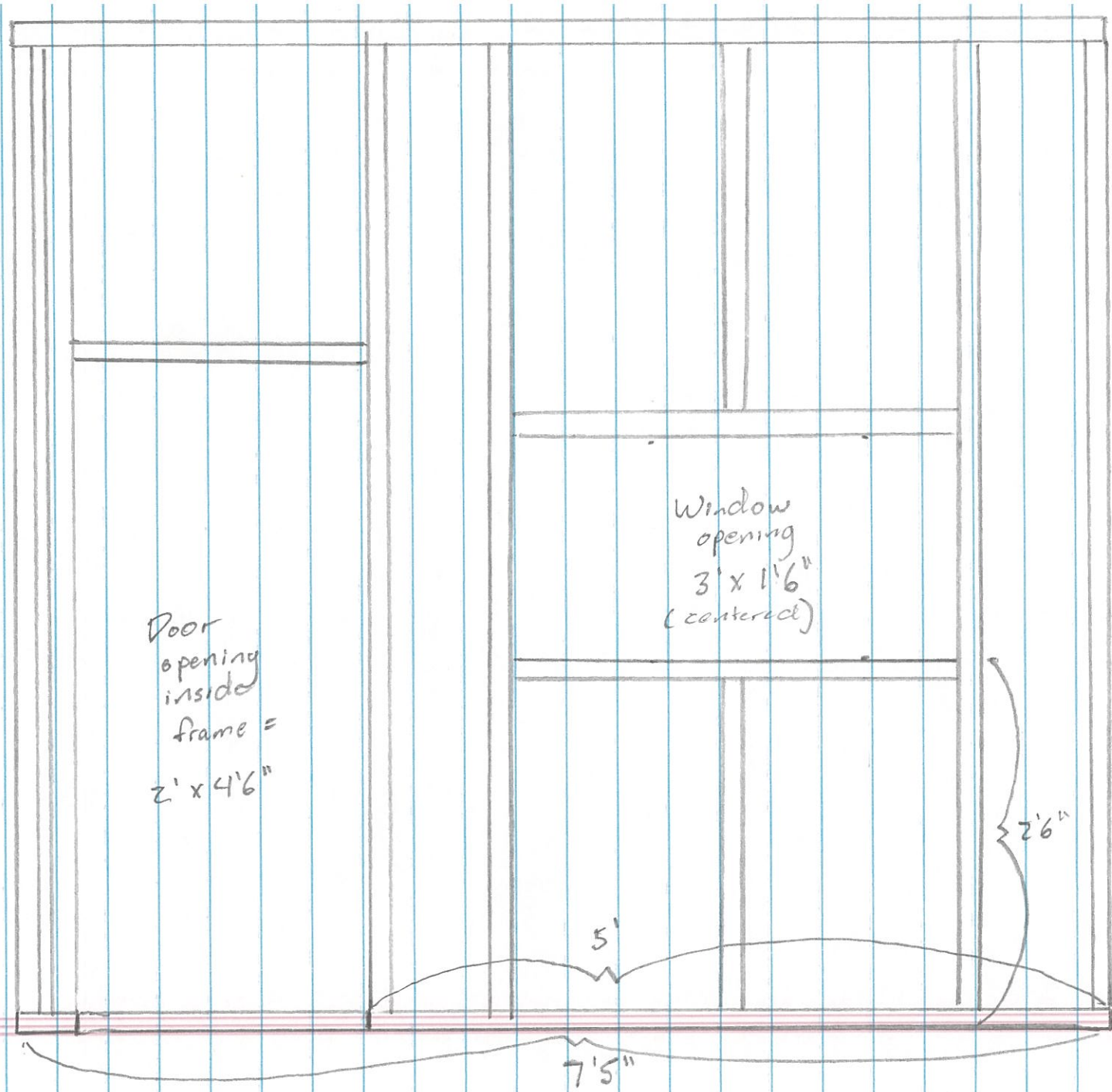

Door opening inside frame = 2' x 4 1/2"

Window opening 3' x 1 1/2" (centered)

6 1/2"

2' 6"

5'

7' 5"

Hello little
How do you get into top of
(How tall?)

Side wall
frame

X Z

stud =
~ 5'

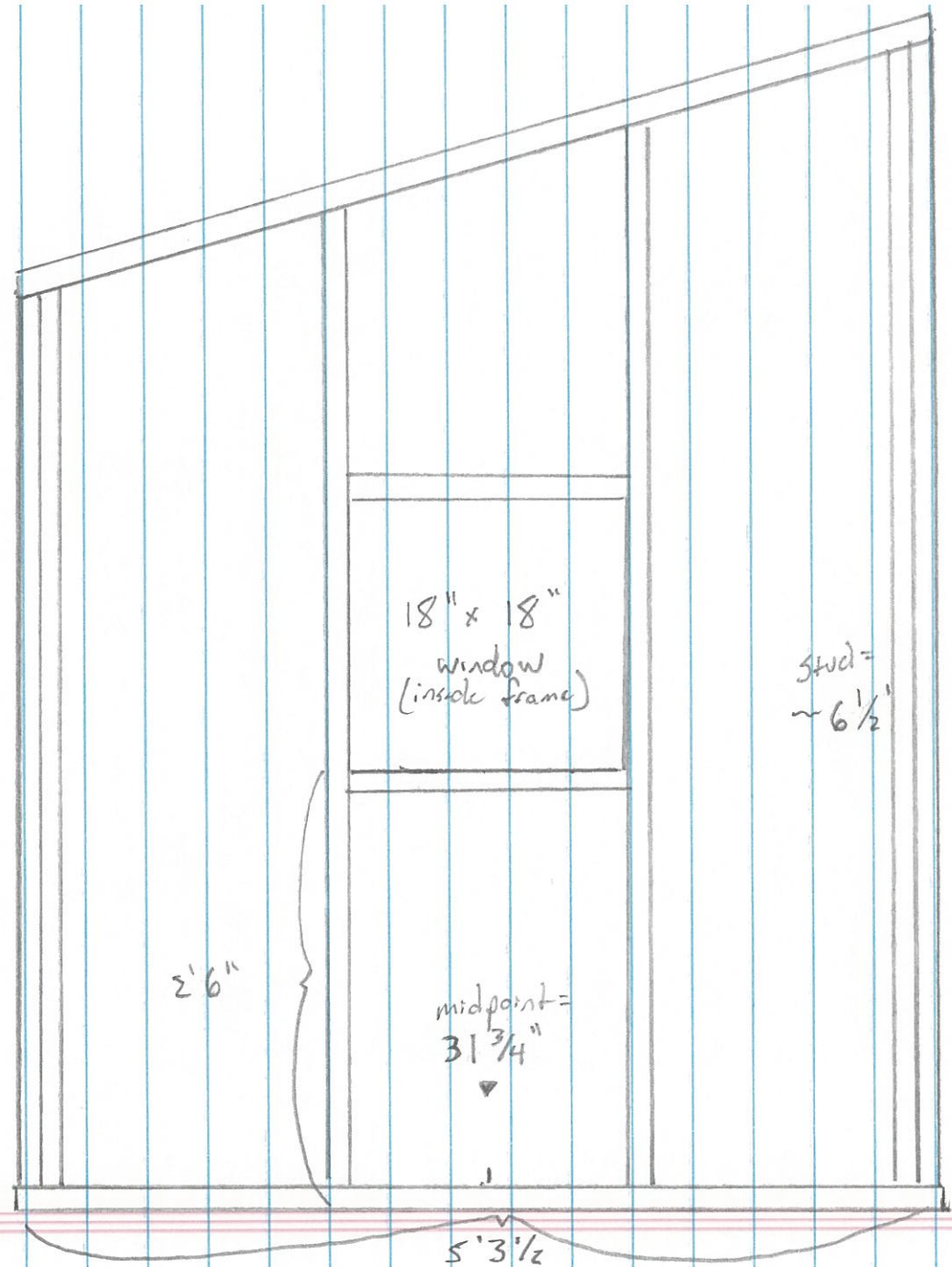

All studs
cut at
an angle at
top.
(along 1 1/2" side)

2'6"

18" x 18"
window
(inside frame)

stud =
~ 6 1/2"

midpoint =
31 3/4"

5'3 1/2"

Back

~5'

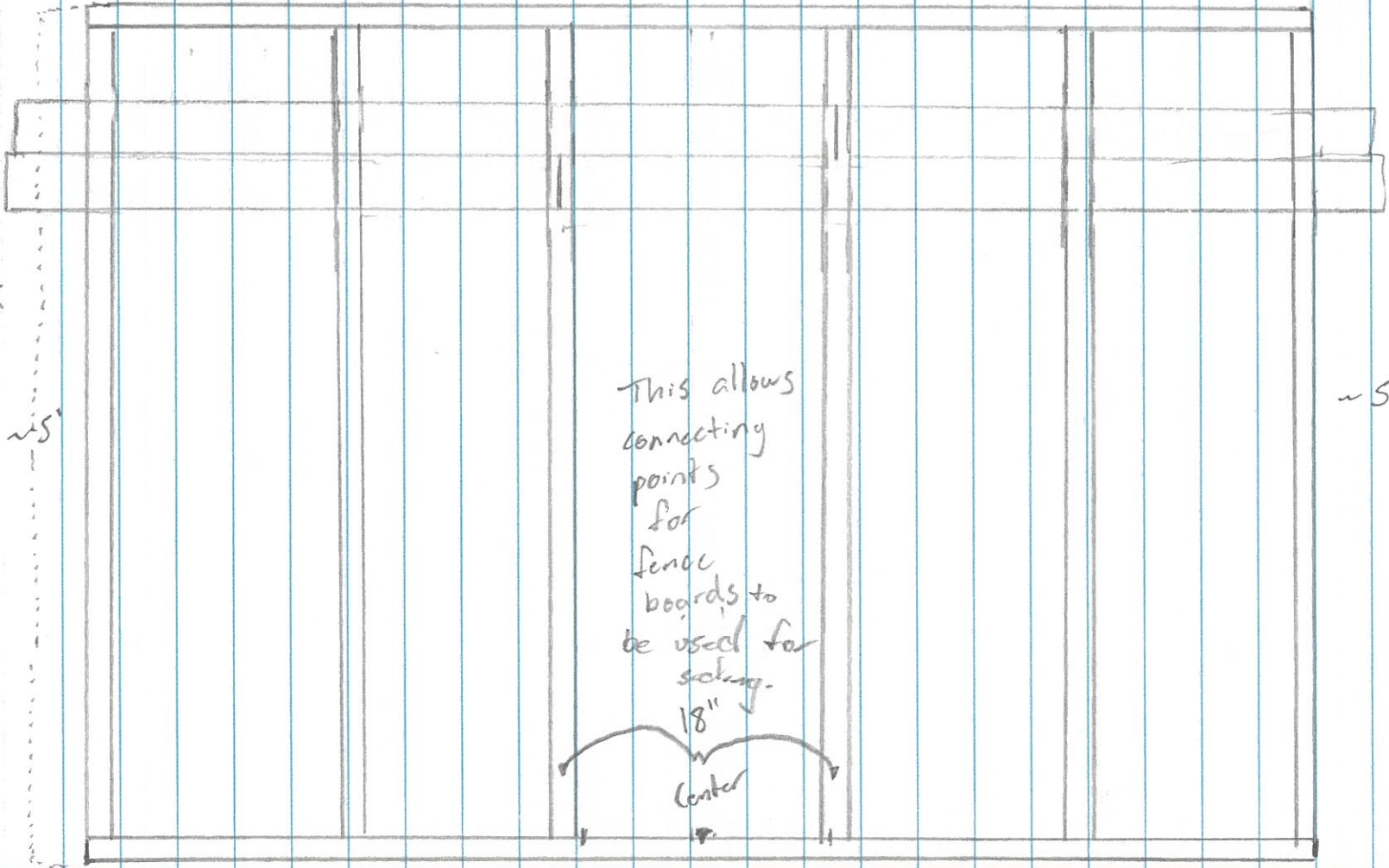

This allows
connecting
points
for
fence
boards to
be used for
seating.

18"
Center

Studs cut
@ angle
(along 3 1/2"
side)

~5'

7'5"

Main
Roof

All
2x4s
laid
flat

1 3/4"
overhang
over
wall
studs

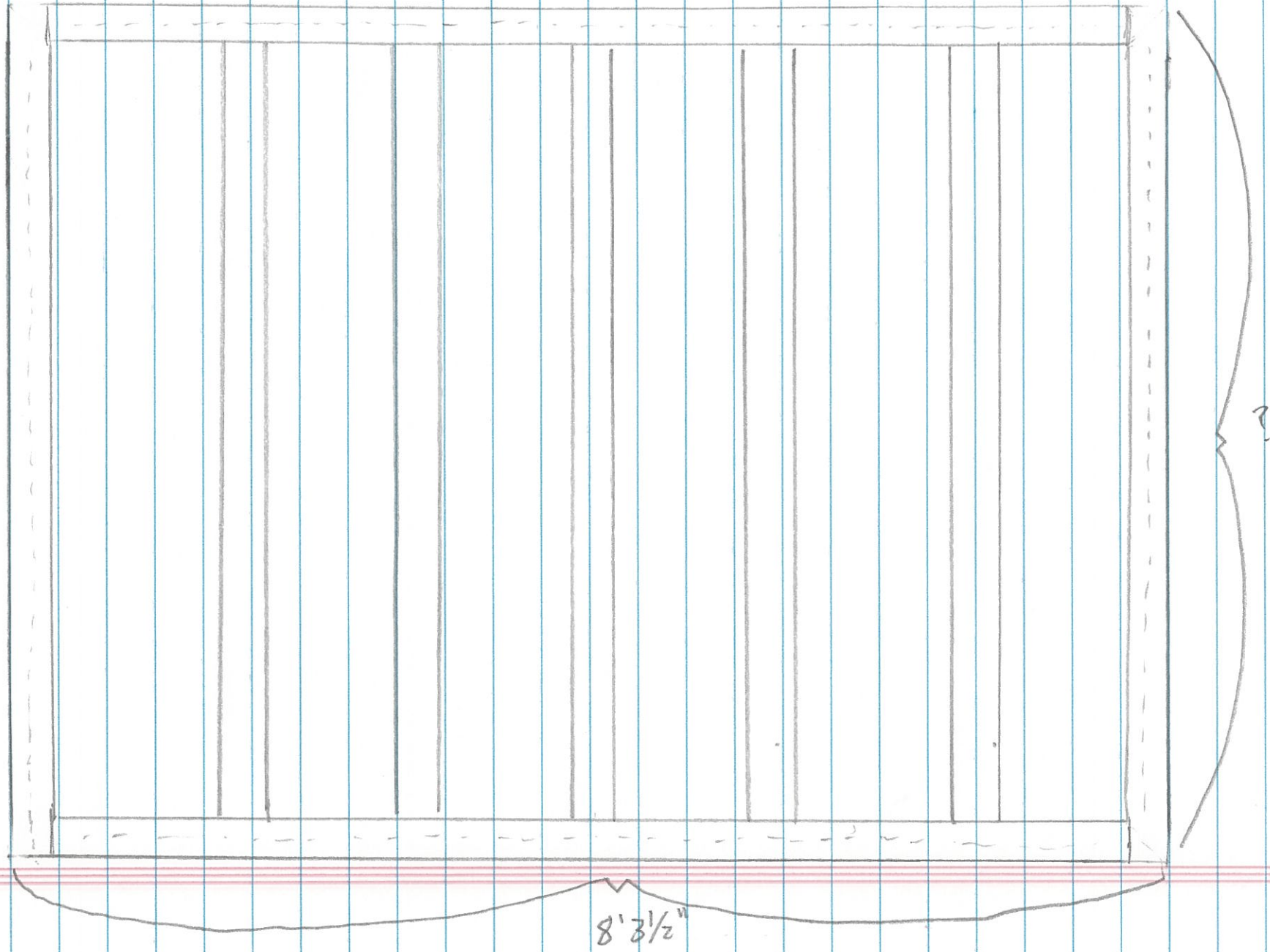

Deck
Cover
Frame

