

Template 2

Neck and Pickup

Router Template

1. Cut on dotted lines and mount paper template to 1/2" MDF.
2. The neck pickup shows 2 lines. The inside line is the actual cut and the outside line is where I had to expand the template to allow for a router bushing. Check dimensions of your router bushing and adjust if needed.
3. Drill out the corners of the pickups and saw between holes.
4. Cut close to the lines but not on them. file and sand to the line for best fit.

Routing

1. Check with your router specs but I used the template as is for the pickup cavities and added a 1/8" spacer under the template for the neck route.
2. I used a 1/4" router bit and router bushing for the pickup cavities and a 1/2" router bit with a bearing for the neck pocket
3. You'll need to route a deeper pocket on the sides of the pickup cavities for the pickup mounting screws. Check their location and route these down to a depth of 1 3/8"

(CUT)

Drill a centerline
peep hole

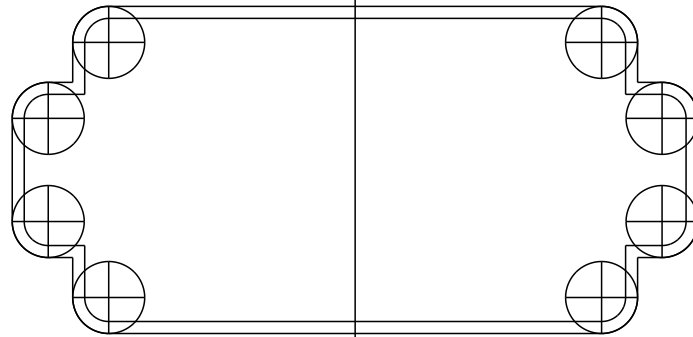

Offset for Router Bearing
if using.

Actual Hole

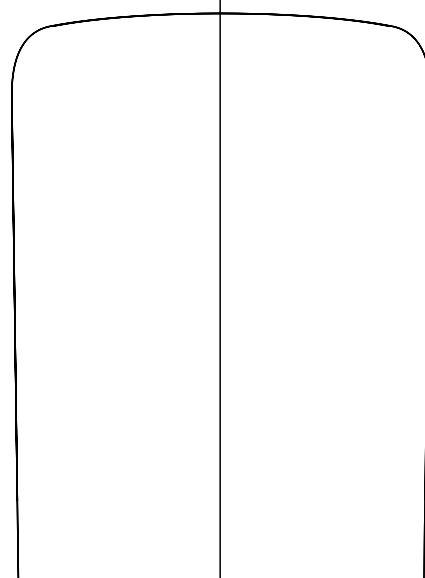
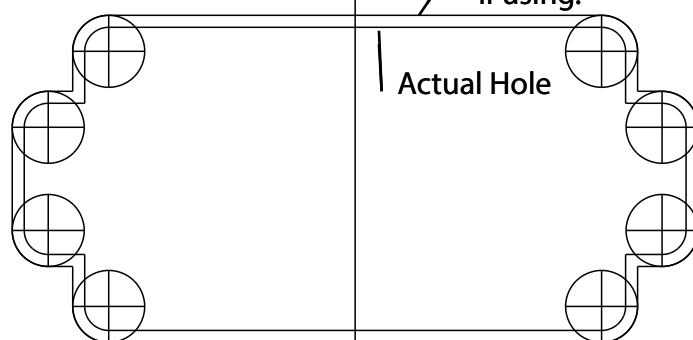

4 Inches