

# SHOEMERANG

Throw this tri-blade, shoemerang and watch it return to your hand!

or alternatively use craft materials:



- ① Place a shoe on a cardboard sheet then trace 3 times

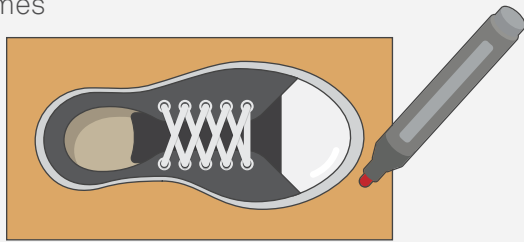

If right-handed, use left shoe   If left-handed, use right shoe  

- ② Cut out 3 cardboard shoe pieces

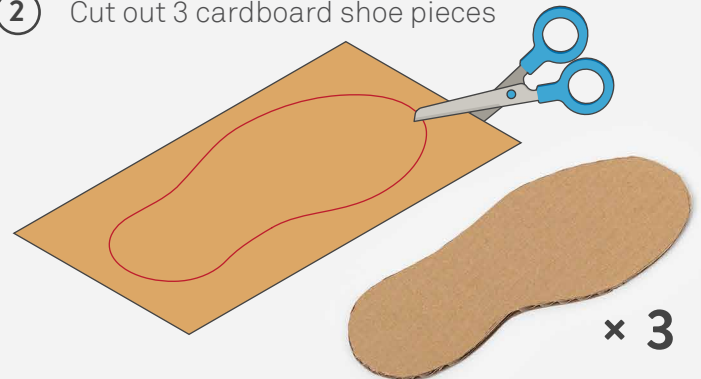

- ③ Fold up the toes then fold down the inside of each shoe



- ④ Punch a hole through the heels, then make a joint to hold together. Spread the cardboard pieces evenly as a tri-blade

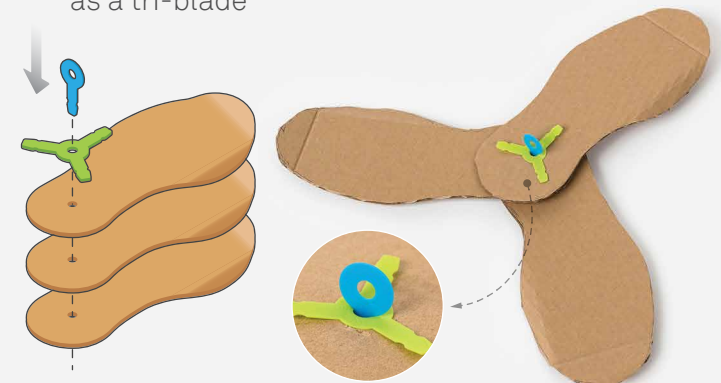

- ⑤ Make a slot next to the joint then slide the 3-leg connector's leg from the backside of the shoemerang

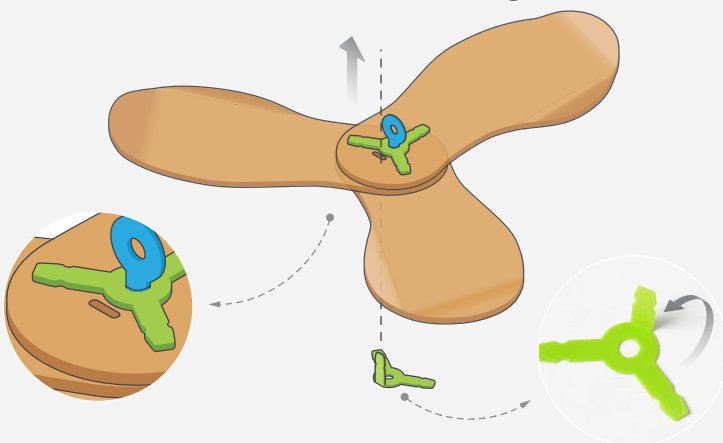

- ⑥ Click the connectors together into locked joint, preventing the blades from shifting during flight. Test your shoemerang!

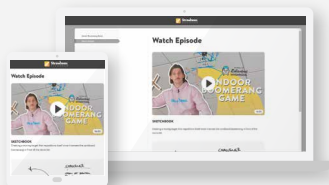
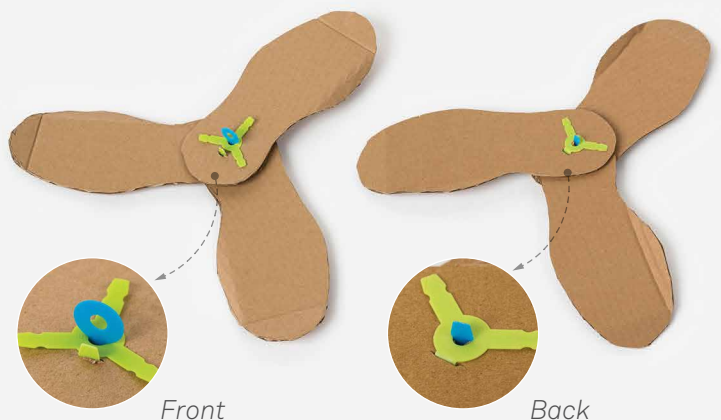

Explore more on Strawbees Classroom

[strawbees.com/shoemerang](http://strawbees.com/shoemerang)



 **Strawbees®**  
CLASSROOM

© Strawbees AB. All rights reserved.