

Hardware:

Here is a list of fasteners and other hardware included with your new mePed. The Servo Screws and Servo Mount Screws referenced in this assembly manual are included with the servos and do not need to be purchased separately.

- 32ea - M3 Nyloc Nut
- 28ea - M3 Hex Nut
- 40ea - M3 x 10mm Screw
- 16ea - M3 x 12mm Screw
- 4ea - M3 x 16mm Screw
- 4ea - Nylon Spacer
- 1ea - Allen Wrench
- 1ea - End Wrench

WARNING:
CHOKING HAZARD - Small parts.
 Not for children under 3 years.

Acrylic Parts :

Before laser cutting the Acrylic was covered with a protective masking tape to prevent it from scratches. You will need to peel the masking tape off each part before assembling the mePed.

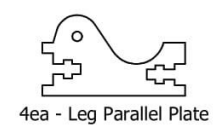
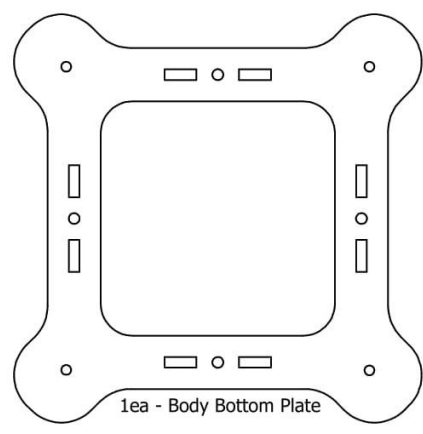
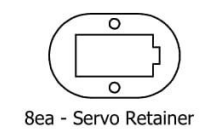
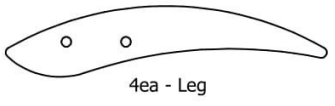
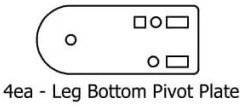
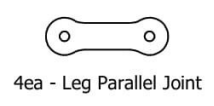
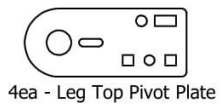
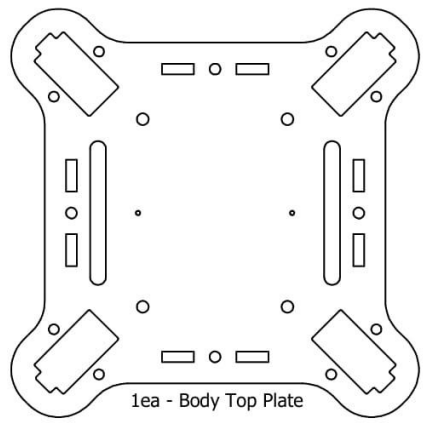

Leg Assembly

Repeat Steps 1-9 four times for each leg.

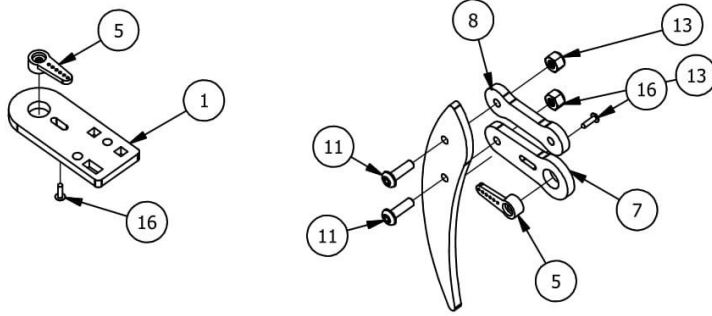

- Step 1: Insert a Servo Single Arm into a Leg Top Pivot Plate and thread a Servo Mount Screw into the Servo Single Arm from the back side of the Leg Top Pivot Plate.
- Step 2: Insert a Servo Single Arm into a Leg Servo Arm and thread a Servo Mount Screw into the Servo Single Arm from the back side of the Leg Servo Arm.
- Step 3: Attach one Leg Parallel Linkage to a Leg piece using an M3 x 10mm Screw and an M3 Nyloc Nut.
- Step 4: Attach the Leg piece to a Leg Servo Arm using an M3 x 10mm Screw and an M3 Nyloc Nut.

IMPORTANT! Do not over tighten the screws in Steps 2 and 3. The Leg joints should move freely to prevent excess friction which could cause the servos to fail.

PARTS LIST	
ITEM	PART NUMBER
1	Leg Top Pivot Plate
2	Leg Bottom Pivot Plate
3	Leg Servo Mount
4	Servo Screw
5	Servo Single Arm
6	Servo
7	Leg Servo Arm
8	Leg Parallel Linkage
10	Leg Parallel Plate
11	M3 x 10mm Screw
12	M3 Plain Nut
13	M3 Nyloc Nut
14	M3 x 12mm Screw
15	Servo Retainer
16	Servo Mount Screw
17	Leg, Rev A

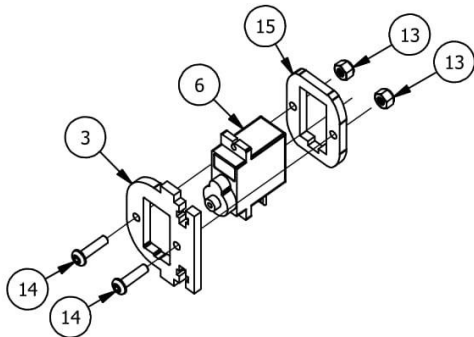

- Step 5: Insert a Servo into a Servo Retainer.
- Step 6: Insert the top end of the Servo into the Leg Servo Mount.
- Step 7: Attach the Servo Retainer to the Leg Servo Mount using two M3 x 12mm Screws and two M3 Nyloc Nuts.

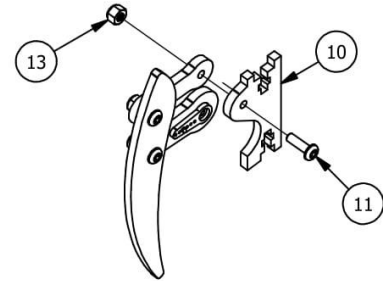

- Step 8: Attach a Leg Parallel Plate to the other end of the Leg Parallel Linkage using an M3 x 10mm Screw and an M3 Nyloc Nut.
- IMPORTANT!** Do not over tighten this screw. The leg joints should move freely to prevent excess friction which could cause the servos to fail.

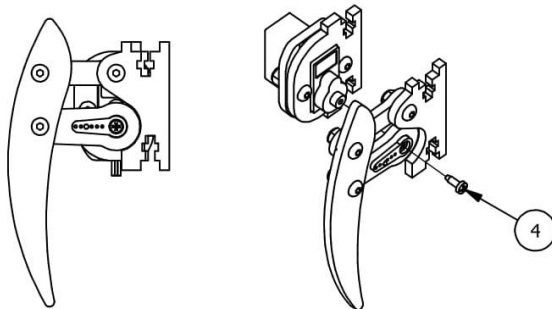

- Step 9: With the Servo rotated to center position and the leg positioned so the Parallel Linkage is horizontal, attach the Leg Servo Arm to the Servo using the Servo Arm Screw supplied with the Servo.

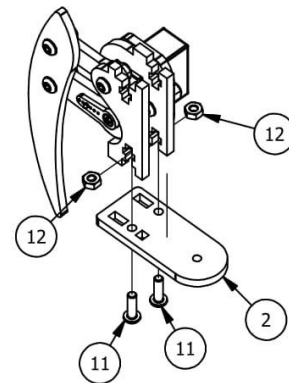

- Step 10: Attach the Leg Assembly from the previous steps to a Leg Bottom Pivot Plate using two M3 x 10mm Screws and two M3 Plain Nuts.

Body Assembly

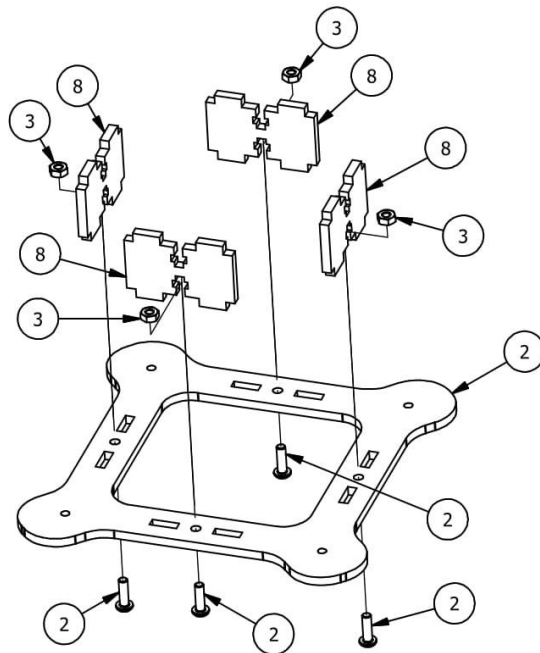

PARTS LIST	
ITEM	PART NUMBER
1	Body Top Plate
1	Servo Screw
3	9 Gram Servo
2	M3 x 10mm Screw
3	M3 Plain Nut
4	M3 Nyloc Nut
7	M3 x 12mm Screw
8	Body Spacer
9	Leg Servo Mount
10	Servo Retainer
20	Leg, Rev A

Step 11: Attach four Body Spacers to the Body Bottom Plate using four M3 x 10mm Screws and four M3 Plain Nuts.

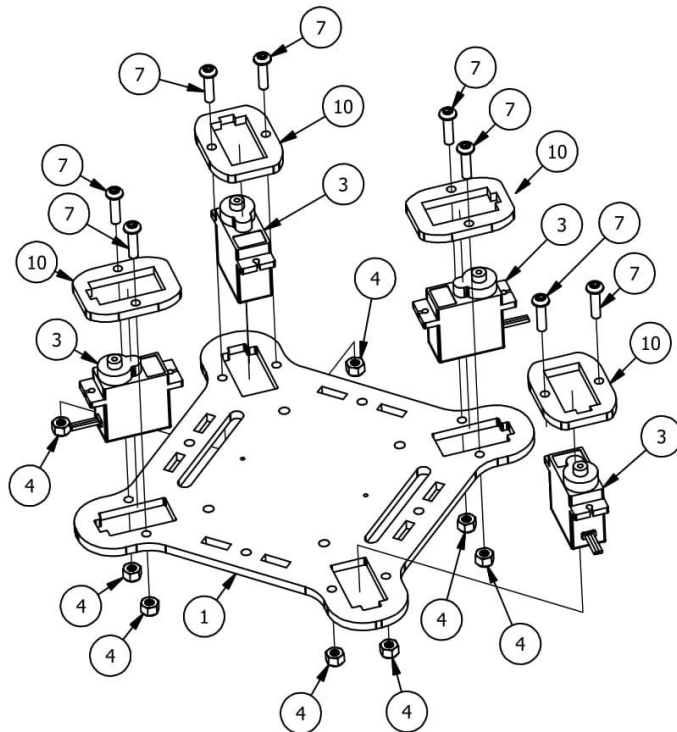

Step 12: Insert four Servos into the top side of the Body Top Plate.
 Step 13: Slide a Servo Retainer onto the top of each Servo.
 Step 14: Attach each Servo Retainer to the Body Top Plate using M3 x 12mm Screws and M3 Nyloc Nuts.

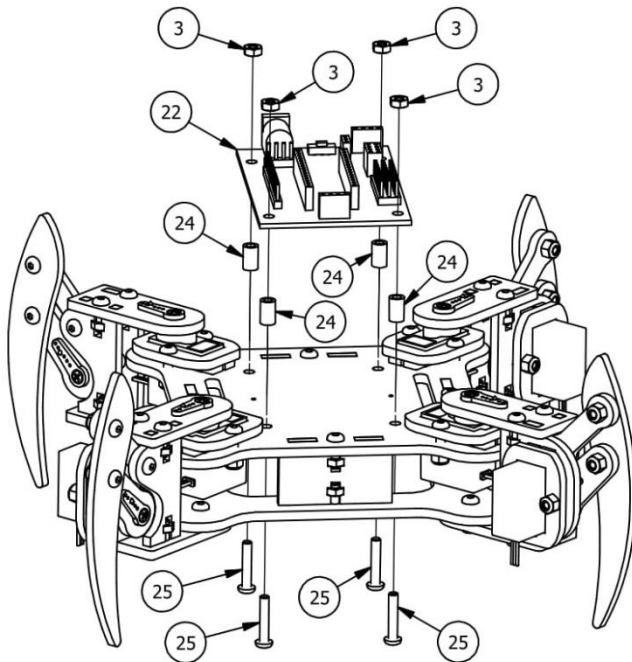

PARTS LIST	
ITEM	PART NUMBER
3	M3 Plain Nut
19	Servo Mount Screw
21	Battery Holder
22	mePed Circuit Board
24	Spacer, M3 x 8mm
25	M3 x 16mm Screw
26	Battery Tray Spacer

Step 19: Attach the mePed Circuit Board to the Body Top Plate using four M3 x 16mm Screws, four M3 x 8mm Spacers, and four M3 Plain Nuts.

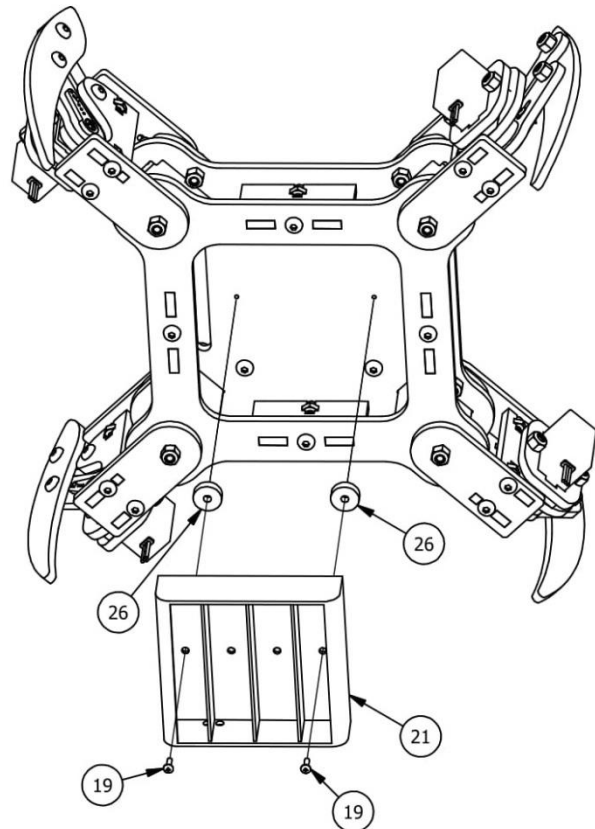

Step 20: Attach the Battery Holder to the bottom of the Body Top Plate using two Servo Screws and two Battery Holder Spacers. Feed the battery cable through the back of the mePed body and plug it into the match power socket on the mePed circuit board.