

makedo™

Shadow Puppet Theatre

Join us as we embark on an unforgettable Star Wars journey all in this very cool R2D2 styled Shadow Puppet Theatre. Turn out the lights and cross into the dark side with Darth Vader; have your own lightsaber battle or seek out Yoda to start that all important Jedi training.

To make a Shadow Puppet Theatre all you need is a large box as the base, a flashlight, and other reclaimed materials for decorative features. To make our R2D2 theatre we used the following reclaimed materials along with Makedo parts available at mymakedo.com.

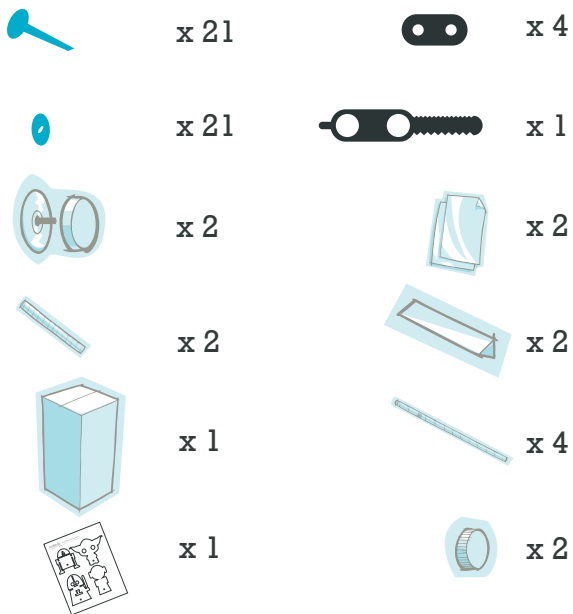

· Find · Punch · Connect ·



1 To create the form of R2D2, use the Makedo Safe-saw and cut a semicircle on the front and back flaps of the box. The side flaps of the box won't be used in this project so they can be removed.



2 For the stage of the theatre, cut a rectangular window on the front of the box with a split in the middle. This will become the doors that open during puppet performances. Cut the swinging door and lock it open using Makedo Hinges, Re-pins and Re-clips.



3 Create R2D2's eye lens by cutting a circular window in the top section. Connect transparent paper internally to cover the cut out window and eye lens using Makedo Re-pins and Re-clips. We have used baking paper to cover the windows which works a treat.

· Punch · Connect ·



4 To cap off the head of R2D2, connect a piece of cardboard using Makedo Re-pins and Re-clips to either side of the box. The cardboard should curve and sit over the semicircle.



5 To create a backstage for the theatre, simply cut out a rectangle on the rear of the box. This is where the performer will control the puppets from. Cut out a circle above your rectangle window. We will place the flashlight here in the final step.

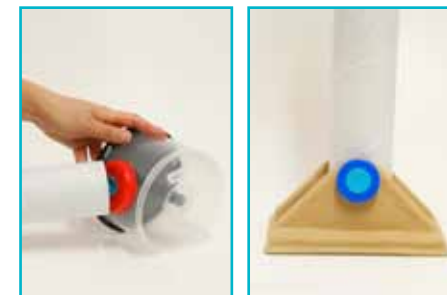

6 Now for the legs. Use the Makedo Safe-saw and punch a hole on the side of the CD container. Connect the postal tube to the CD container with a Makedo Re-pin and Re-clip. Connect the paper pulp tray to the postal tube to create the foot.

· Connect · Sketch · Share ·



7 Attach a leg to each side of your R2D2 Puppet Theatre.



8 Here is the fun part! Decorate the front of R2D2 to give him that distinctive droid look. You can also decorate R2D2 using other reclaimed materials, attaching them to his body.



9 Finally, cut characters out of thick card using the supplied template. Connect them to a drinking straw with Makedo Re-pins and Re-clips. Now you are ready for your first show! Place a flashlight in the hole at the back and project onto the baking paper to begin your Shadow Puppet Show.



-----Cut along dotted lines



● Punch a hole through big dots

