

8

7

6

5

4

3

2

1

D

D

C

C

B

B

A

A

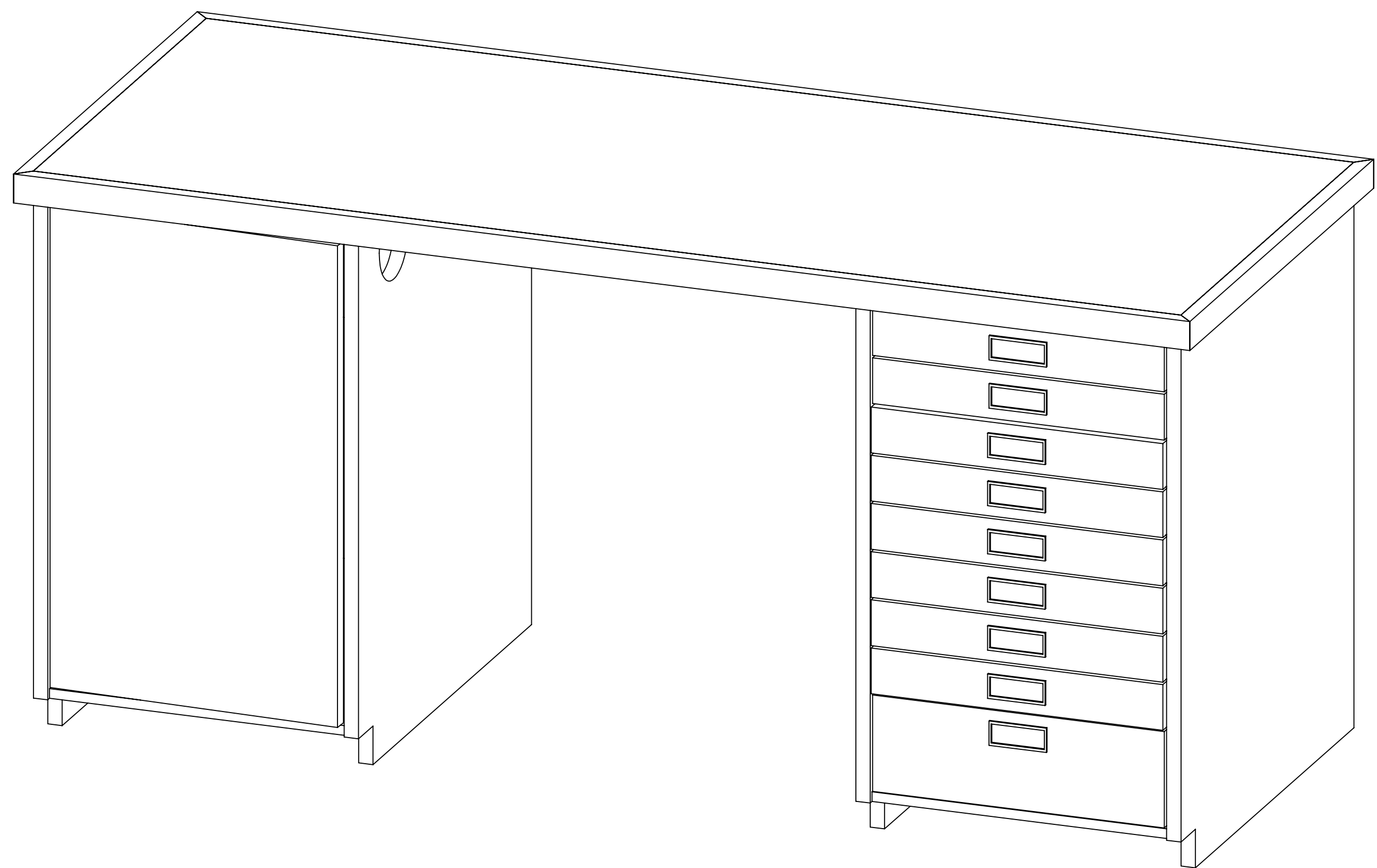

DESK COMPUTER
 DIMETRIC VIEW
 FOR REFERENCE ONLY

5

4

3

2

1

ALL DIMENSIONS ON THIS DRAWING ARE SUBJECT TO CHANGE WITHOUT NOTICE IN ORDER TO COMPENSATE FOR SCREW UPS IN BUILD PROCESS. IT IS NOT THE RESPONSIBILITY OF HSBS DESIGN GROUP TO UPDATE DRAWING AFTER BUILD.

	NAME	DATE
DRAWN	KEVIN R. LAGE	2018/07/06
DESIGNED	KEVIN R. LAGE	2018/07/01
BUILT	KEVIN R. LAGE	2018/07/01

TITLE:		WALNUT DESK COMPUTER	
SIZE	D	H.S.B.S DESIGN GROUP	
SCALE:	1:5	WEIGHT:	N/A
		SHEET 1 OF 16	

8

7

6

5

4

3

2

1

D

D

C

C

B

B

A

A

DRAWER SIDE

DRAWER SIDE

OUTER LEG, RIGHT

DESK TOP

BEARING WALL, RIGHT

SHELF/BOTTOM

SHELF/BOTTOM

ELECTRONICS CABINET

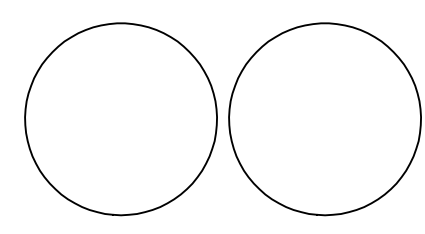

PLYWOOD SHEET 1
BREAK DOWN

8

7

6

5

4

3

2

1

8

7

6

5

4

3

2

1

D

D

C

C

B

B

A

A

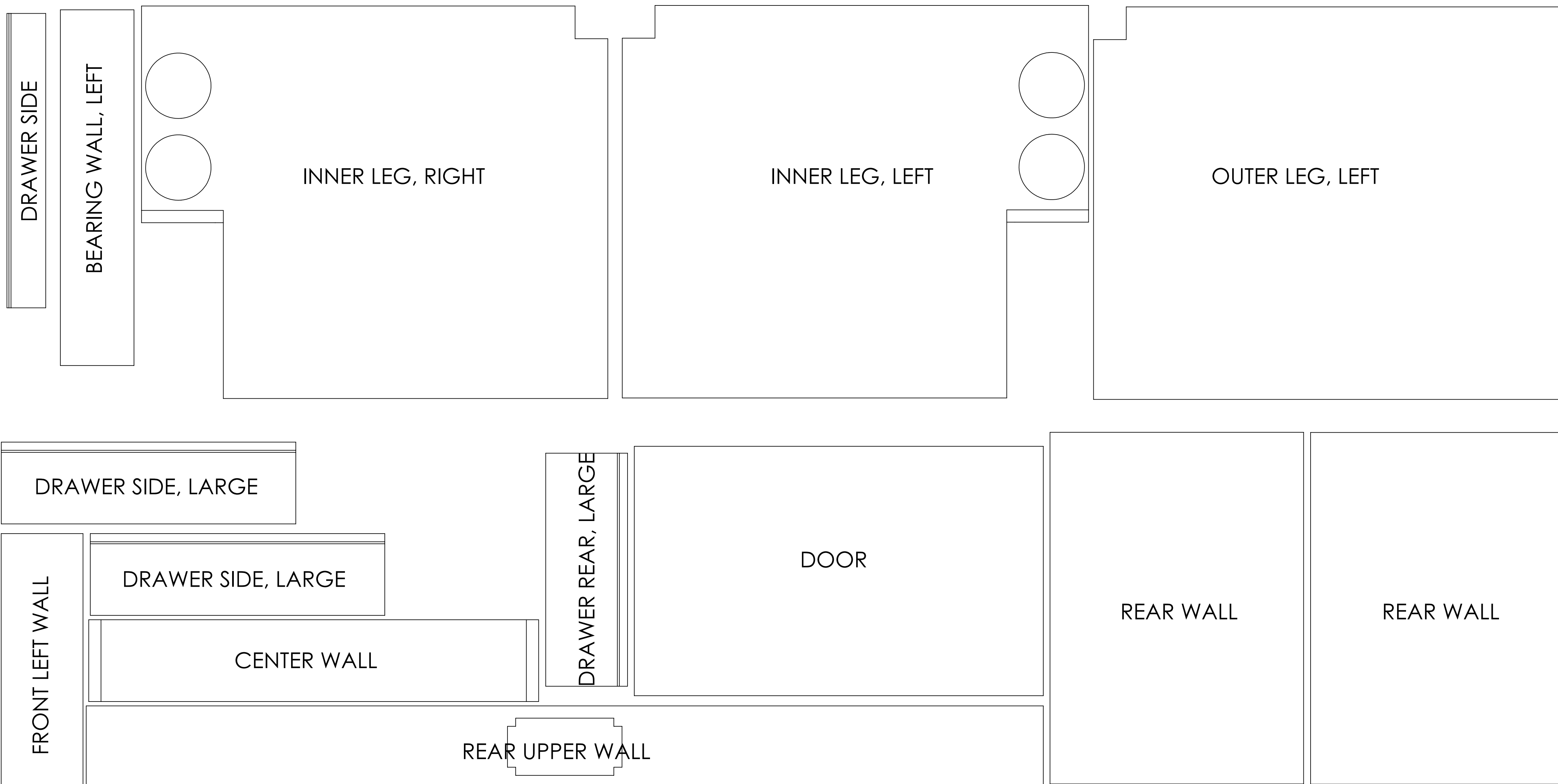

8

7

6

5

4

3

2

1

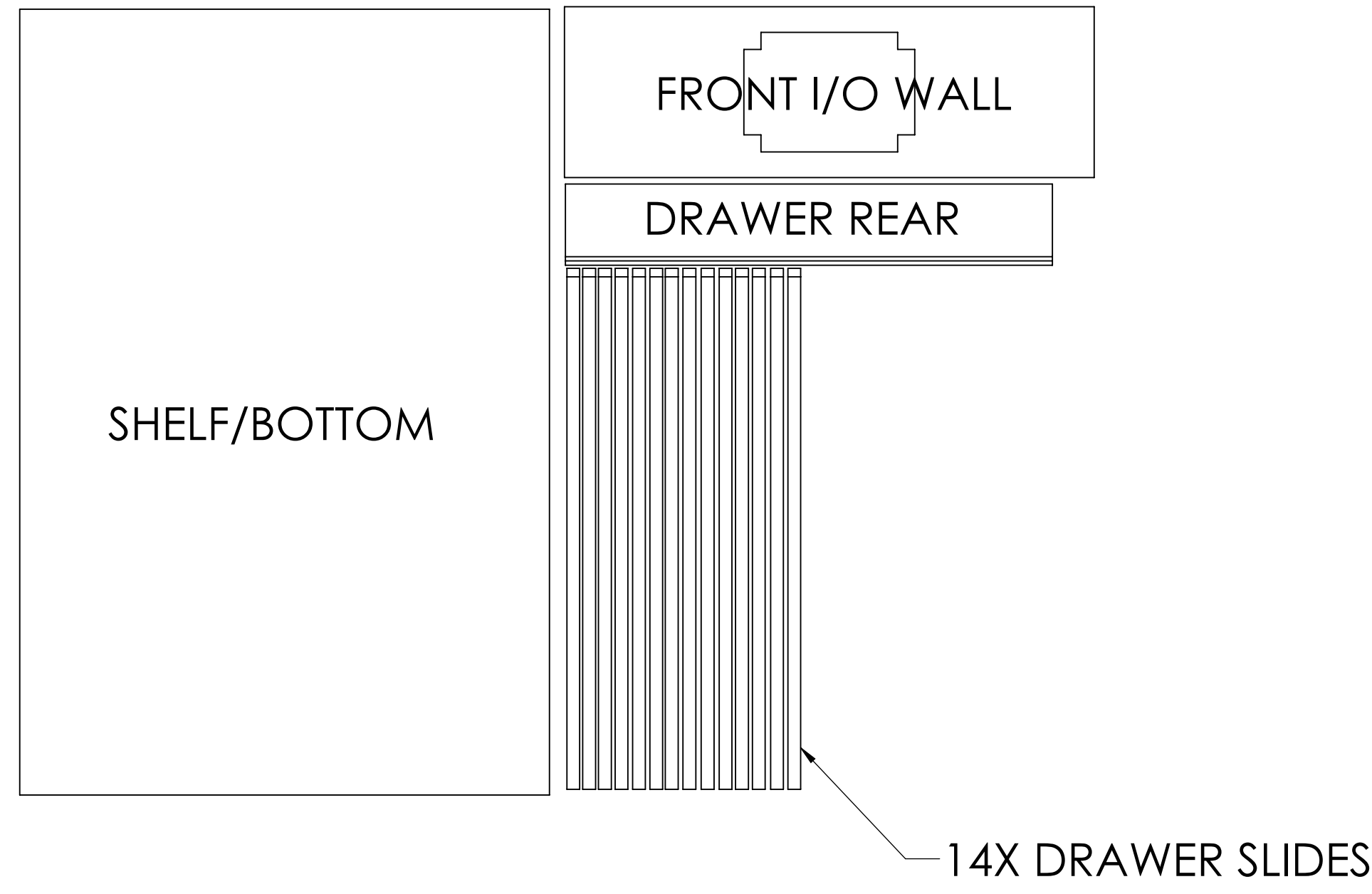
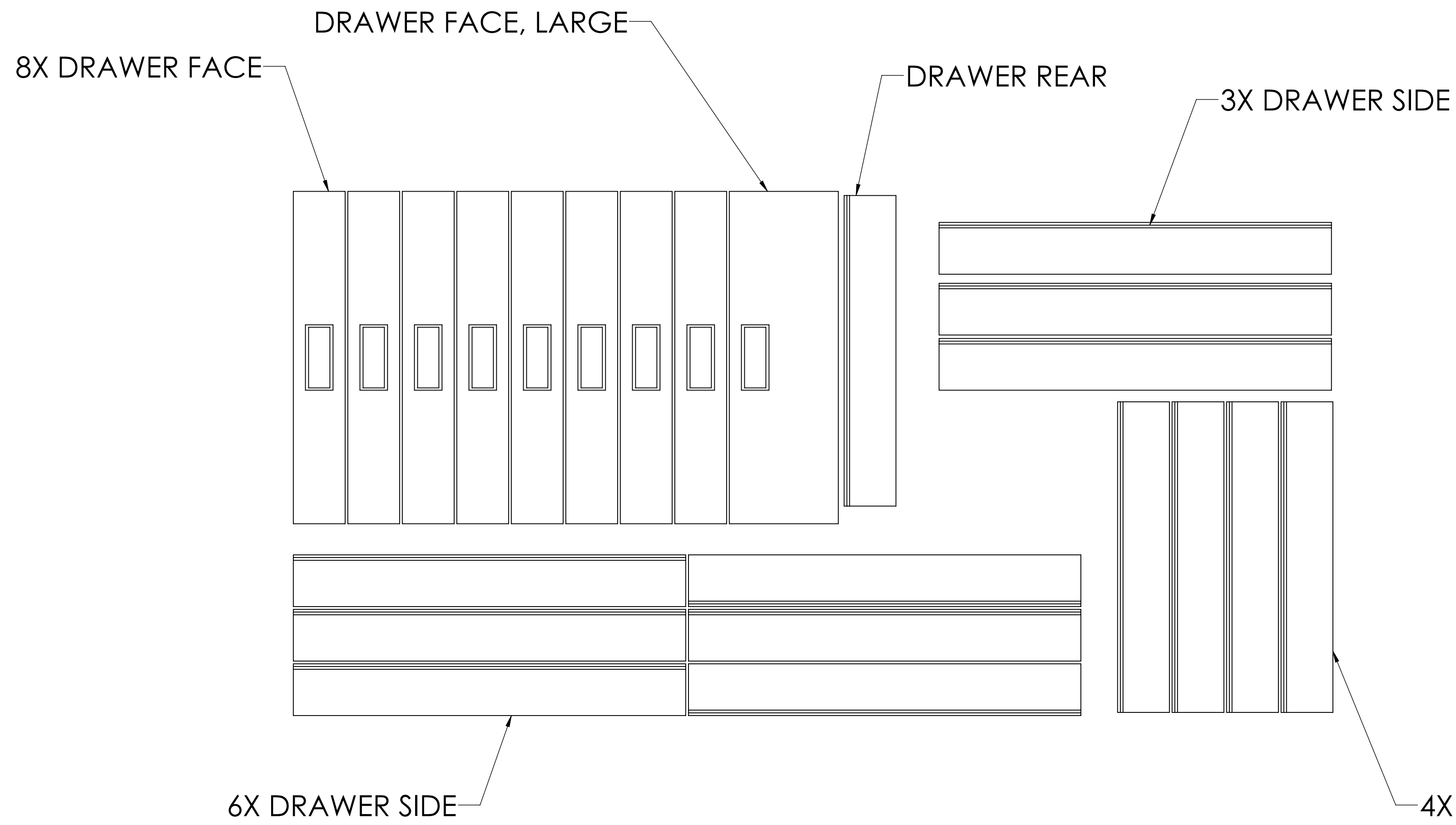

PLYWOOD SHEET 3
BREAK DOWN

8

7

6

5

4

3

2

1

8

7

6

5

4

3

2

1

D

D

C

C

B

B

A

A

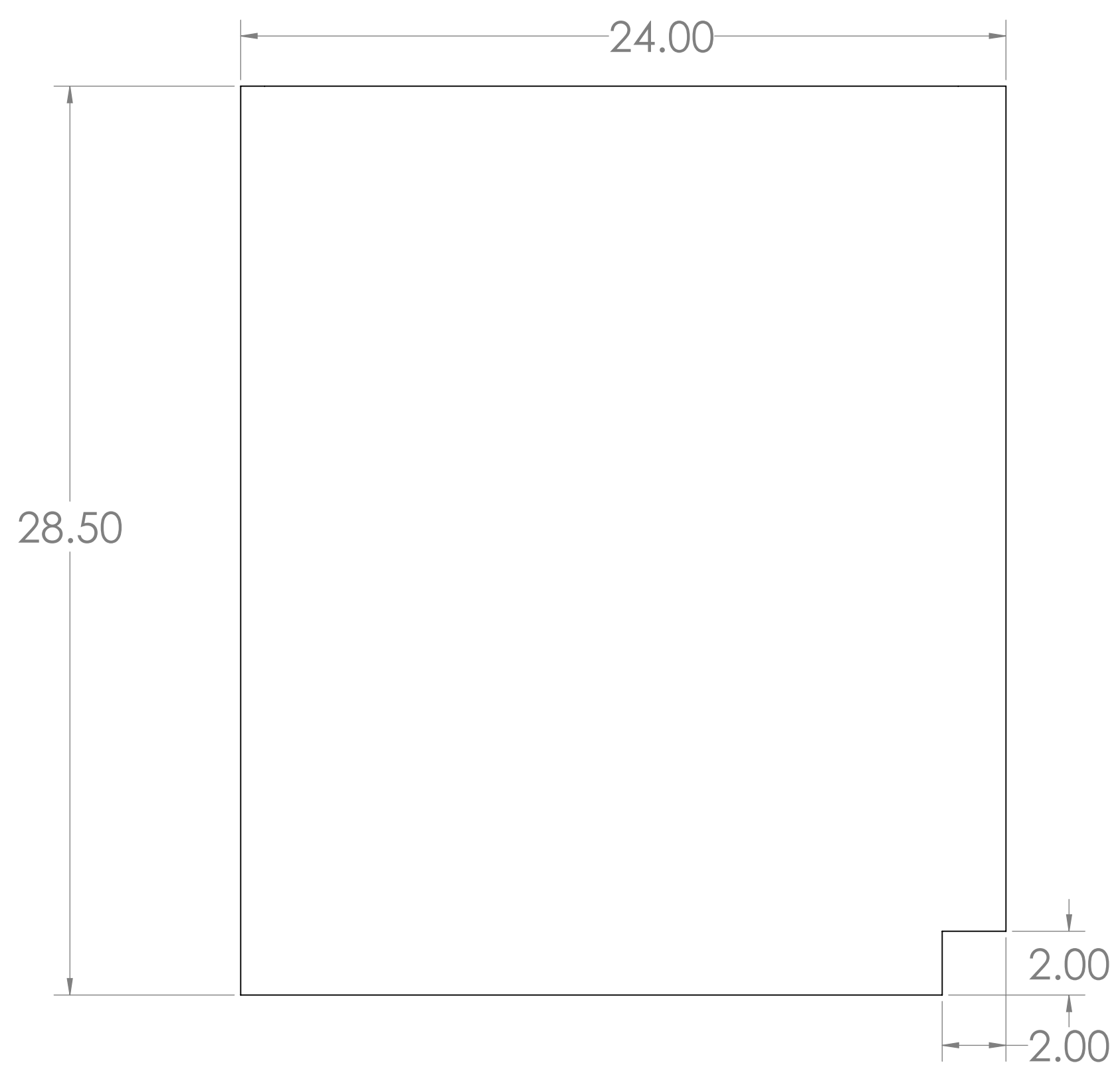

OUTER LEG, RIGHT SHOWN
OUTER LEG, LEFT SIMILAR

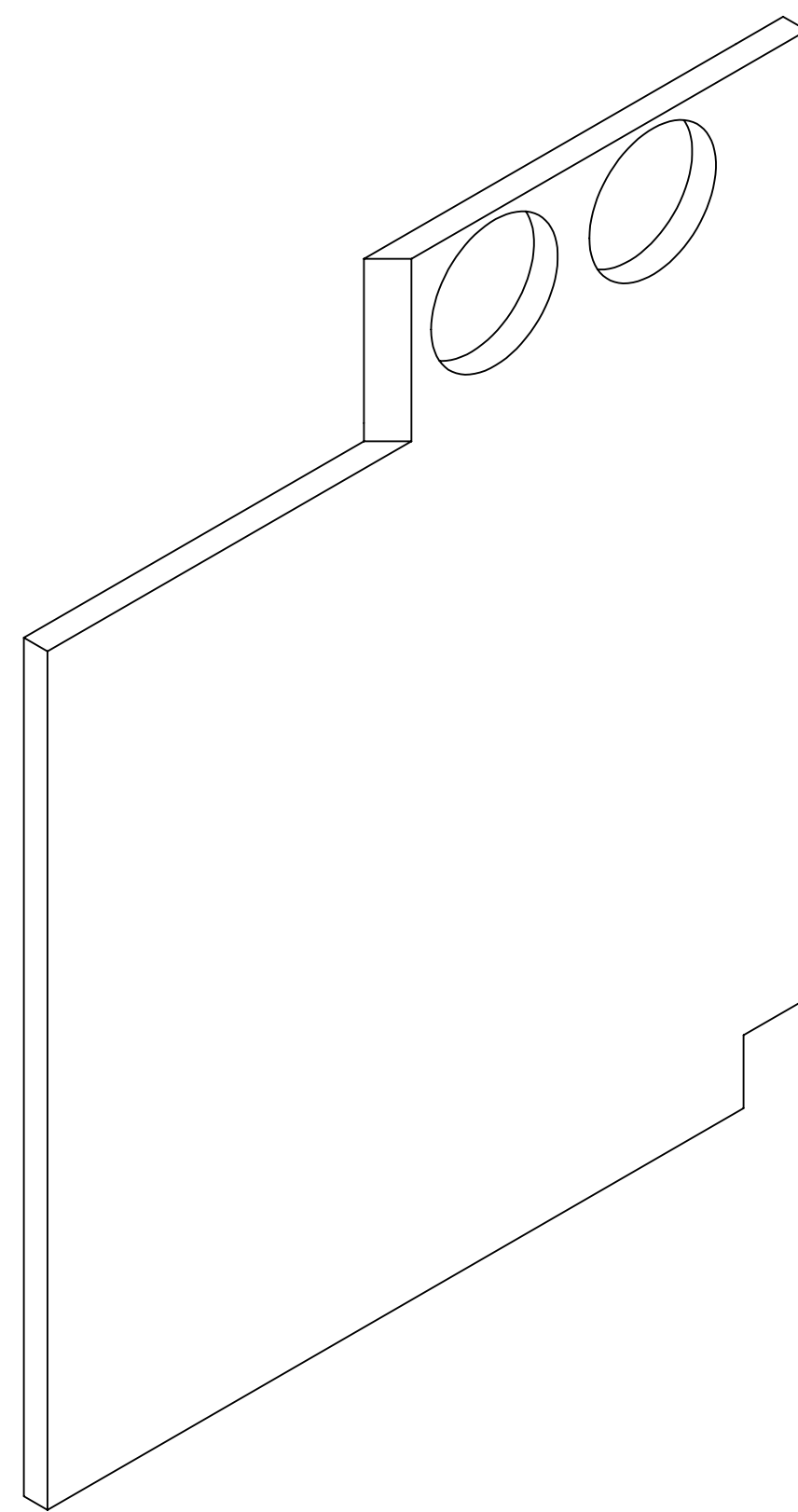

INNER LEG, RIGHT
ISOMETRIC VIEW
INNER LEG, LEFT MIRRORED

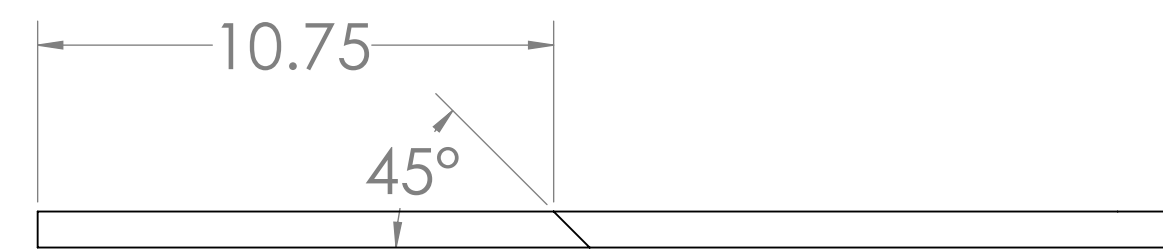

INNER LEG, RIGHT
TOP VIEW
MIRROR CUT FOR INNER LEG, LEFT

CUT WITH JIG SAW SET
TO 45 DEG

DO NOT CUT
UNTL FINAL ASSEMBLY

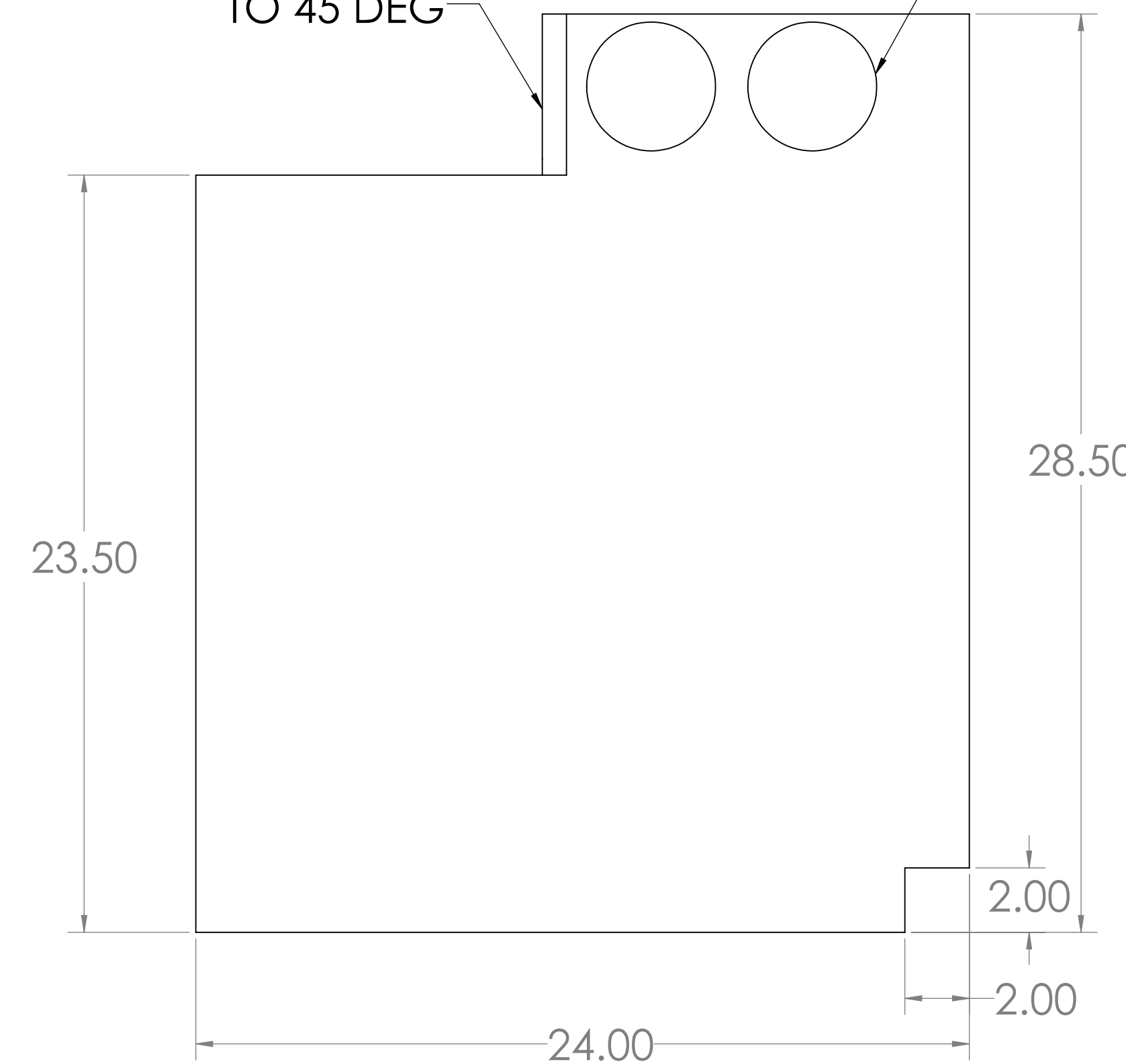

INNER LEG, RIGHT
FRONT VIEW
INNER LEG, LEFT SIMILAR EXCEPT FOR MIRRORED ANGLED CUT

8

7

6

5

4

3

2

1

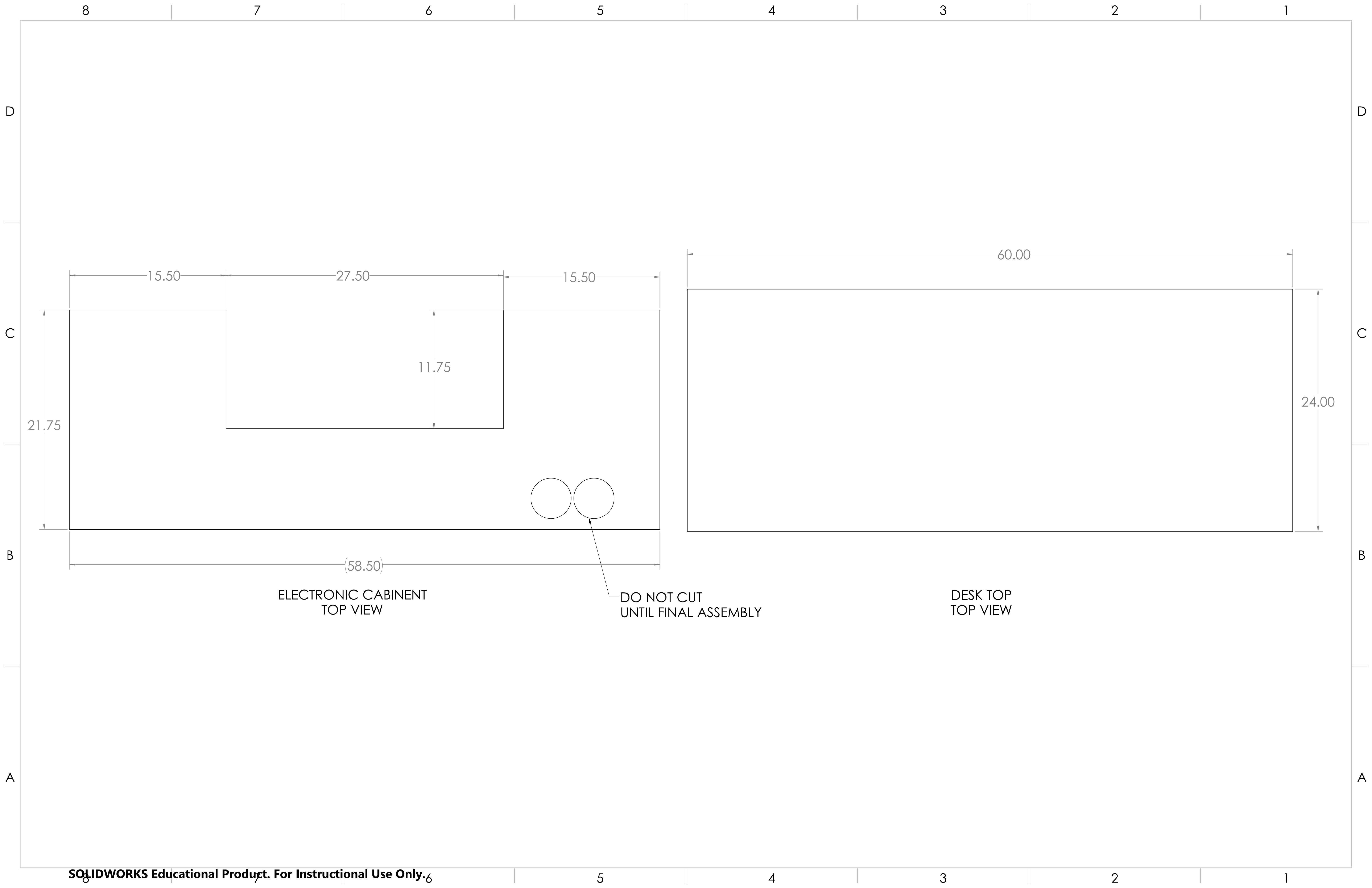

8 7 6 5 4 3 2 1



BEARING WALL, RIGHT
BEARING WALL-LEFT SIMILAR



CENTER WALL

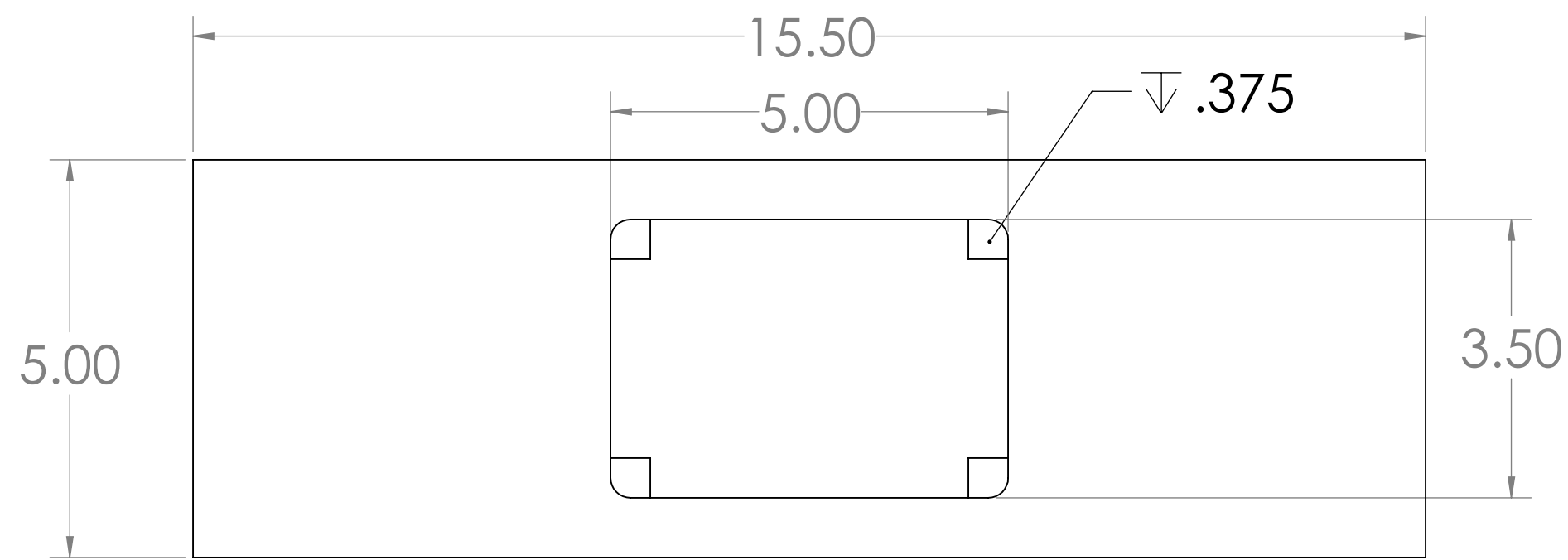
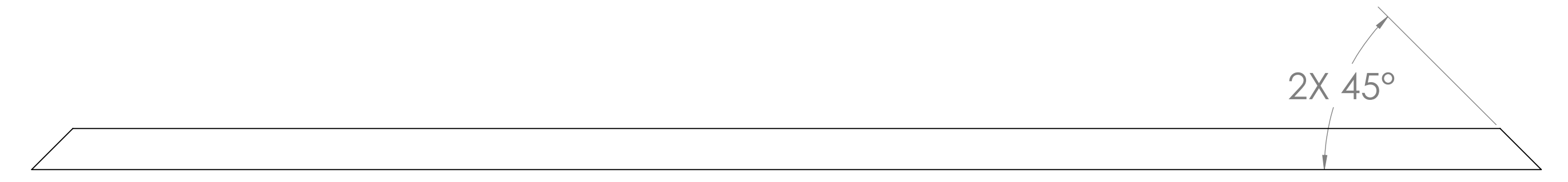

I/O WALL
FRONT LEFT WALL SIMILAR EXCEPT CENTER DETAIL

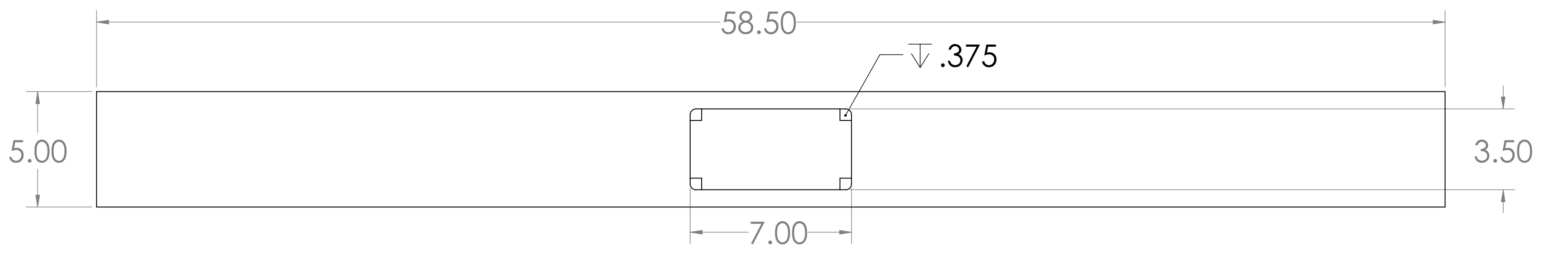

REAR UPPER WALL

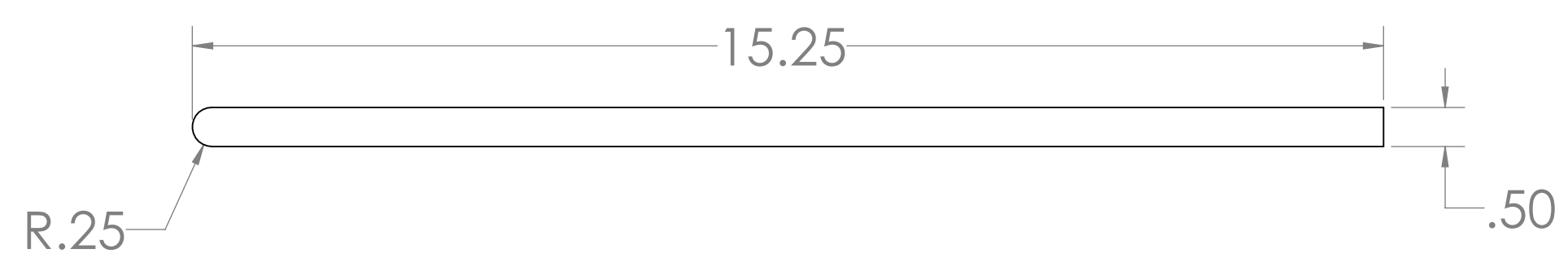

DRAWER SLIDES

BEARING WALL DETAIL VIEW

D
C
B
A

D
C
B
A

8 7 6 5 4 3 2 1

8 7 6 5 4 3 2 1

D

D

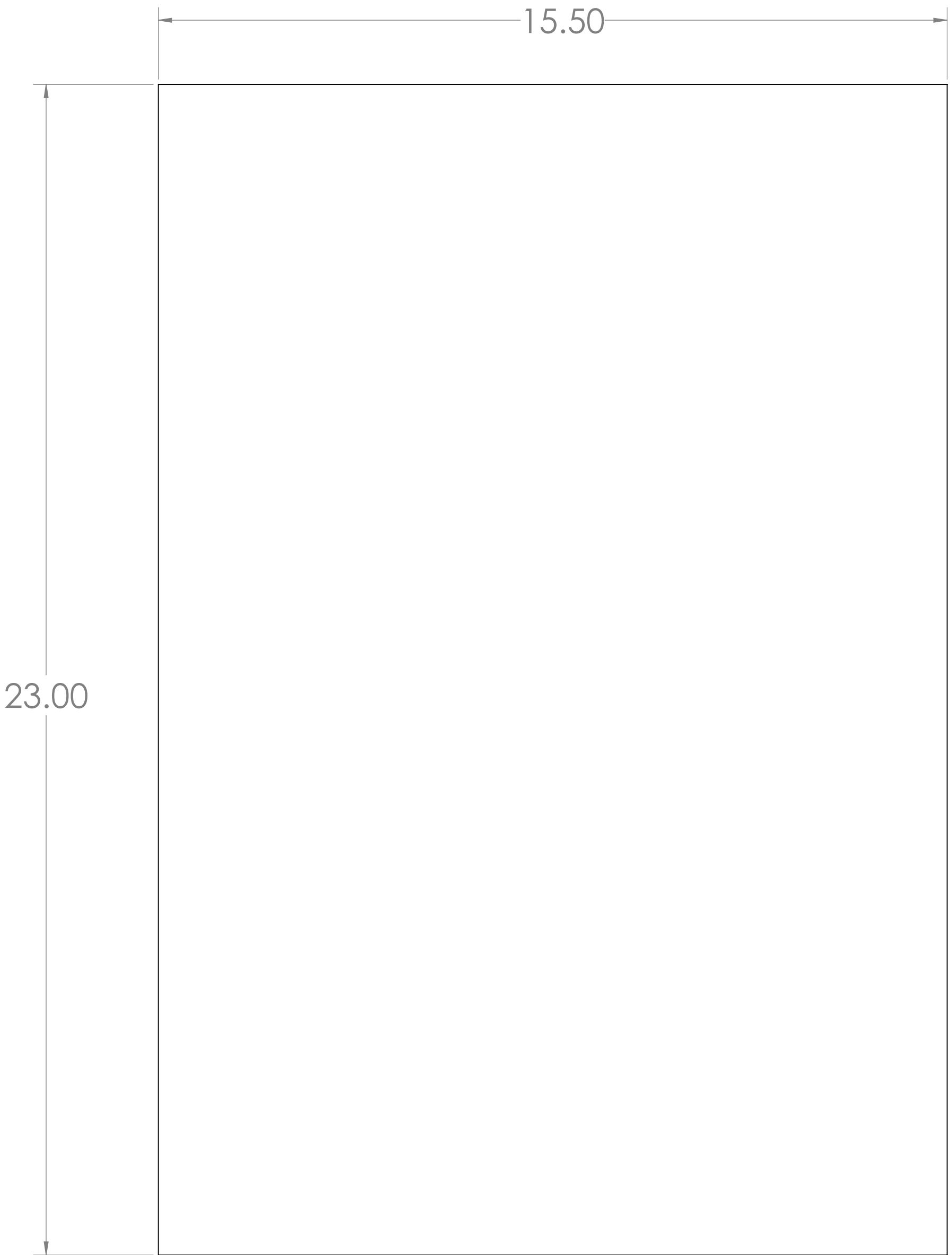

SHELF/BOTTOM

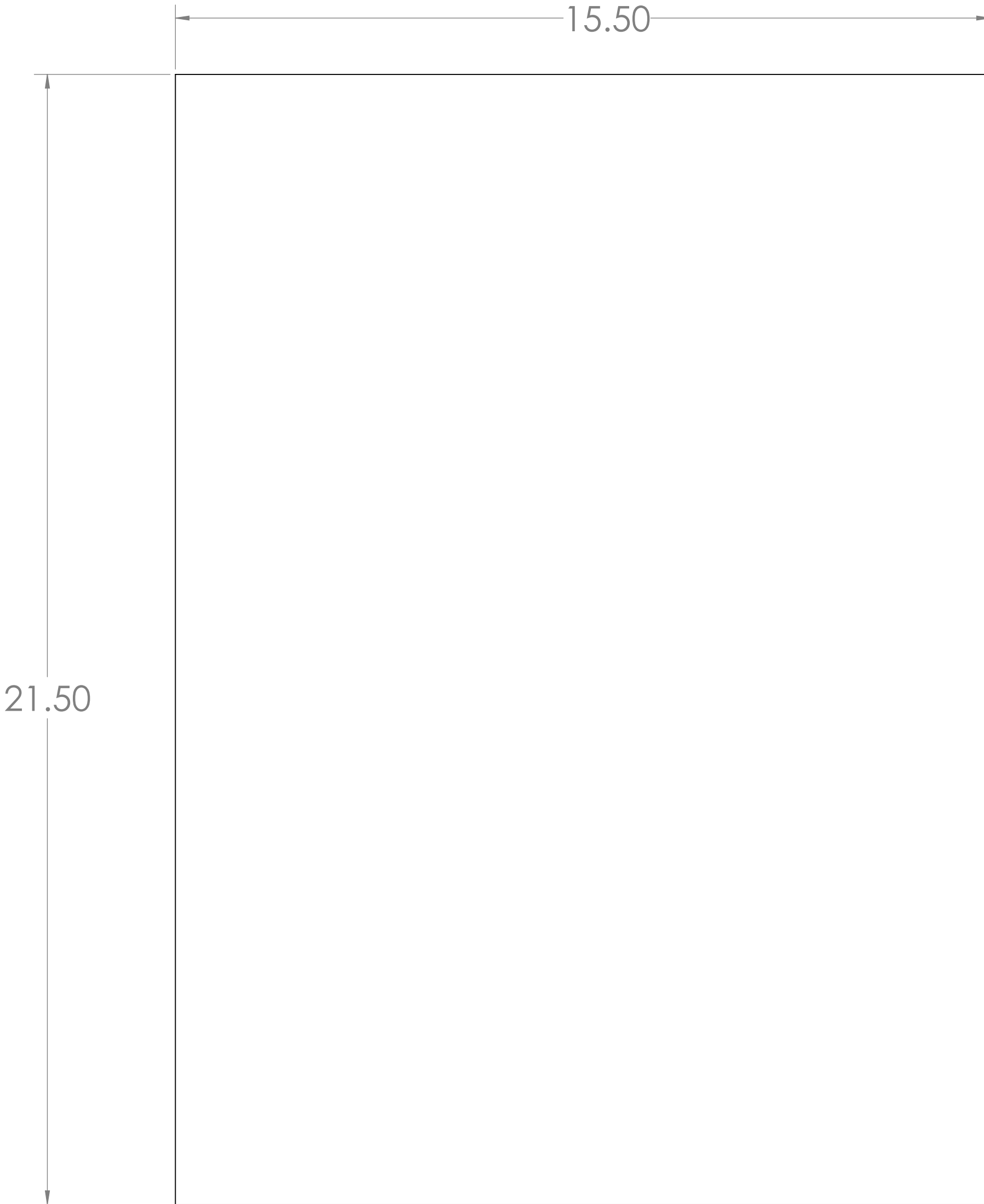

REAR WALL



DOOR

C

C

B

B

A

A

8 7 6 5 4 3 2 1

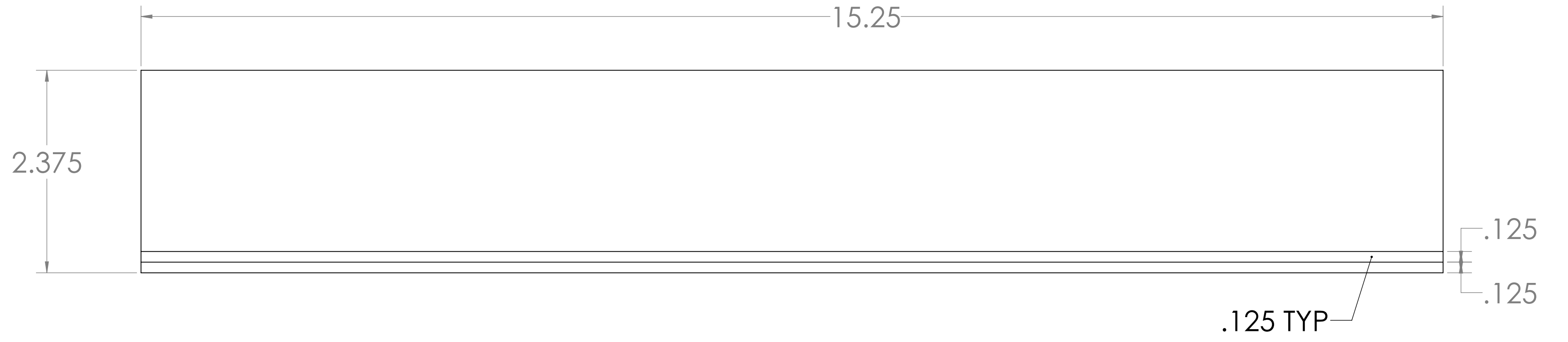
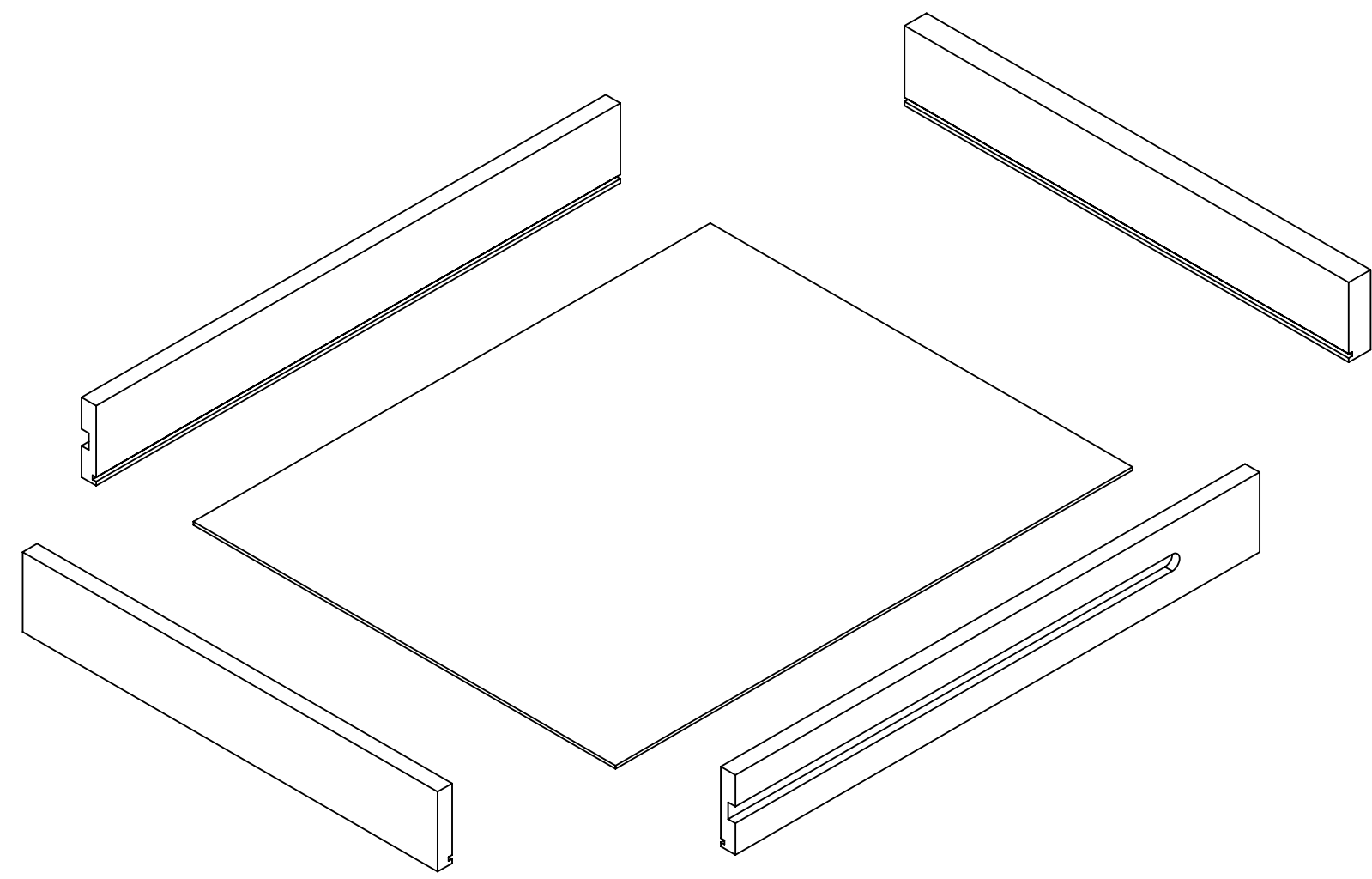

DRAWER FACE DETAIL VIEW

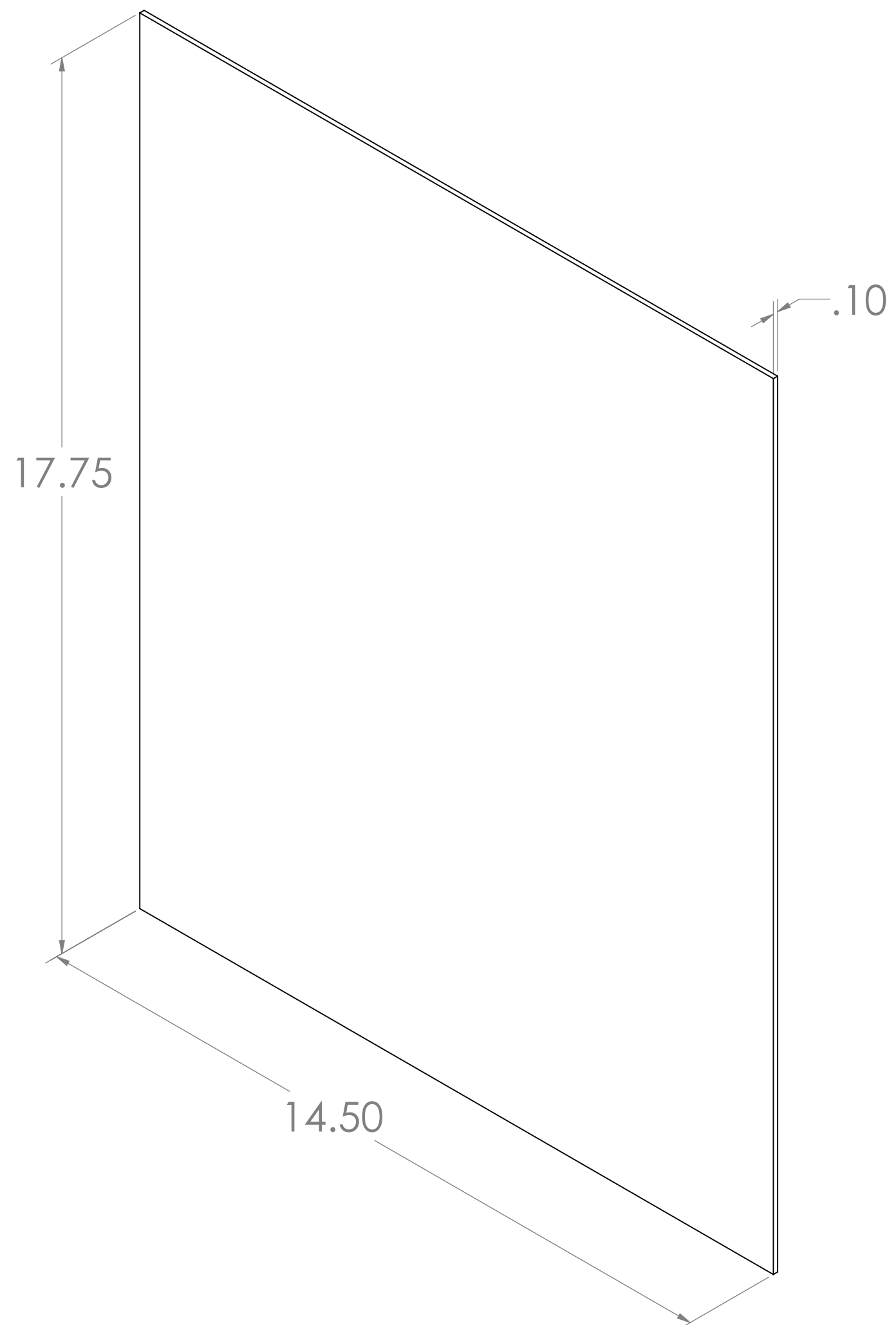

DRAWER BOTTOM



DRAWER SIDE - RIGHT
DRAWER SIDE - LEFT MIRRORRED

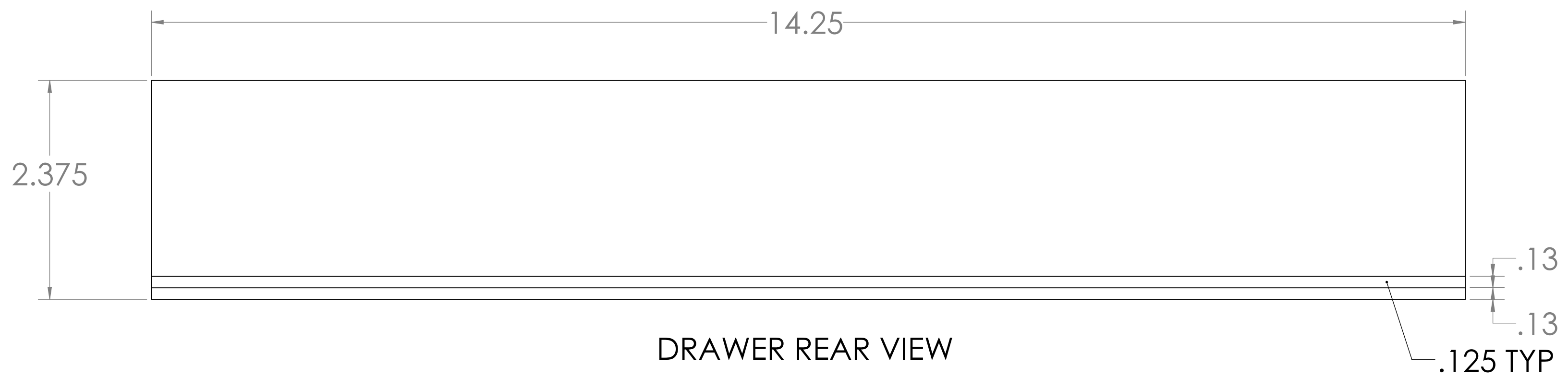

DRAWER REAR VIEW

SLIM DRAWER DETAIL VIEW
QTY 6 REQUIRED

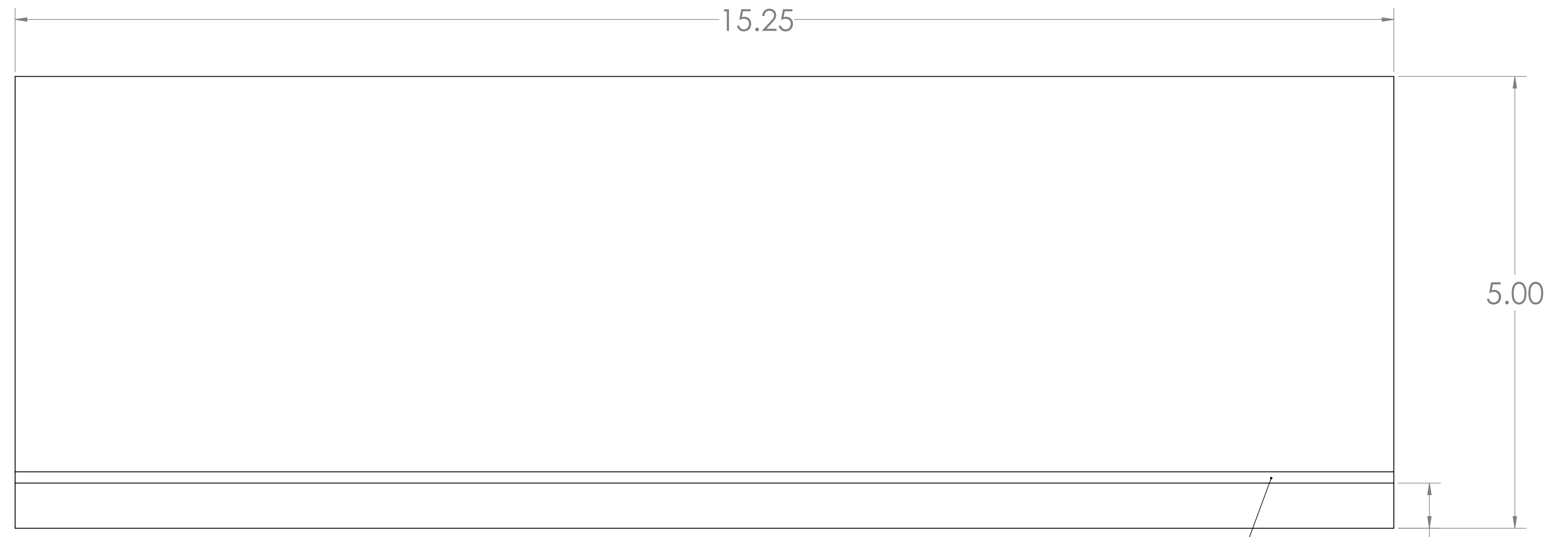
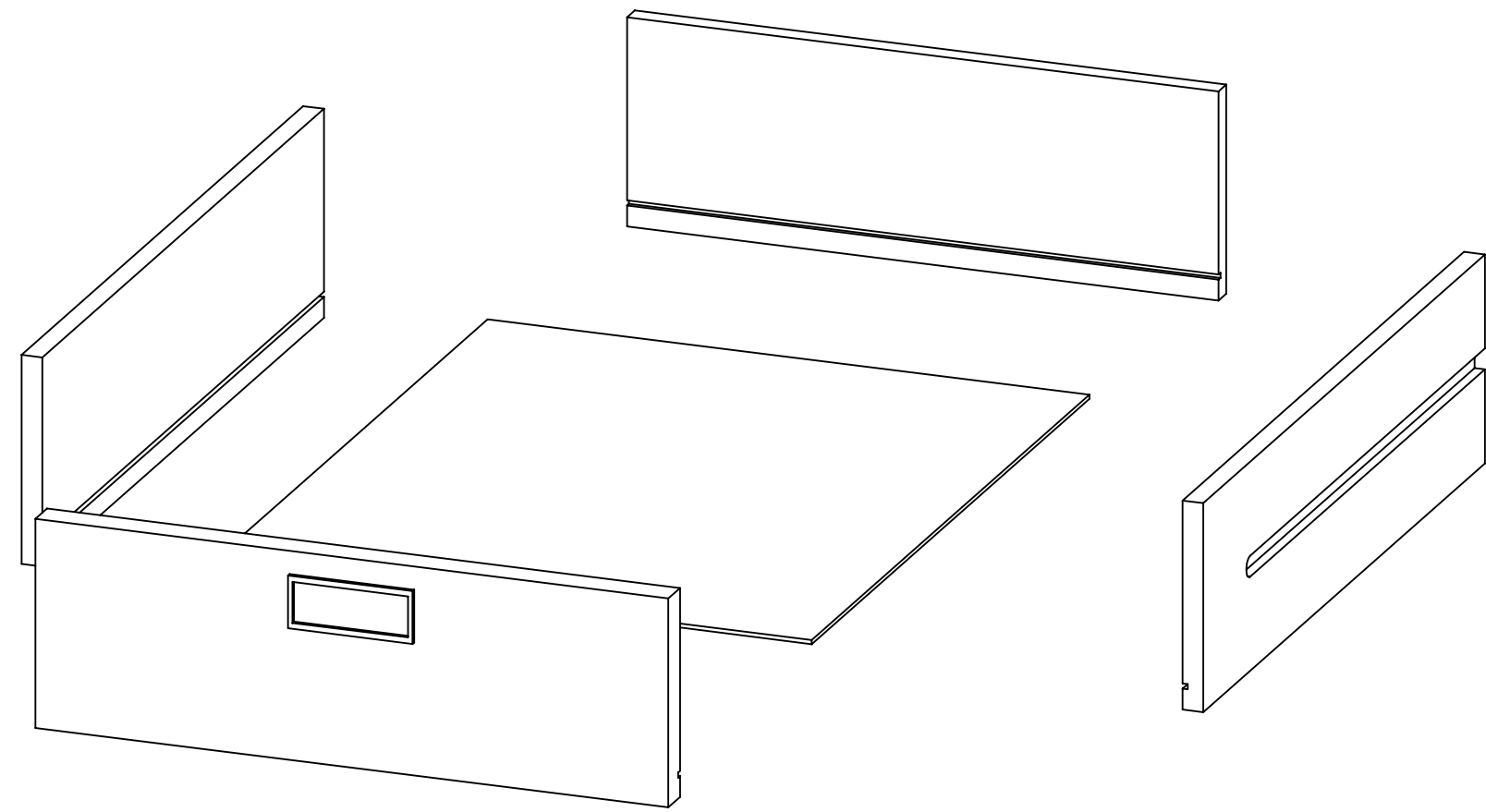

DRAWER FACE DETAIL VIEW

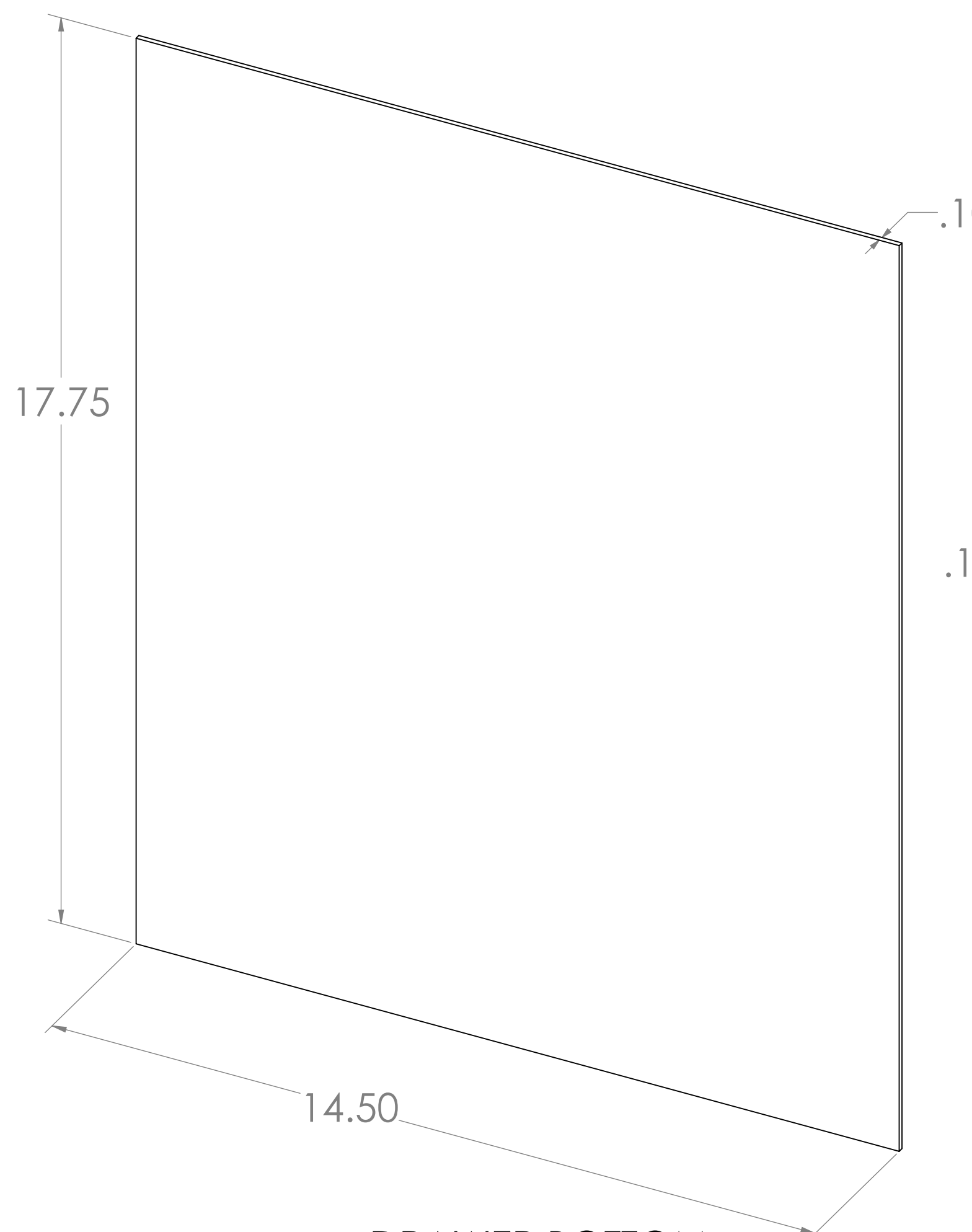

DRAWER BOTTOM



DRAWER SIDE - RIGHT DETAIL VIEW
DRAWER SIDE - LEFT MIRRORRED



LARGE DRAWER DETAIL VIEW

8

7

6

5

4

3

2

1

D

D

C

C

B

B

A

A

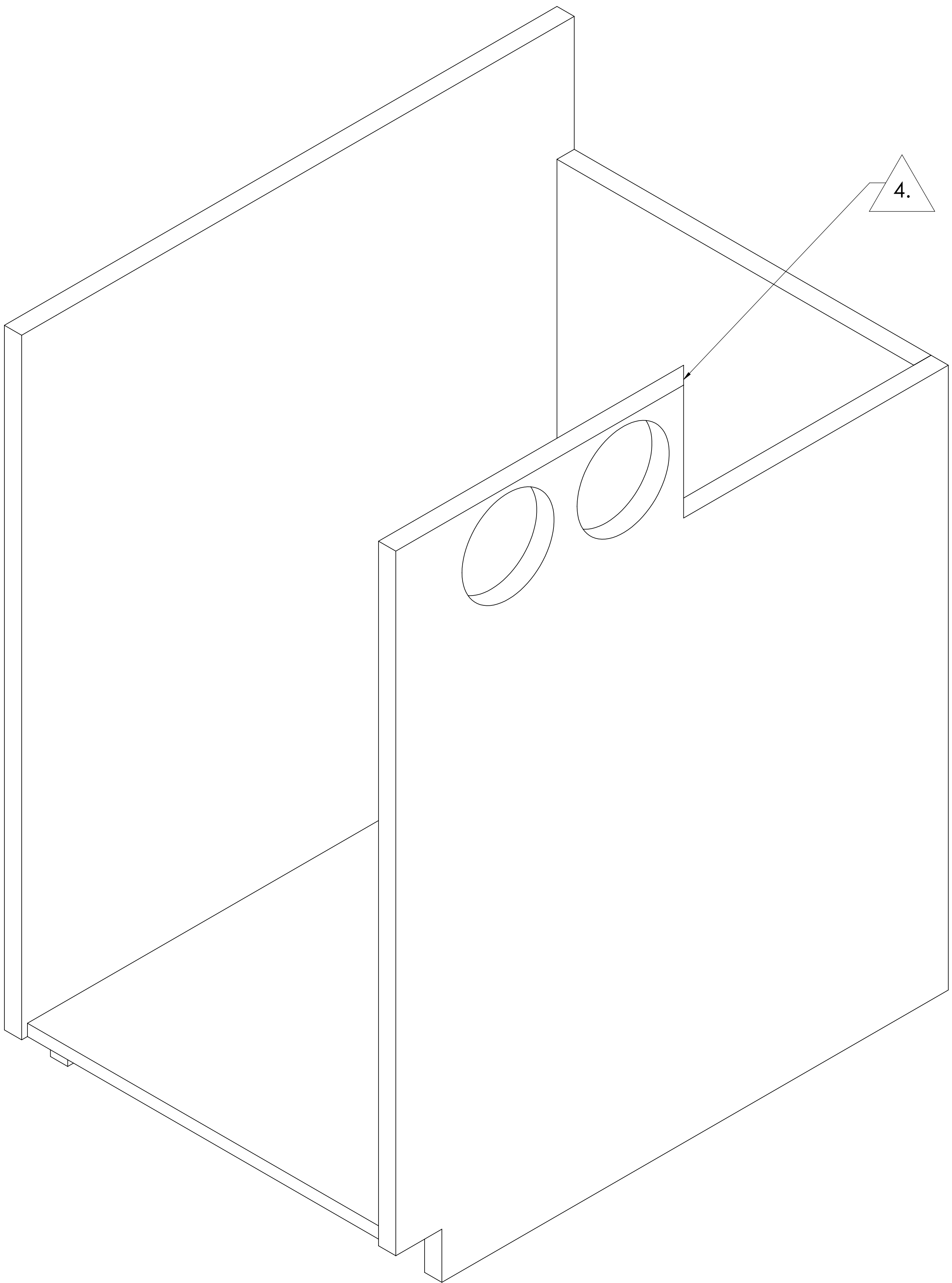

NOTES:

- 1. COMPONENTS:
 OUTER LEG, LEFT
 INNER LEG, LEFT
 REAR WALL
 SHELF/BOTTOM
- 2. ASSEMBLE USING POCKET SCREWS
- 3. FINISH PLYWOOD EDGES USING EDGE BANDING
- 4. PRIOR TO INSTALLATION, ENSURE PROPER ANGLE DIRECTION OF INNER LEG
- 5. IF ADDING A SHELF TO THIS CABINET, DRILL HOLES FOR SHELF HARDWARE AT THIS STAGE

LEFT CABINET ASSEMBLY

8

7

6

5

4

3

2

1

8

7

6

5

4

3

2

1

D

D

C

C

B

B

A

A

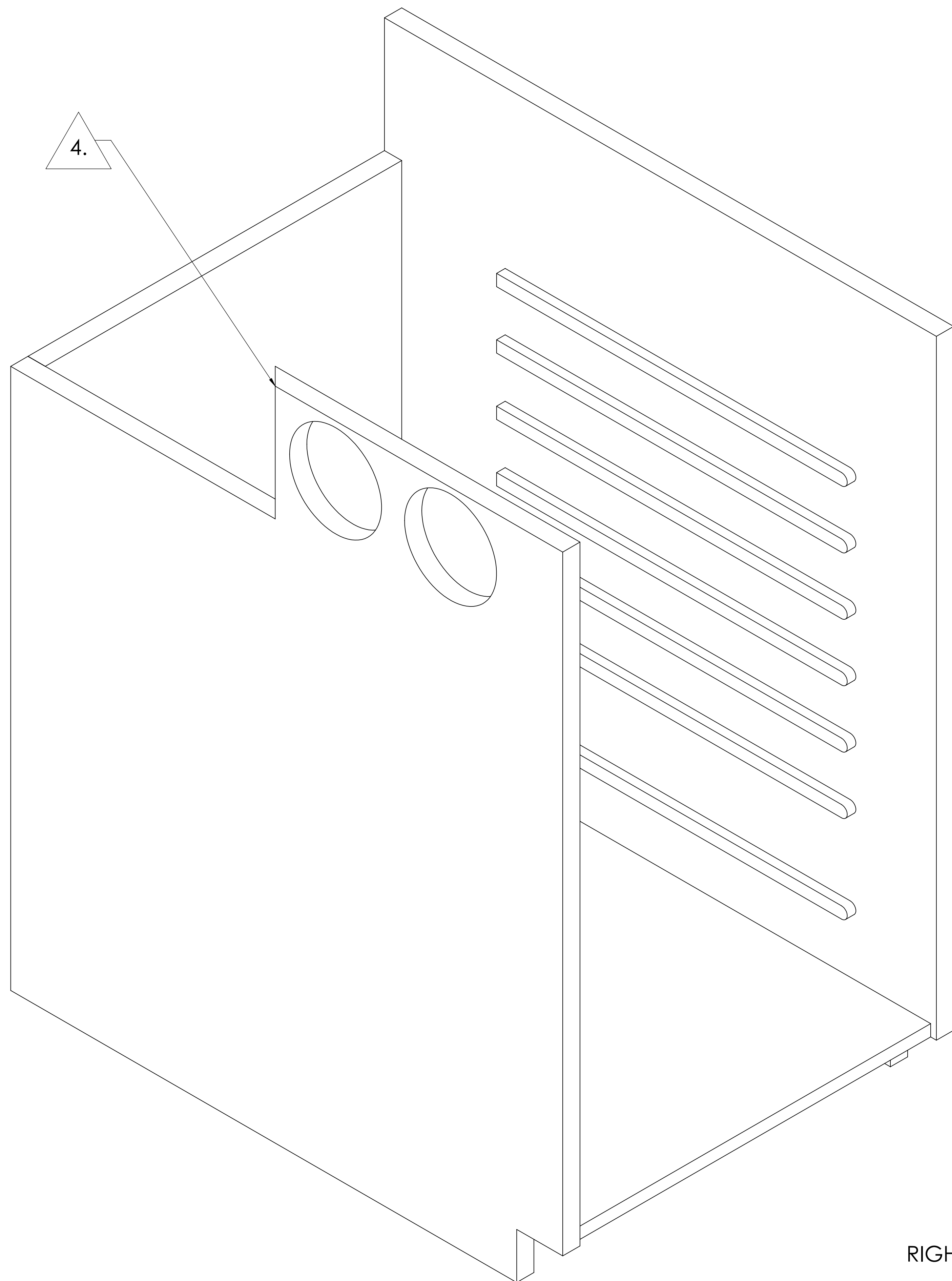

NOTES:

1. COMPONENTS:
 OUTER LEG, RIGHT
 INNER LEG, RIGHT
 REAR WALL
 SHELF/BOTTOM
 DRAWER SLIDES, QTY 14
2. ASSEMBLE USING POCKET SCREWS
3. FINISH PLYWOOD EDGES USING EDGE BANDING
4. PRIOR TO INSTALLATION, ENSURE PROPER ANGLE DIRECTION OF INNER LEG.
5. INSTALL DRAWER SLIDES USING COUNTERSUNK SCREWS, PREDRILL WITH A COUNTERSUNK BIT TO ENSURE WOOD DOESNT SPLIT.

RIGHT CABINET ASSEMBLY

8

7

6

5

4

3

2

1

8

7

6

5

4

3

2

1

NOTES:

1. COMPONENTS:

- LEFT CABINET ASSEMBLY
- RIGHT CABINET ASSEMBLY
- ELECTRONICS CABINET
- FRONT I/O WALL
- FRONT LEFT WALL
- CENTER WALL
- REAR UPPER WALL

2. ASSEMBLE USING POCKET SCREWS:

- ELECTRONICS CABINET TO LEFT/RIGHT CABINET ASSEMBLIES

3. ASSEMBLE USING GLUE:

- FRONT, FRONT I/O, CENTER, AND REAR UPPER WALLS TO CABINET ASSEMBLIES

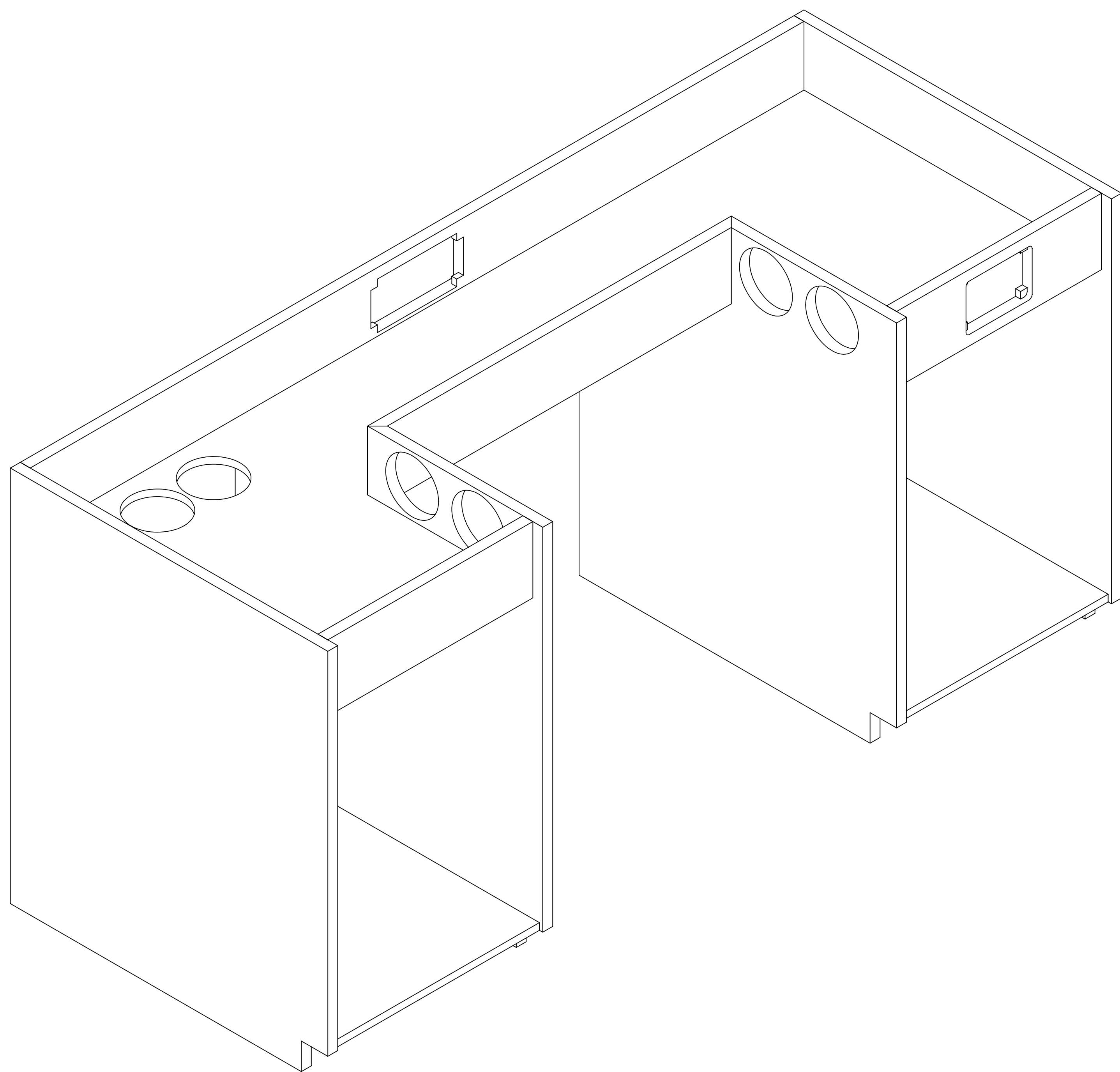

DESK ASSEMBLY

8

7

6

5

4

3

2

1

D

D

C

C

B

B

A

A

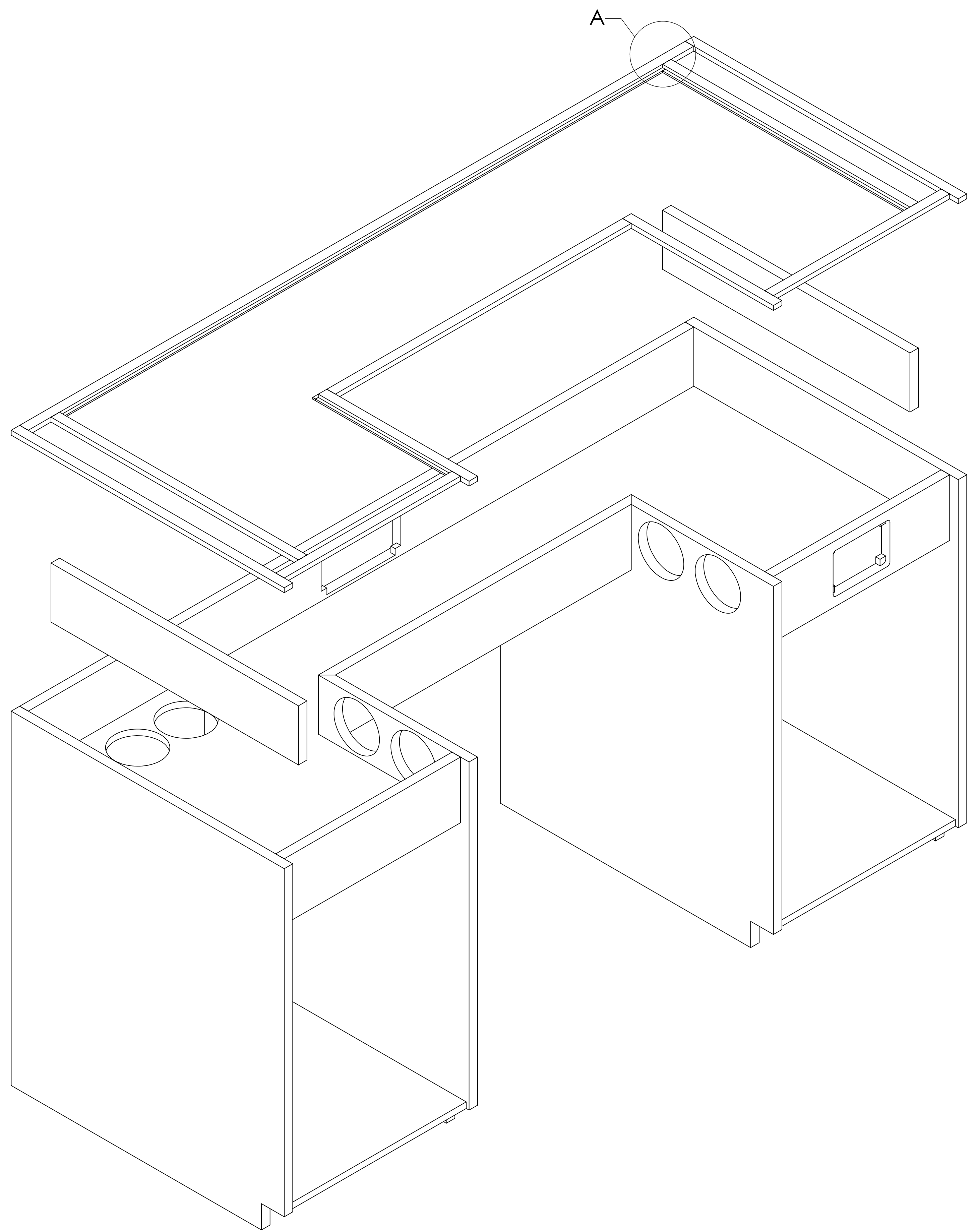

NOTES:

1. COMPONENTS:

- LEFT BEARING WALL
- RIGHT BEARING WALL
- HARDWOOD WALNUT TRIM

2. PRIOR TO INSTALLING BEARING WALLS, INSTALL LIFT MECHANISMS TO LEFT/RIGHT OUTER WALLS

3. ASSEMBLE USING GLUE. MAXIMIZE CABINET POSITIONING BY POSITIONING BEARING WALLS CLOSE TO LIFT MECHANISMS

4. CREATE WALNUT TRIM PIECES TO FIT EXPOSED PLYWOOD EDGES. ROUTE LIP ON INTERIOR SECTION TO HOLD PLEXIGLASS IN FINAL ASSEMBLY. DO NOT PUT LIP ON OUTER SECTIONS AS IT WILL INTERFERE WITH LIFT MECHANISMS. REFERENCE DETAIL A.

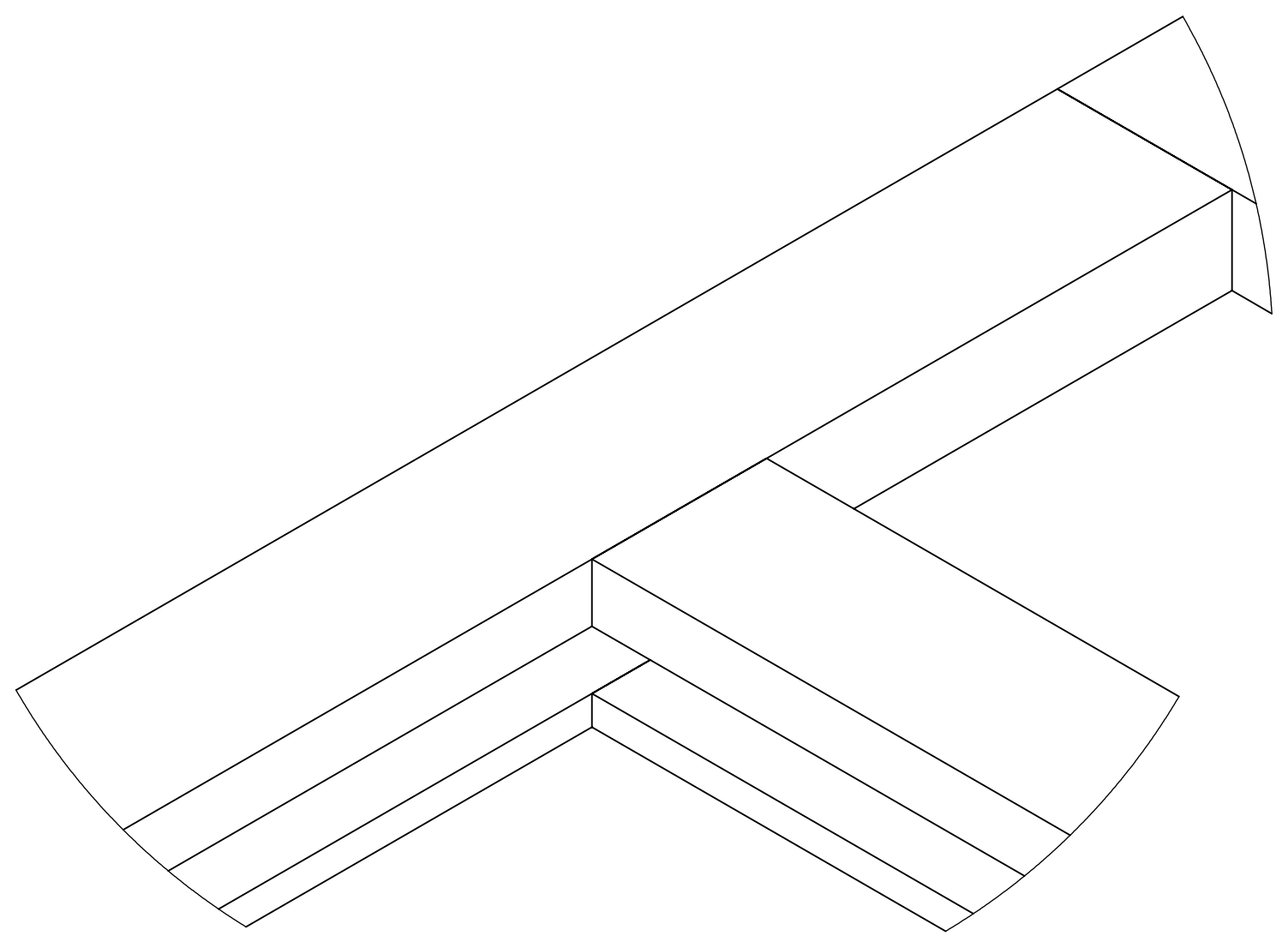

DETAIL A
SCALE 2 : 1

DESK ASSEMBLY



- NOTES:
1. COMPONENTS:
 DESK TOP
 HARDWOOD WALNUT TRIM
 2. ASSEMBLE USING GLUE AND DOWELS.
 3. CREATE WALNUT TRIM PIECES TO FIT EXPOSED PLYWOOD EDGES.

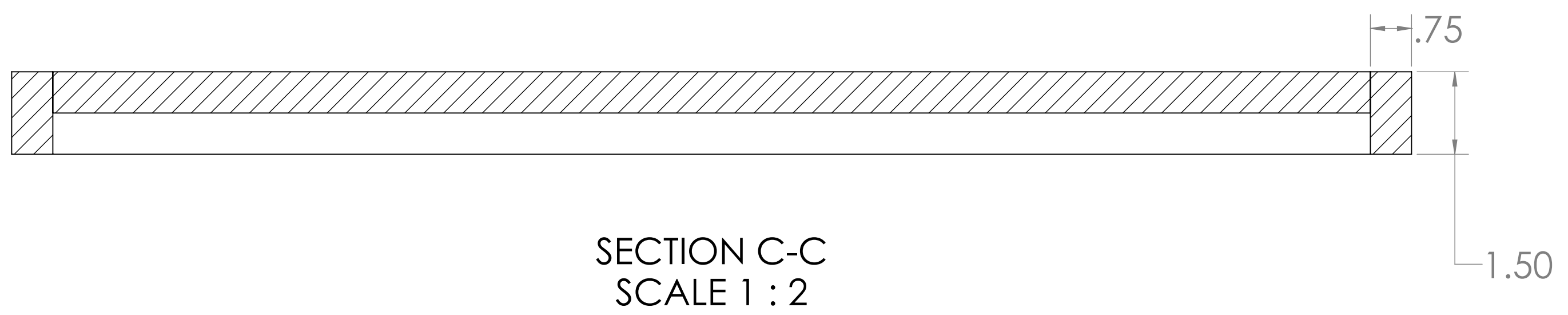

SECTION C-C
 SCALE 1 : 2

DESK TOP ASSEMBLY

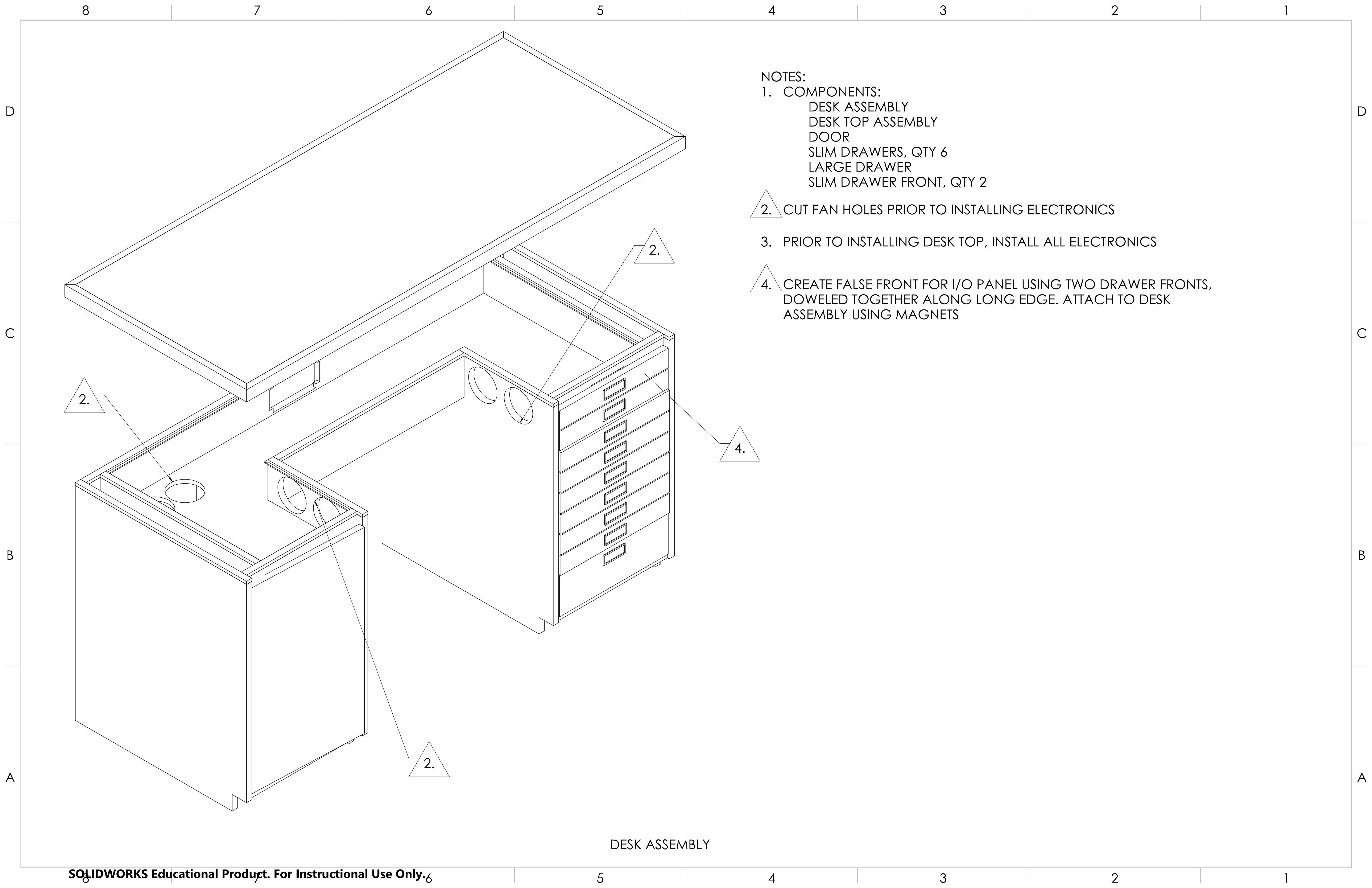

NOTES:

1. COMPONENTS:

- DESK ASSEMBLY
- DESK TOP ASSEMBLY
- DOOR
- SLIM DRAWERS, QTY 6
- LARGE DRAWER
- SLIM DRAWER FRONT, QTY 2

2. CUT FAN HOLES PRIOR TO INSTALLING ELECTRONICS

3. PRIOR TO INSTALLING DESK TOP, INSTALL ALL ELECTRONICS

4. CREATE FALSE FRONT FOR I/O PANEL USING TWO DRAWER FRONTS, DOWELED TOGETHER ALONG LONG EDGE. ATTACH TO DESK ASSEMBLY USING MAGNETS

DESK ASSEMBLY