



**Pine Plywood**

Sheet Size : 96" x 48" x 0.688"

**Cutting List**

Symbol	Length	Width	Qty
1	15.75"	22"	2
2	19.1875"	15.75"	2
3	20.1875"	22"	1
4	22"	17.5"	1
5	15"	15"	1
6	14"	5"	3
7	13"	14"	1
8	15"	6"	2
9	14.5"	5"	1

**Key**  
 = .5" Pocket Hole  
 = 1.5" Hole

**Job Layout**

Job Reference :

Client Name :  
 Date Required : 4/19/2017  
 Phone Number :  
 Fax Number :  
 Cell No :

Layout 1 of 1 (x1) - Pine Plywood (96" x 48")

Occurrences : 1  
 Sheet Panels : 14  
 Layout Wastage : 34.98%  
 Sheet Cut Length : 455.6535"

Total Sheets : 1  
 Job Panels : 14  
 Job Wastage : 34.98%  
 Job Cut Length : 455.6535"

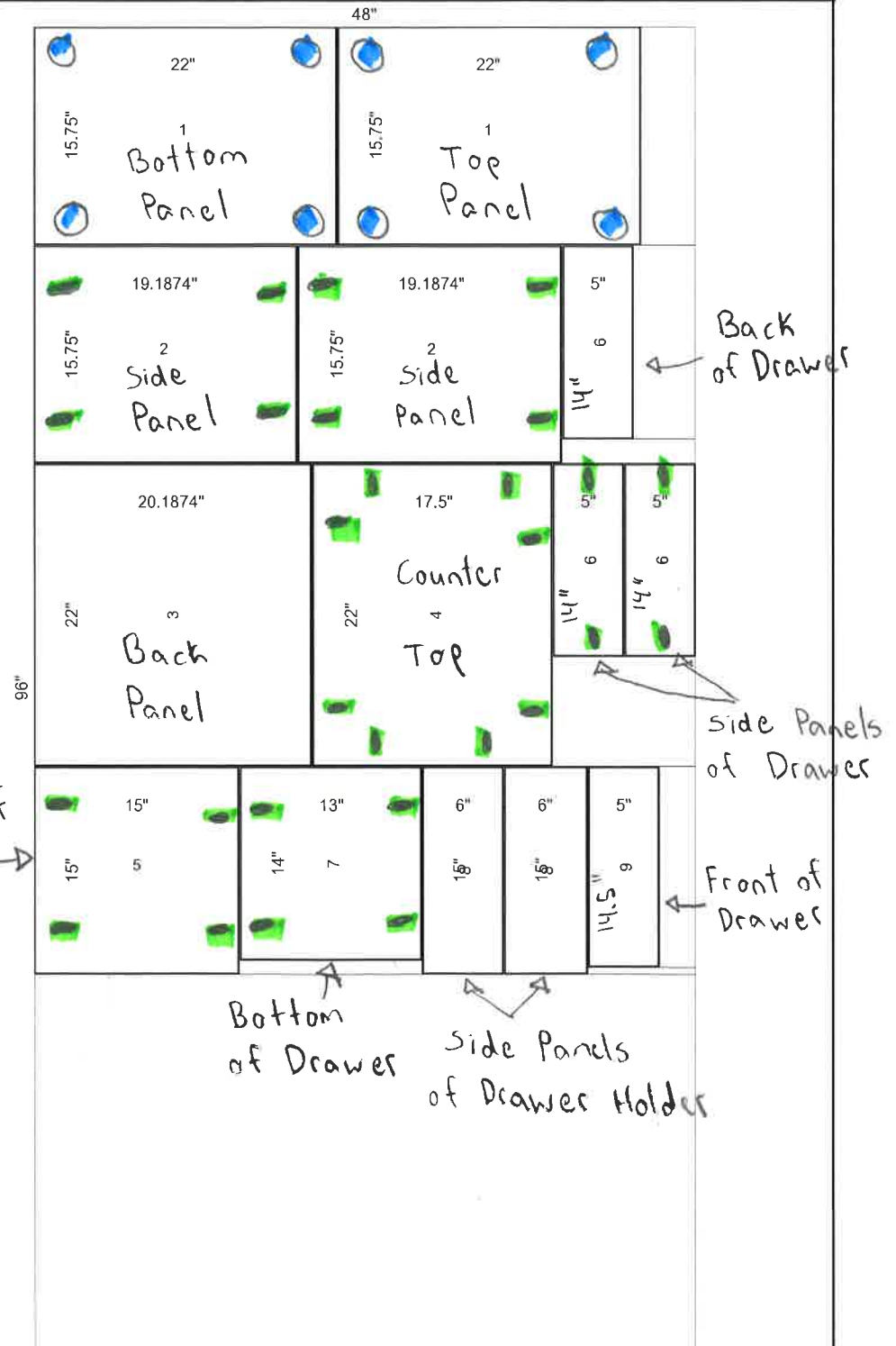

Occurrences

**x1**

Grain Direction

