

3 D P R I N T E D **FORKLIFT** **WIRELESS CHARGER**

A design model for the Bambu Lab Wireless Charger Kit-K012

Assembly Guide



1 | Install Circuit Board & LED Lights

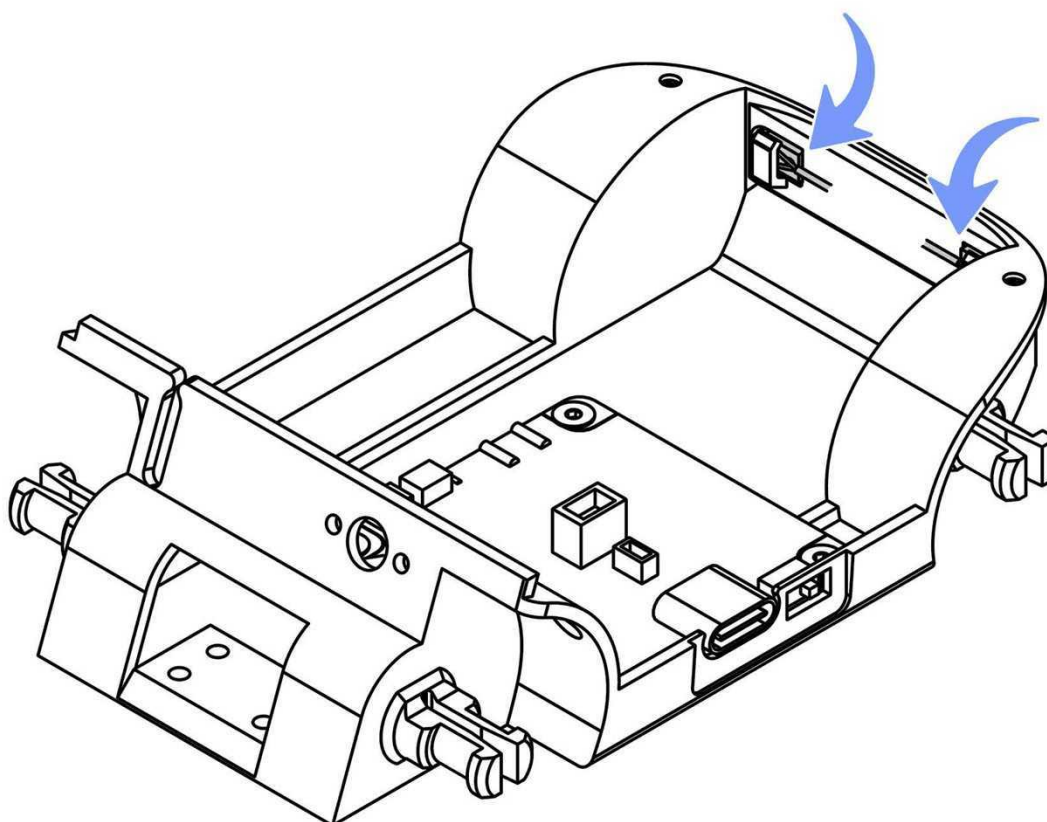
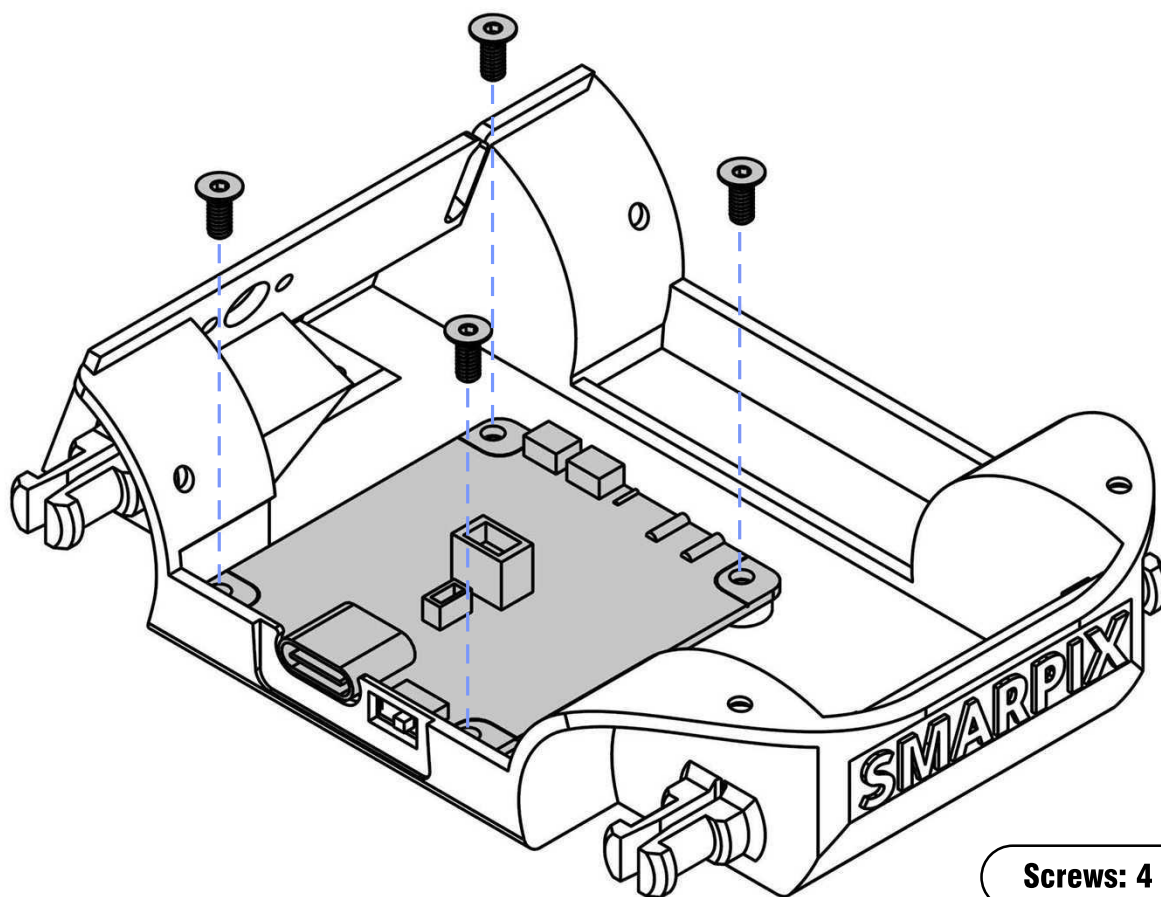

2 | Install Switch Board

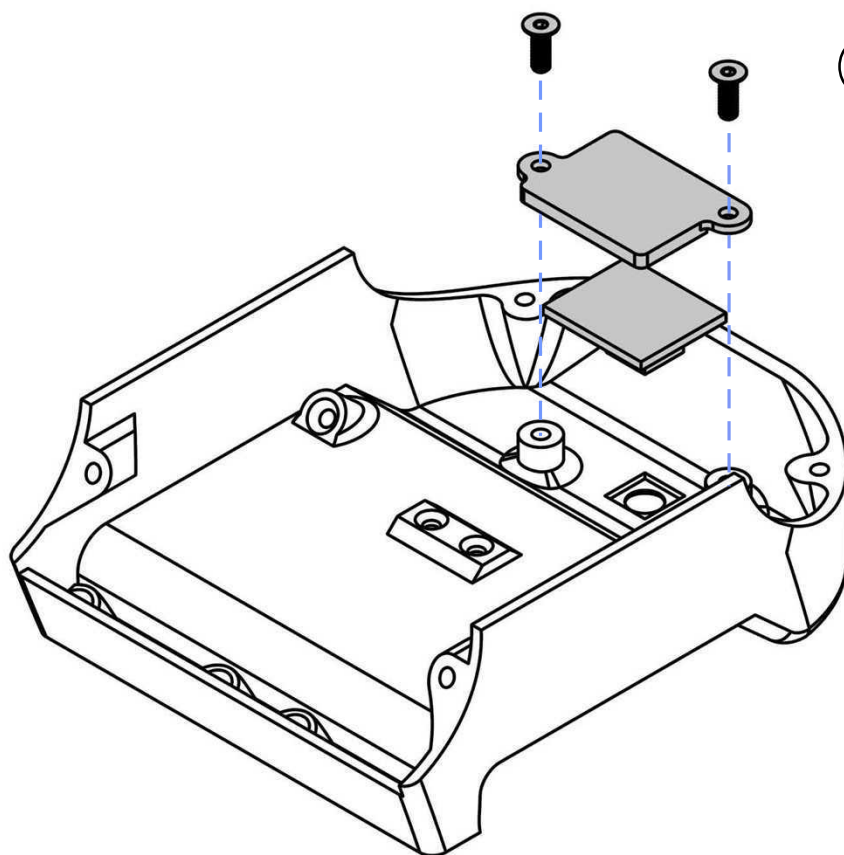

Screws: 2 x M2*6

3 | Install Seat

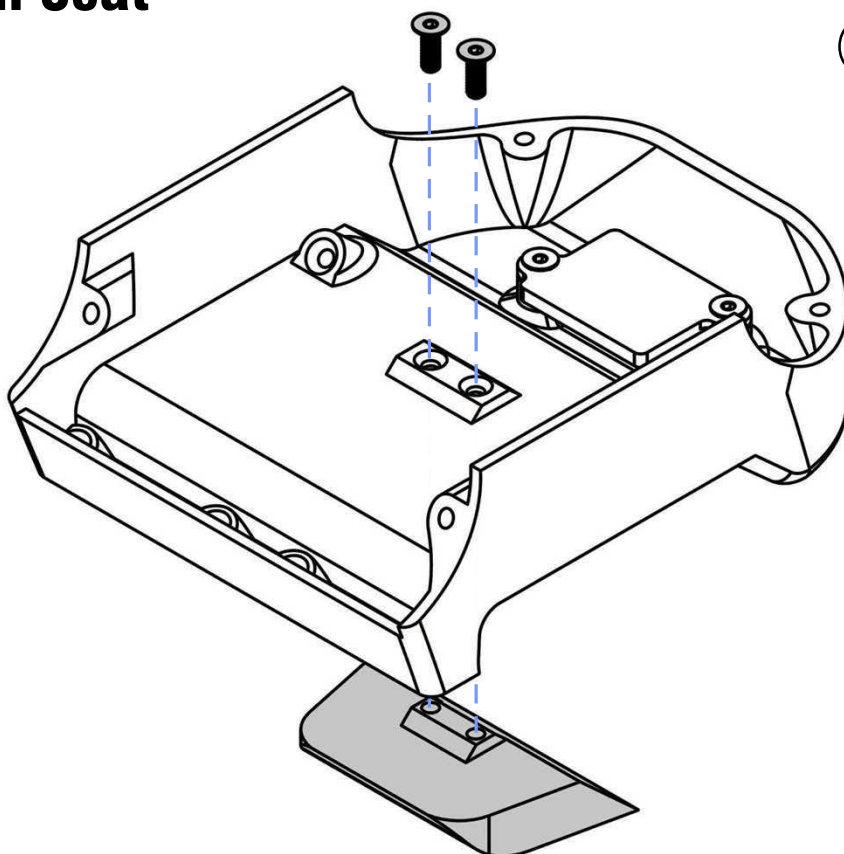

Screws: 2 x M2*6

4 | Install Driver Cab & Steering Wheel

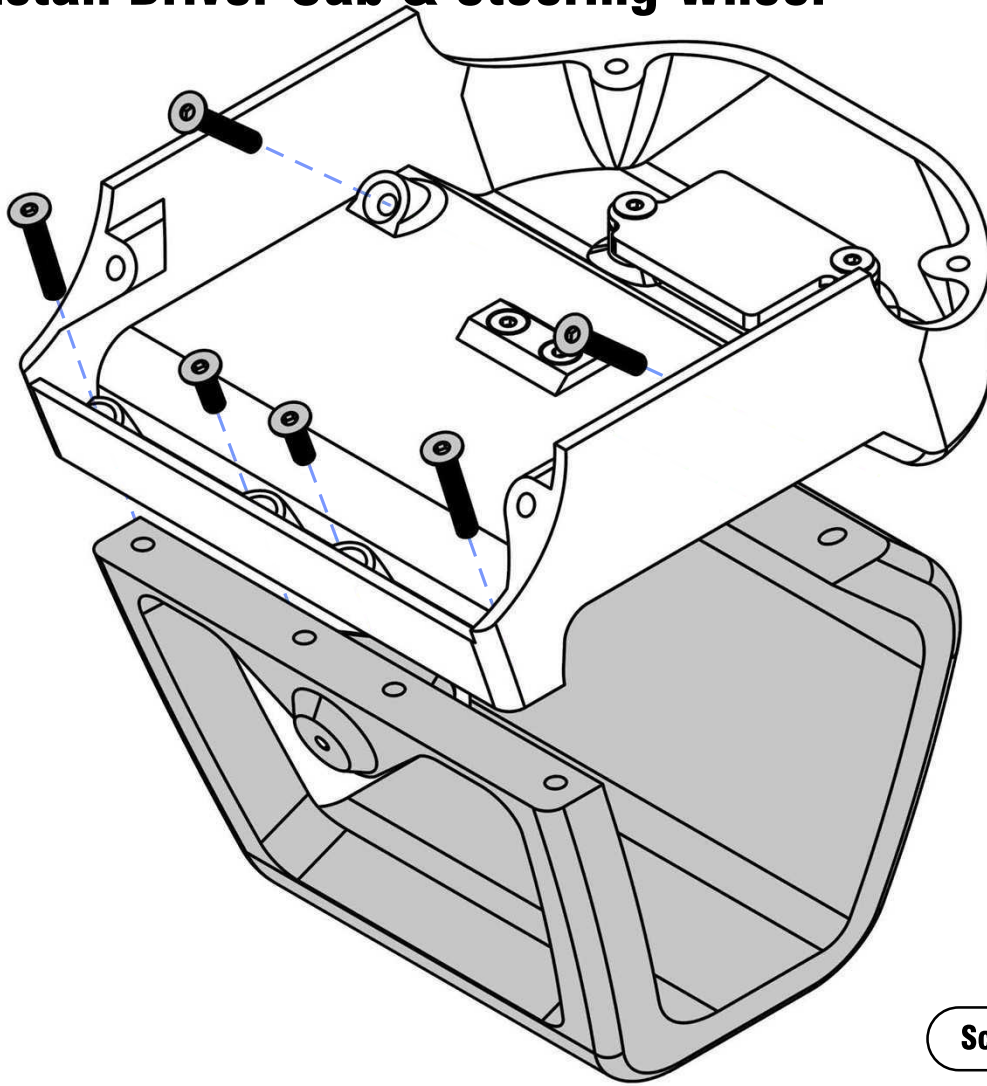

Screws: 4 x M2*12

+ 2 x M2*6

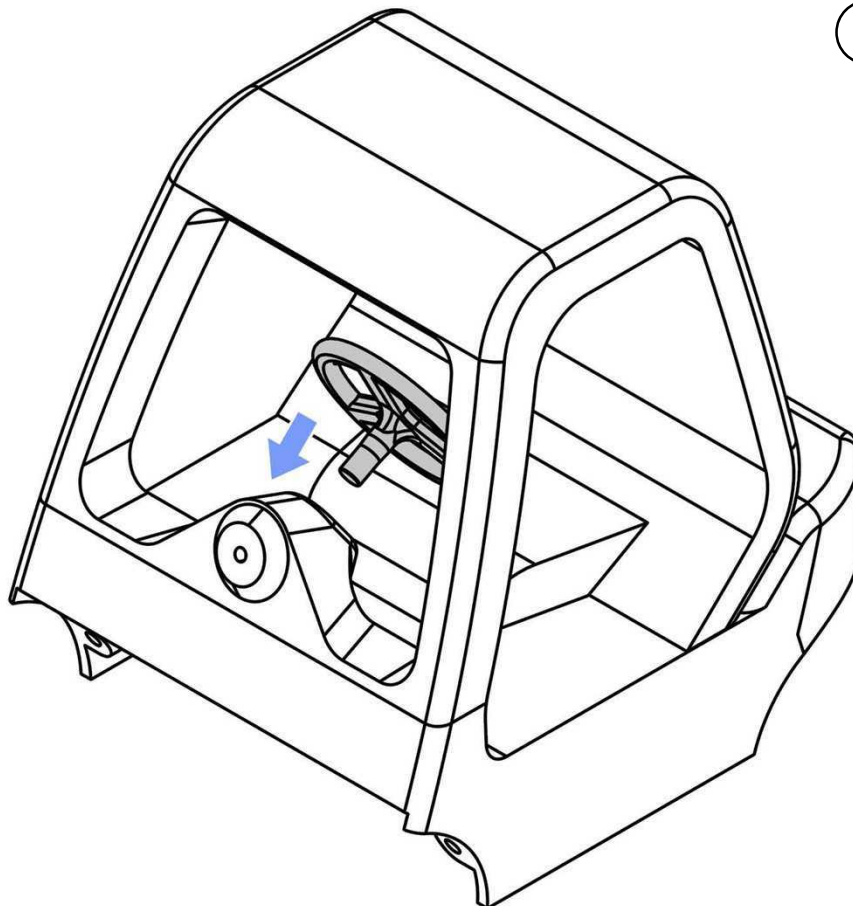

5 | Install Motor

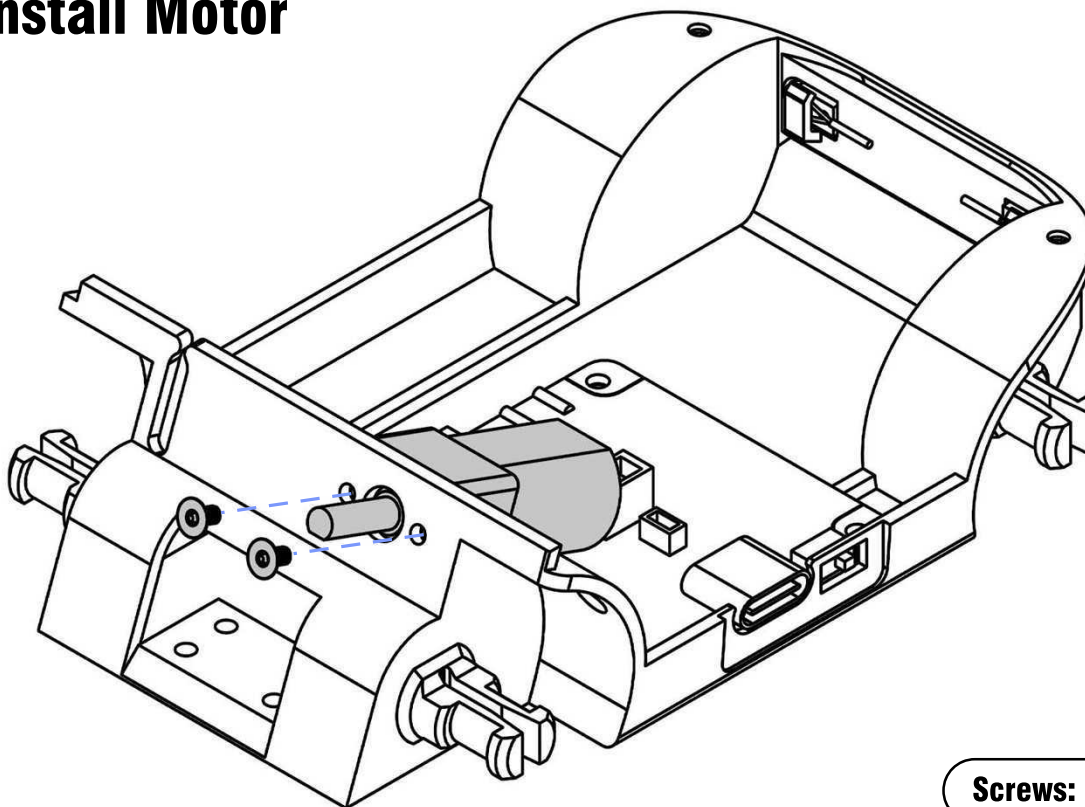

Screws: 2 x M1.6*3

6 | Join Body Parts

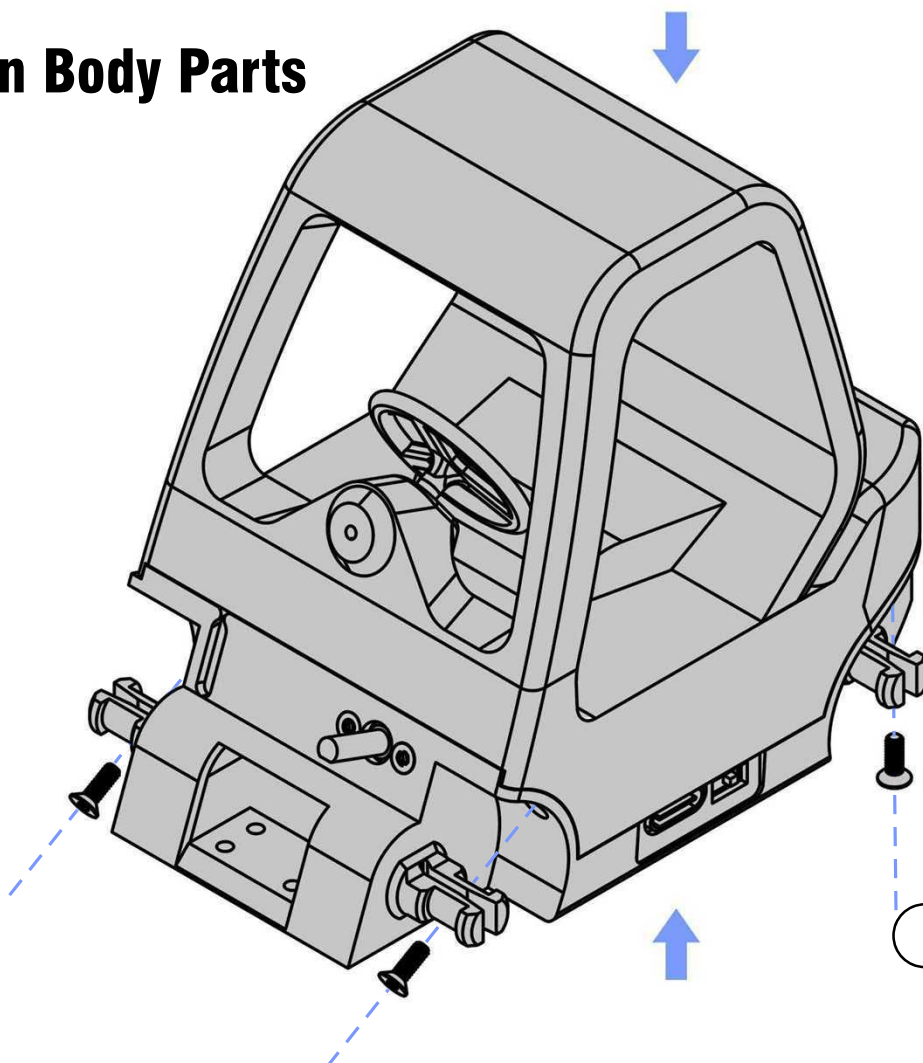

Screws: 4 x M2*6

7 | Install Gears

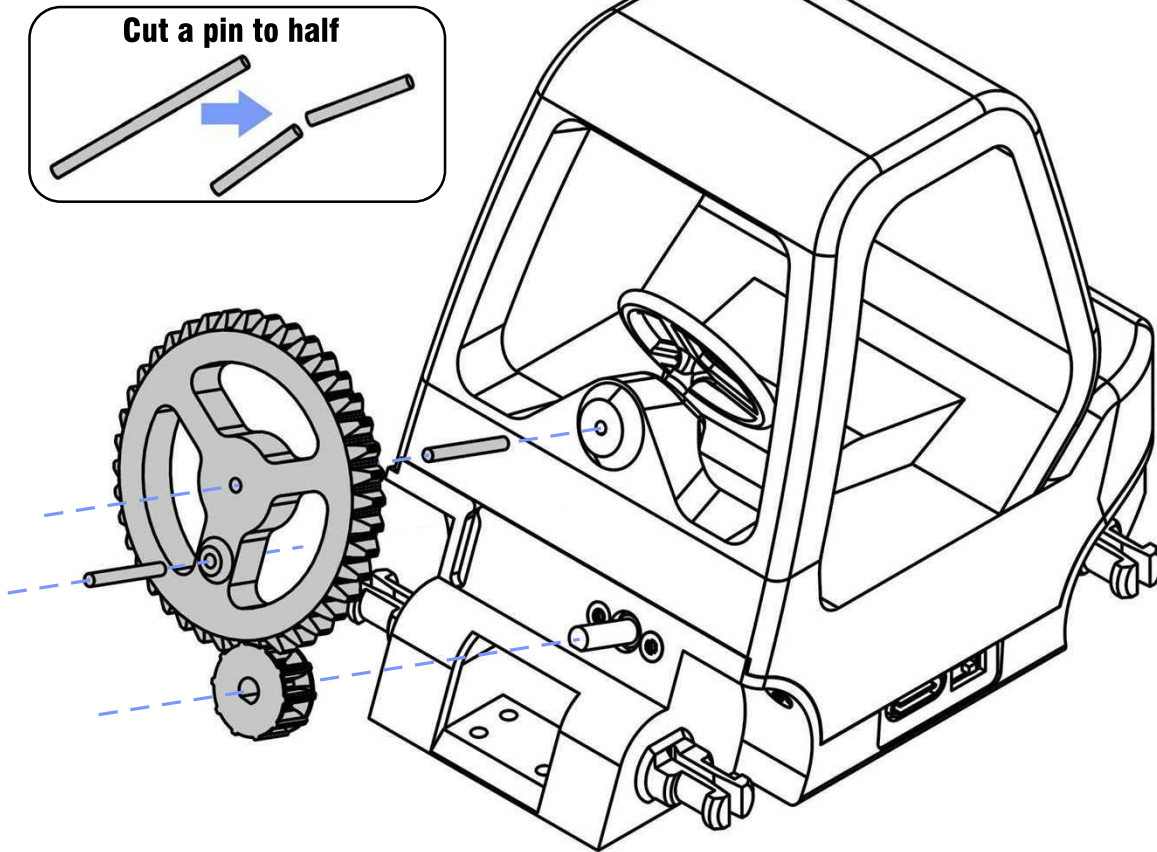

8 | Mount Mast Forks

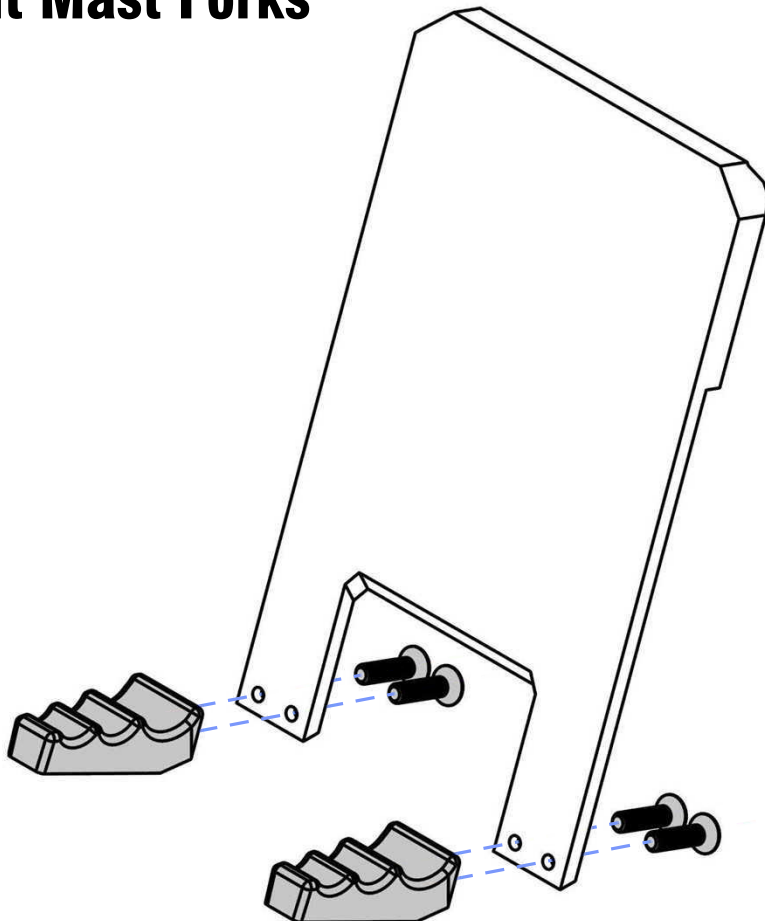

Screws: 4 x M2*12

9 | Insert Dowel Pins

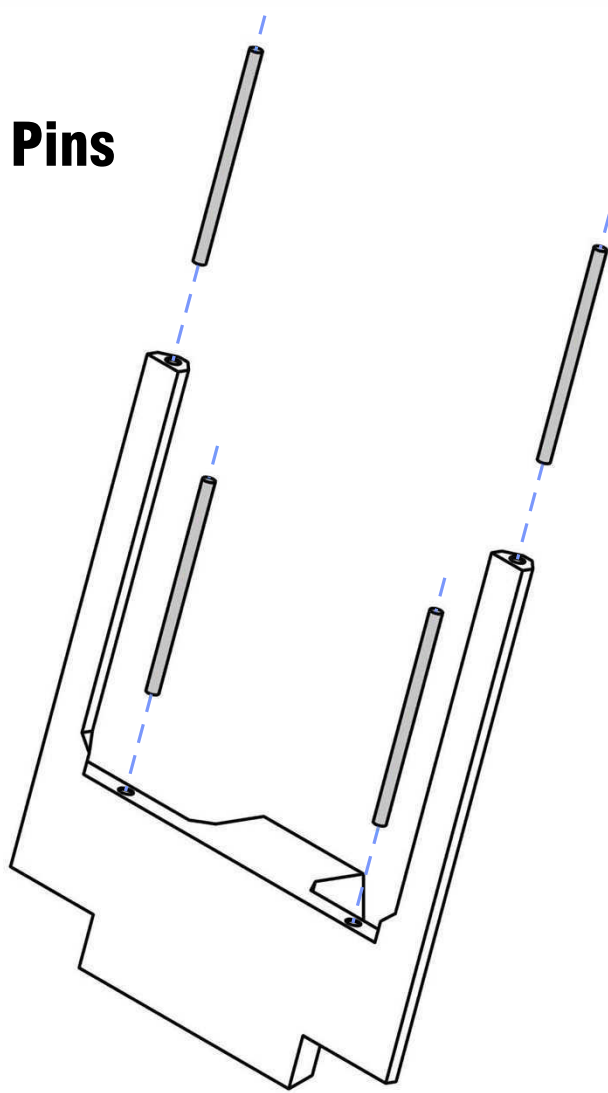

10 | Install Coil & Cover

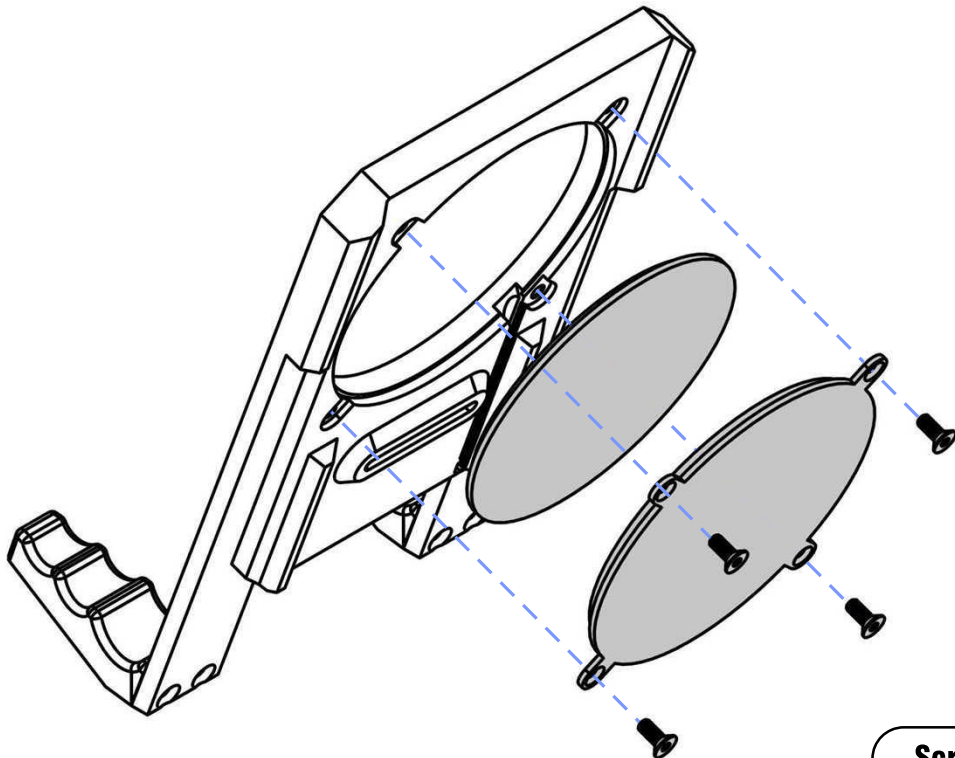

Screws: 4 x M2*5

11 | Connect Mast Parts

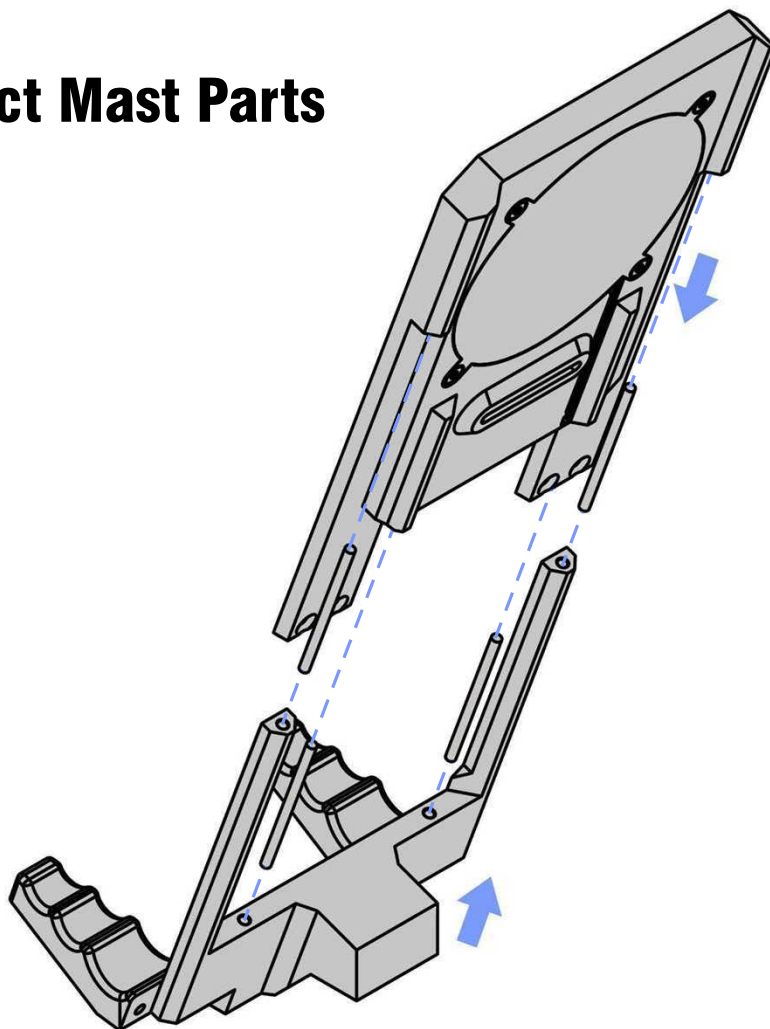

12 | Mount Mast To Body

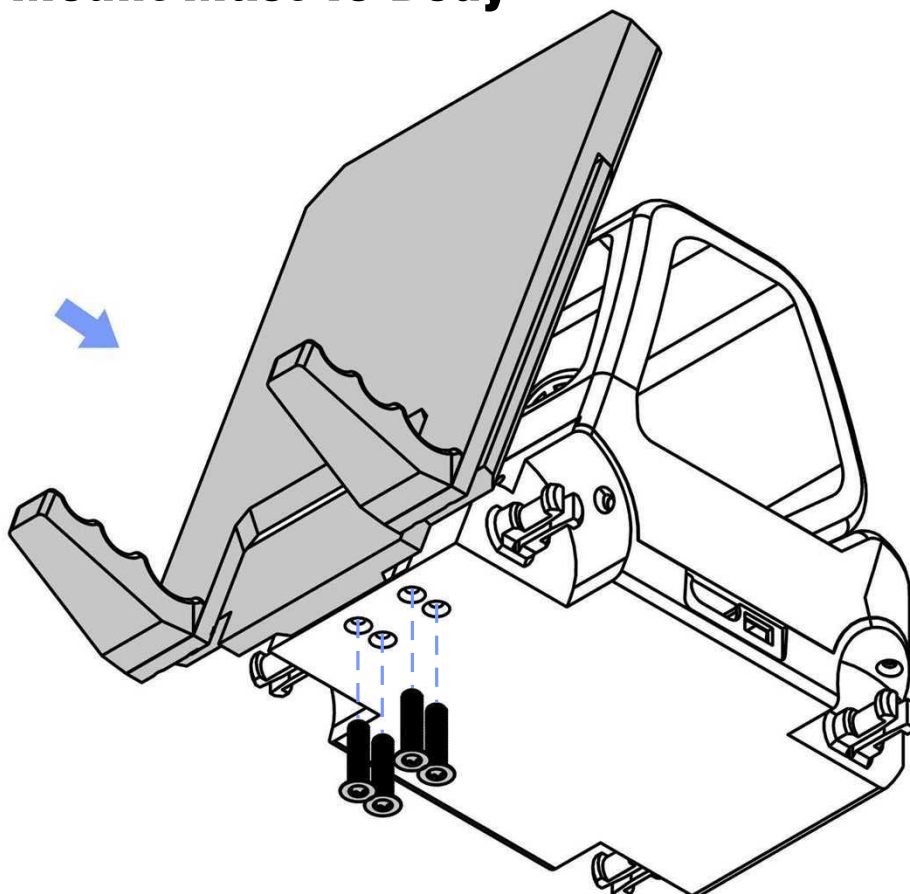

Screws: 4 x M2*12

13

Install Wheels

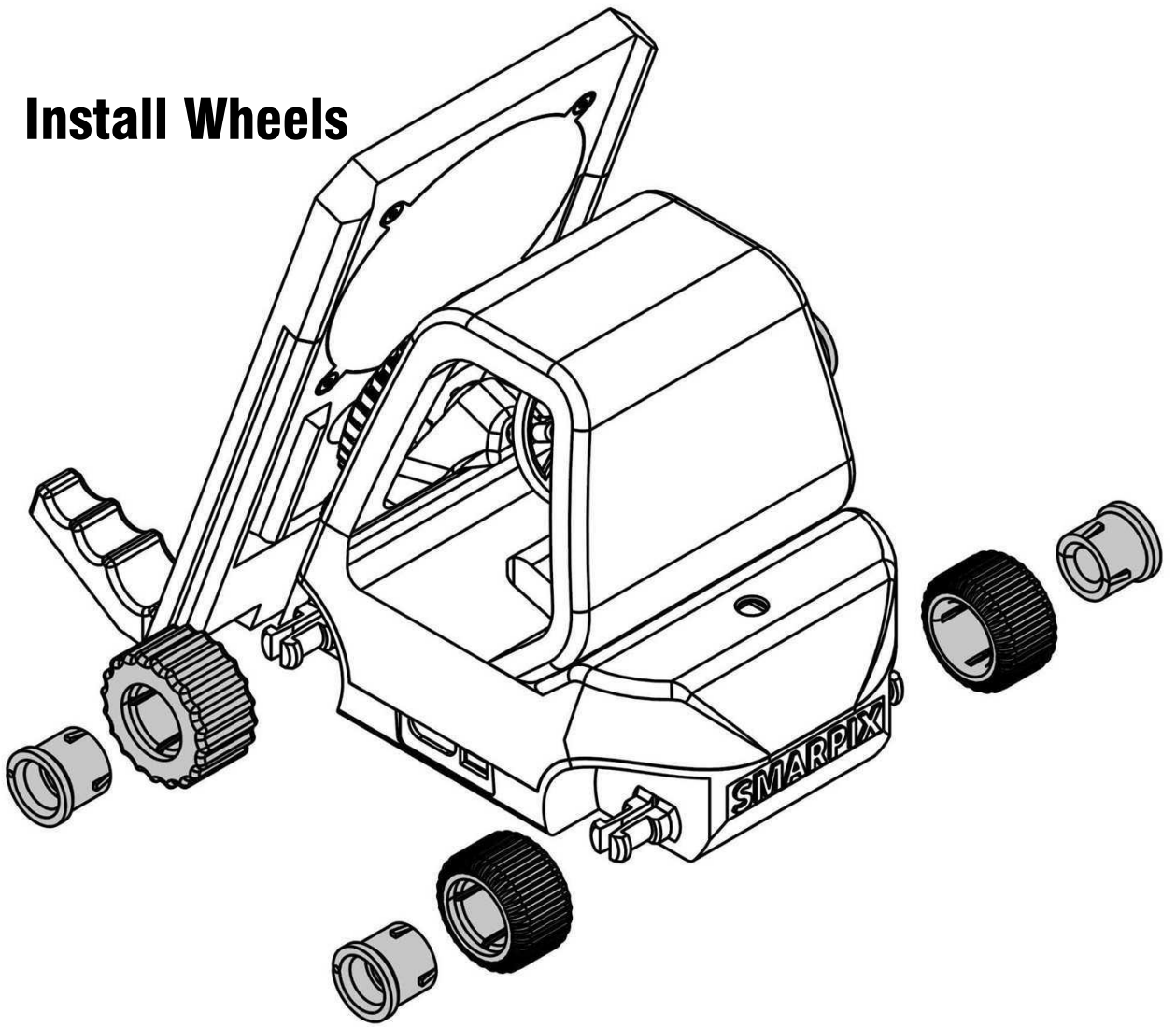

14

All Done

