

Structure: Arms

In the section, you will be building the 'Arms.' These components are what holds the guitar in place.

Bill of Materials:

Name	Number
M6 12mm BHSCS	20
M6 Split Washer	20
10 Series M6 Nut	20
L Brackets	14
4" 80/20® Bar	2
8" 80/20® Bar	4
36" 80/20® Bar	2

Tools
Hex Keys

Step 1:

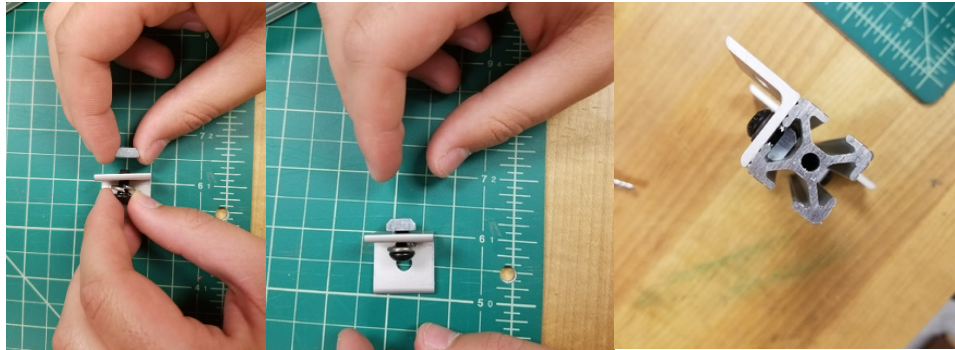

Needs:

- L Brackets
- 80/20® nuts
- 14x M6 12mm BHSCS
- 14x M6 Split Washer
- 14x 10 Series M6 Nut

Thread a bolt through a washer and then from the inside of an L bracket to the outside. Secure this by adding the M6 nut onto the end. Repeat this 13 times.

Step 2:

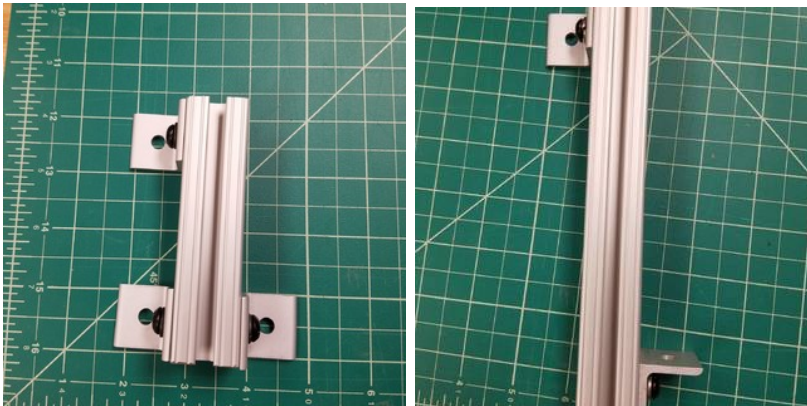

Needs:

- 2x 4" 80/20® Bars
- 4x 8" 80/20® Bars
- 14x L bracket assembly

Next add L brackets to the bars as shown in above.

Attach three L brackets to the 4" bar as above.
Do this for both of the 4" bars.

Attach two L brackets to the larger bar as above.
Do this for each of the 8" bars.

Once attached, your pieces should match the pieces in the image below:



Step 3:



Needs:

- 6x M6 12mm BHSCS
- 2x 36" 80/20® Bars
- 2x 4" Bars assembly
- 4x 8" Bars assembly

Now attach these six pieces to the two 36" bars as follows:

- Note the distance between bars is not critical, as you will adjust them later, **however**, the orientation/order of the bars should match the image to the right.